

The Pelco's VersaPole is a fully customizable track mounting system that allows accessories to be installed, adjusted, and removed easily. It provides a decorative solution for midblock area lighting and includes both internal and external wiring raceways. Various pole top and base options available.

VersaPole™ Assy, Alum w/ Track Mounting System & Base

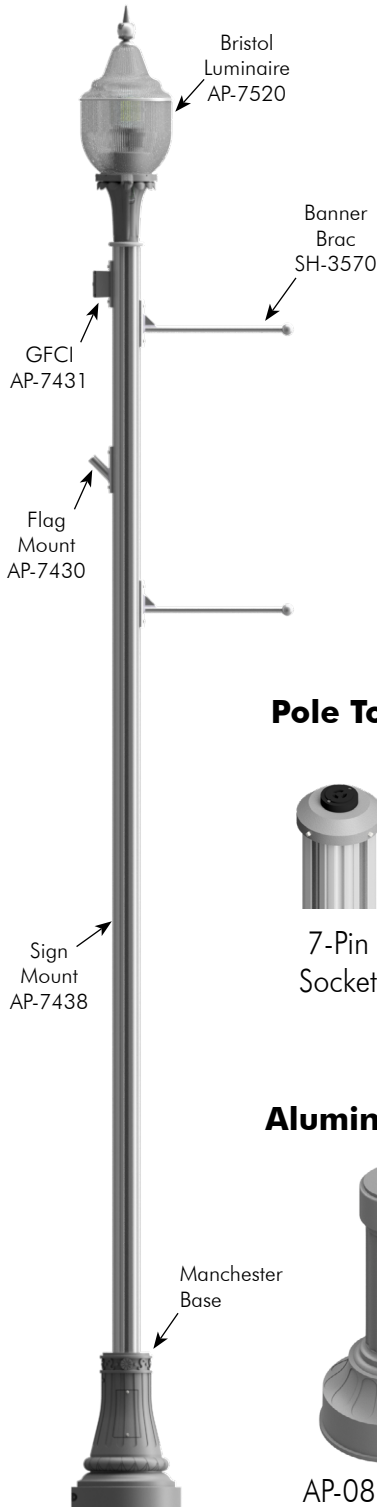

AP-8705 -	Height	-	Pole Top	-	Base	-	Coating
	12=12'-0"		Blank = Pole Cap Only		LB=LeGrande		P__=Paint
	14=14'-0"		7P = 7 Pin Socket		MB=Manchester		
	16=16'-0"		PC=7 Pin Photocell		HB=Hamilton		
	18=18'-0"		SC=Shorting Cap				
			PT2.88=2-7/8" Post Top				
			PT3.50=3-1/2" Post Top				

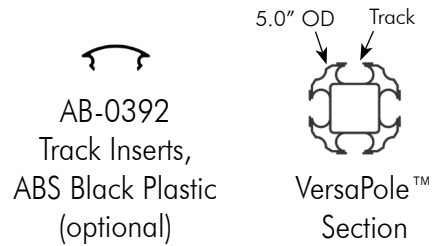

Pole Top Options

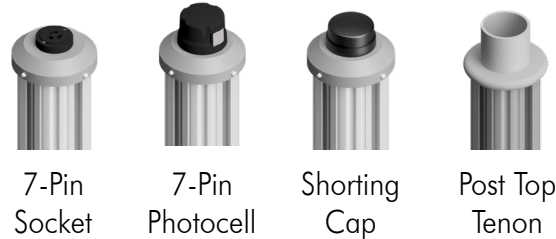

Aluminum Base Options:

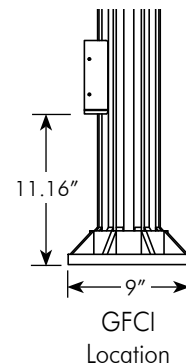
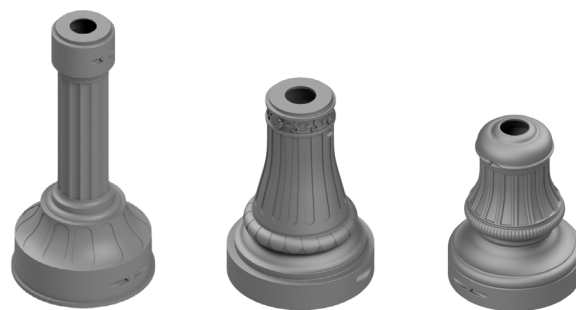

Example
w/ Accessories

AP-0814-5.08
LeGrande

AP-0819-5.08
Manchester

AP-0816-5.08
Hamilton

AP-8705-16-HB-P59

- Note: 1. See T15-2 through T15-4 for available track mounted accessories.
2. ABS Black Plastic Inserts may be purchased in various lengths to insert into open tracks.
3. See Reference Section page v for available paint colors.



The Pelco's VersaPole is a fully customizable track mounting system that allows accessories to be installed, adjusted, and removed easily. It provides a decorative solution for midblock area lighting and includes both internal and external wiring raceways. Various pole top and base options available.



Luminaire Arm, Arch Braced, Alum VersaPole™

AP-7434 - Coating
P__=Paint

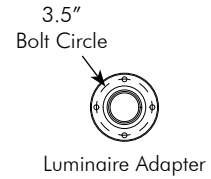

Luminaire Arm, Braced, Alum VersaPole™

AP-7432 - Coating
P__=Paint

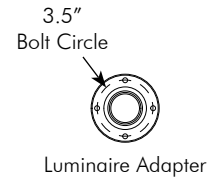

Luminaire Arm, Shepherds Hook, Alum VersaPole™

AP-7437 - Coating
P__=Paint

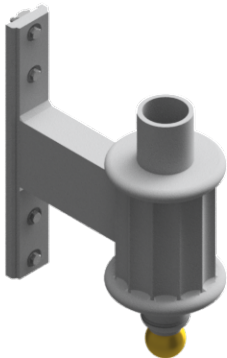
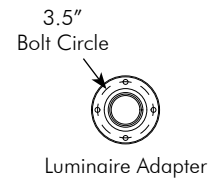

Luminaire Arm, 2-7/8" OD Tenon, Alum VersaPole™

AP-7436 - Finial/Color - Coating
P__=Paint

BL__=2" Ball
ST__=Steeple
SI__=Spire
FL__=Fleur
SE__=1-1/2" Spear



Note:
Shown with ball finial. Finial may be ordered as P28 Gold or same color as assembly.

Note: 1. See T15-1 for VersaPole track mounting system.
2. See Reference Section page v for available paint colors.



VersaPole™

The Pelco's VersaPole is a fully customizable track mounting system that allows accessories to be installed, adjusted, and removed easily. It provides a decorative solution for midblock area lighting and includes both internal and external wiring raceways. Various pole top and base options available.

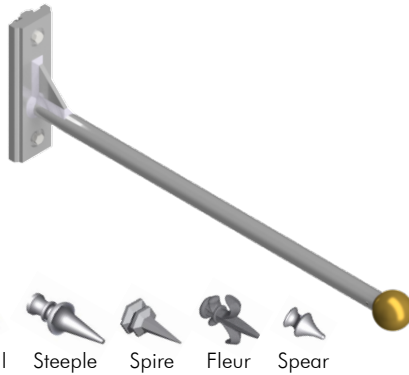

Banner Bracket, Alum VersaPole™

SH-3570 - - -

18=18" BL__=2" Ball P__=Paint
 24=24" ST__=Steeple
 SI__=Spire
 FL__=Fleur
 SE__=1-1/2" Spear

Note:
 2 assemblies required for mounting banner.
 Shown with ball finial. Finial may be ordered as P28 Gold or same color as assembly.

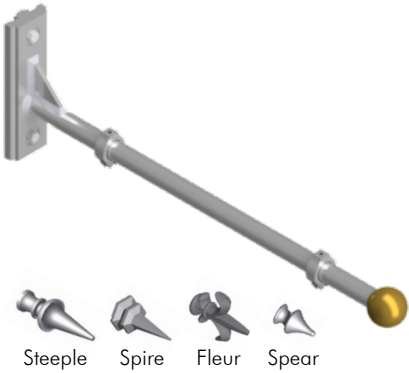

Street Name Sign Bracket, Alum VersaPole™

AP-7435 - - -

18=18" BL__=2" Ball P__=Paint
 24=24" ST__=Steeple
 30=30" SI__=Spire
 36=36" FL__=Fleur
 42=42" SE__=1-1/2" Spear
 48=48"

Note:
 Shown with ball finial. Finial may be ordered as P28 Gold or same color as assembly.

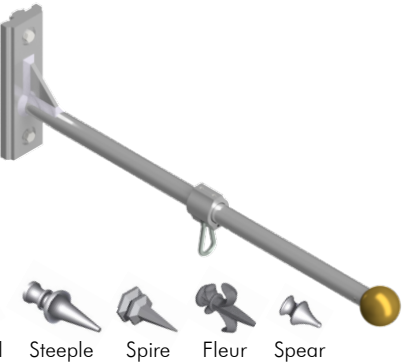

Plant Hanger, Alum VersaPole™

AP-7429 - - -

18=18" BL__=2" Ball P__=Paint
 24=24" ST__=Steeple
 SI__=Spire
 FL__=Fleur
 SE__=1-1/2" Spear

Note:
 Shown with ball finial. Finial may be ordered as P28 Gold or same color as assembly.



Camera Bracket, 1-1/2" NPS, Alum VersaPole™

SH-0559 - -

24=24" P__=Paint

- Note: 1. See T15-1 for VersaPole track mounting system.
 2. All assemblies are supplied standard with stainless steel fasteners.
 3. See Reference Section page v for available paint colors.

The Pelco's VersaPole is a fully customizable track mounting system that allows accessories to be installed, adjusted, and removed easily. It provides a decorative solution for midblock area lighting and includes both internal and external wiring raceways. Various pole top and base options available.



Signal Mount, Upper & Lower Arms, Alum VersaPole™

SE-3350 - Coating
P__=Paint



Flag Mount, for 1" Dia Rod, Alum VersaPole™



AP-7430 - Coating
P__=Paint

Equipment Mount, 1-1/2" NPT, Alum VersaPole™

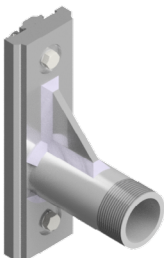

SH-0563 - Length - Coating
04=4" P__=Paint

Note: 1. See T15-1 for VersaPole track mounting system.
2. See Reference Section page v for available paint colors.



The Pelco's VersaPole is a fully customizable track mounting system that allows accessories to be installed, adjusted, and removed easily. It provides a decorative solution for midblock area lighting and includes both internal and external wiring raceways. Various pole top and base options available.



Sign Mount w/ 5/16" Hardware, Alum VersaPole™

AP-7438 -

Coating



P__=Paint

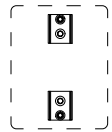

Adapter for Shepherds Hook, Alum VersaPole™

AP-7104 -

Coating



P__=Paint

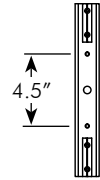

Shepherds Hook Mount



GFCI Receptacle, Weatherproof, Alum VersaPole™

AP-7431 -

Coating



P__=Paint

This page is intentionally left blank.



Bristol Series Luminaire

The Bristol LED Luminaire provides the look and charm of history. A unique modular electrical unit allows easy access for service. The Bristol Luminaire can be customized for a personalized style and requirement by selecting various options as indicated below.

AP-7520 - Wattage - Voltage - Photocell - Tenon Adapter - Optics - Finial/Color - Rib/Color - Powder Coat

30W=30 Watt UNV=Universal NPC=None Blank=None PLLG=Polycarbonate Large Globe BL28=3" Ball, Color Blank=None
 50W=50 Watt 7P=Socket Only TA=Tenon T3AC=Type III w/ Acrylic Globe T59=Tall, Color
 PC=w/ Photocell (2-7/8" OD post to 3-1/2" ID Fixture) T5AC=Type V w/ Acrylic Globe ST28=Steeple, Color TO59=Tall Open, Color
 P59=Textured Black T3DS59=Type III w/ Acrylic & Dark Sky Top, Color FL28=Fleur, Color
 P30=Automatic Green
 P39=Bronze

Notes:
 1. All LED Luminaires use 7-pin socket.
 2. Universal voltage of LED Luminaires are 120-240V.
 3. 59 refers to Textured Black powder coat color.
 28 refers to Gold powder coat color.
 See Reference Section for additional paint colors available.

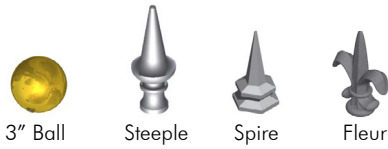

Finials



Decorative Ribs

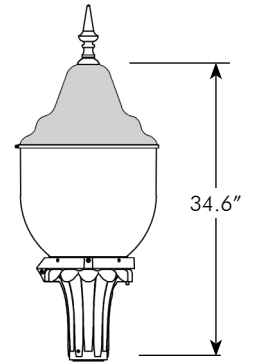

Acrylic Globe w/ Dark Sky Top

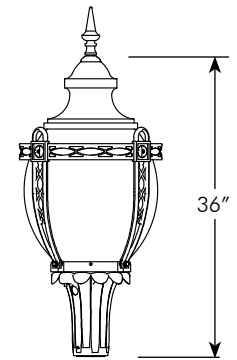

Polycarbonate Globe w/ Decorative Ribs

Note: 1. See Reference Section for available paint colors.



Windsor Series Luminaire

The Windsor LED carriage type luminaire is antique in appearance with a modular electrical unit for easy service access. The lighting panels have unique photometrics that give the appearance of multiple light sources. The Windsor Luminaire can be customized by selecting various options as indicated below.

AP-7521	-	Wattage	-	Voltage	-	Photocell	-	Tenon Adapter	-	Finial/Color	-	Powder Coat
		<input type="text"/>		<input type="text"/>		<input type="text"/>		<input type="text"/>		<input type="text"/>		<input type="text"/>
		30W=30 Watt		UNV=Universal		NPC=None 7P=Socket Only PC=w/ Photocell		Blank=None TA=Tenon (2-7/8" OD post to 3-1/2" ID Fixture)		BL28=3" Ball, Color ST28=Steeple, Color SI28=Spire, Color FL28=Fleur, Color		P59=Textured Black P30=Automatic Green P39=Bronze

Notes:

1. All LED Luminaires use 7-pin socket.
2. Universal voltage of LED Luminaires are 120-240V.
3. 59 refers to Textured Black powder coat color.
28 refers to Gold powder coat color.
See Reference Section for additional paint colors available.

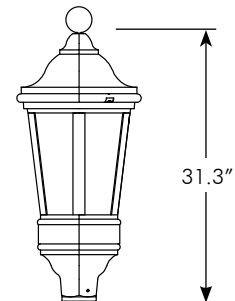

Note: 1. See Reference Section for available paint colors.



Arms, Decorative Twin Mounts

Pelco's twin arms can be mounted to a fluted or tapered pole. The twin arm mount can accommodate the Bristol or Windsor luminaire and are available with a variety of finials.

Twin Arm Assy, Fits 2-7/8" Pole Tenon, Alum w/ 3-1/2" Luminaire Tenons, 33" CTC

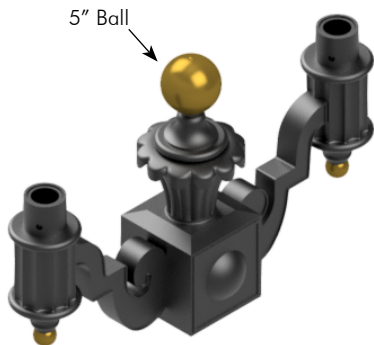

AP-8203 - -
 Finial/Color Paint
 BL__=2" & 5" Ball P__=Paint
 SI__=Spire
 SE__=Steeple
 FL__=Fleur



Note:

Finial may be ordered as P28 Gold or same color as assembly, i.e., AP-8203-BL28-P59 (as shown), for Gold Ball finial and Textured Black assembly.

Twin Arm Assy, Fits 2-7/8" Pole Tenon, Alum w/ 3-1/2" Luminaire Tenons, 35" CTC

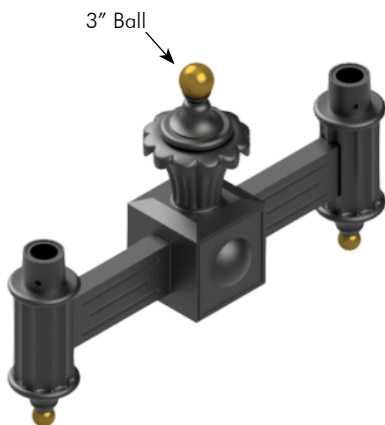

AP-8374 - -
 Finial/Color Paint
 BL__=2" & 3" Ball P__=Paint
 SI__=Spire
 SE__=Steeple
 FL__=Fleur

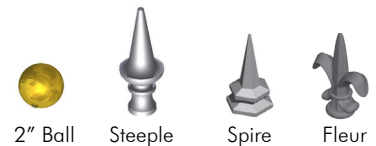

Note:

Finial may be ordered as P28 Gold or same color as assembly, i.e., AP-8374-BL28-P59 (as shown), for Gold Ball finial and Textured Black assembly.

- Note: 1. Mounting hardware not included.
 2. See Reference Section for available paint colors.



This page is intentionally left blank.



Post Top Luminaire Poles

Pelco manufactures a variety of Lighting Poles, straight, fluted, and tapered, that are available for post top mounted luminaires. Poles vary in size, shape, height, and material, and are designed to fit any requirement.

Light Pole, 3-1/2" OD Steel w/ Hand Hole

AP-0220 -

Height	Coating
05=5'	P__=Paint
08=8'	
10=10'	
12=12'	
14=14'	

2.38" x 3.5" Hand Hole

10"

5.5" Bolt Circle

5.56"

Light Pole, 3-1/2" OD w/ 2-7/8" OD Tenon Steel w/ Hand Hole

AP-0221 -

Height	Coating
05=5'	P__=Paint
08=8'	
10=10'	
12=12'	
14=14'	

2.38" x 3.5" Hand Hole

10"

5.5" Bolt Circle

5.56"

ABS Bases:

AP-0804-3.5-6.7 Old Towne I

AP-0803-3.5-6.7 Rochester

AP-0810-3.5-6.7 Hamilton

Anchors:

AP-1046-GLV Anchor Bolts Set, 1/2"-13NC

AP-1049-GLV Anchor Bolt Cage, 1/2"-13NC

Aluminum Bases:

AP-0801-3.5 Old Towne I

AP-0814-3.5 LeGrande

AP-0811-3.5 Country Club

AP-0820-3.5 Huntington

PB-5416-3.5 Octagonal

AP-0817-3.5 Oxford

Note: 1. For additional information on Bases see page T15-27 through T15-31.
 2. For Anchors see sections T11 and T12.
 3. See Reference Section page v for available paint colors.



Post Top Luminaire Poles

Pelco manufactures a variety of Lighting Poles, straight, fluted, and tapered, that are available for post top mounted luminaires. Poles vary in size, shape, height, and material, designed to fit any need.



Light Pole, 3-1/2" OD Steel w/ Lower GFCI Option

AP-0302 -	Height	GFCI	Coating
	<input type="text"/>	<input type="text"/>	<input type="text"/>
	05=5'	Blank=w/o Kit	P__=Paint
	08=8'	GFCI=w/ Kit	
	10=10'		
	12=12'		
	14=14'		

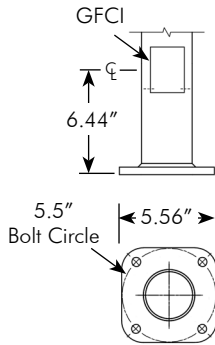

Light Pole, 3-1/2" OD Steel w/ GFCI Option

AP-0376 -	Height	GFCI	Coating
	<input type="text"/>	<input type="text"/>	<input type="text"/>
	05=5'	Blank=w/o Kit	P__=Paint
	08=8'	GFCI=w/ Kit	
	10=10'		
	12=12'		
	14=14'		

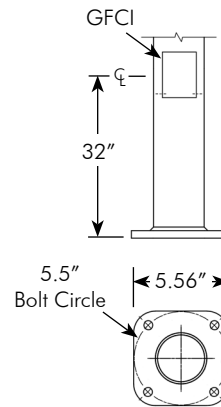

ABS Bases:

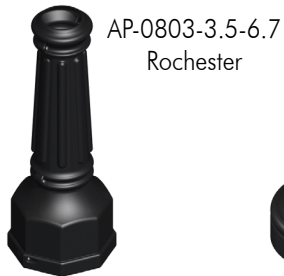

Anchors:

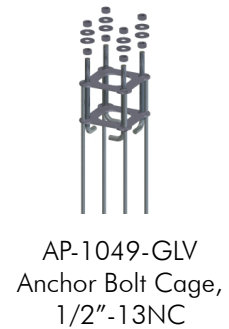
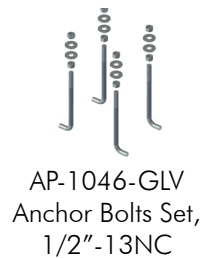

Aluminum Bases:



Note: 1. For additional information on Bases see page T15-27 through T15-31.
 2. For Anchors see sections T11 and T12.
 3. See Reference Section page v for available paint colors.



Post Top Luminaire Poles

Pelco manufactures a variety of Lighting Poles, straight, fluted, and tapered, that are available for post top mounted luminaires. Poles vary in size, shape, height, and material, designed to fit any need.

Light Pole, 4" Fluted, Alum w/ 3-1/2" OD x 2-7/8" Long Tenon, Hand Hole & Grounding Lug

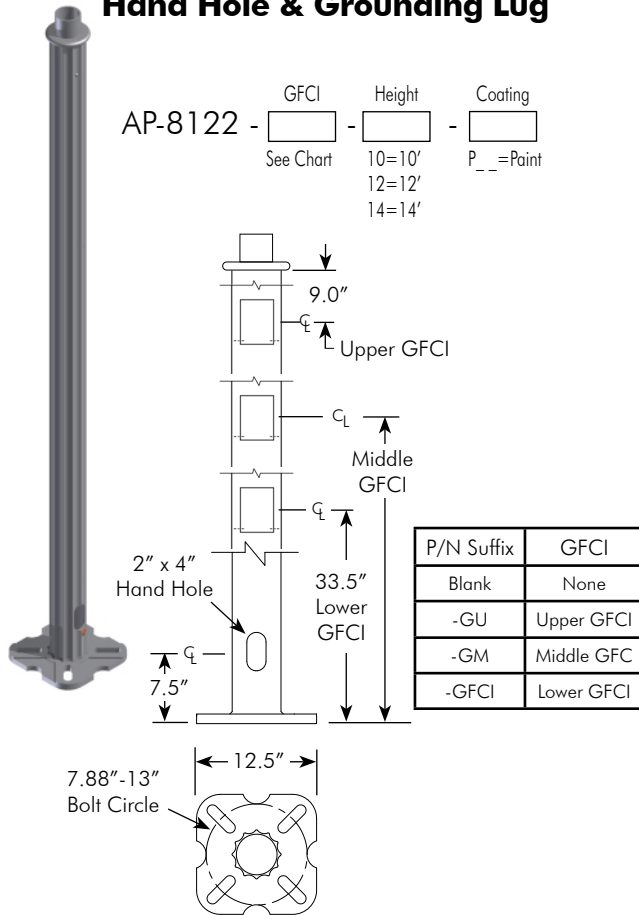

Light Pole, 4" Fluted, Alum w/ 3-1/2" OD x 2-7/8" Long Tenon, Hand Hole & Grounding Lug

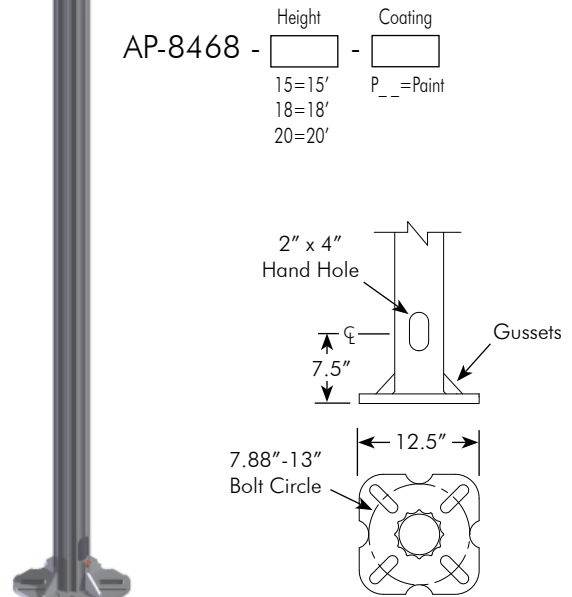

Anchors:

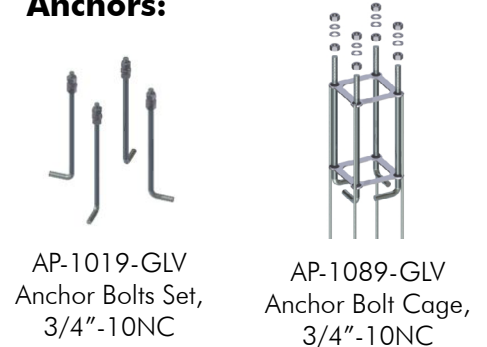

Aluminum Bases:



Note: 1. For additional information on Bases see page T15-27 through T15-31.
 2. For Anchors see sections T11 and T12.
 3. See Reference Section page v for available paint colors.



This page is intentionally left blank.



Post Top Luminaire Poles

Pelco manufactures a variety of Lighting Poles, straight, fluted, and tapered, that are available for post top mounted luminaires. Poles vary in size, shape, height, and material, designed to fit any need.



Light Pole, Fluted Tapered, Steel w/ 3-1/2" OD x 3-1/2" Long Tenon, GFCI Option

AP-8700 -

Height	GFCI	Coating
8=8' 10=10'	Blank=w/o Kit GFCI=w/ Kit	GLV=Galvanized P__=Paint

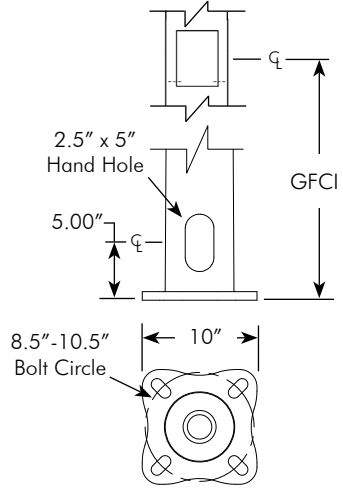

ABS Bases:



AP-0809-5.63-13.13
Rochester II
(w/o GFCI)



AP-0810-5.81-13.13
Hamilton

Anchors:



AP-1019-GLV
Anchor Bolts Set,
3/4"-10NC



AP-1089-GLV
Anchor Bolt Cage,
3/4"-10NC

Aluminum Bases:

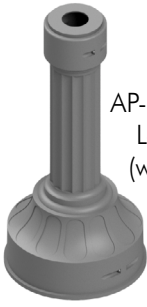

AP-0814-5.63
LeGrande
(w/o GFCI)



AP-0819-5.75
Manchester



AP-0816-5.75
Hamilton

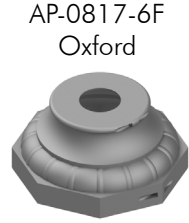

AP-0817-6F
Oxford

Note: 1. For additional information on Bases see page T15-27 through T15-31.
2. For Anchors see sections T11 and T12.
3. See Reference Section page v for available paint colors.



Post Top Luminaire Poles

Pelco manufactures a variety of Lighting Poles, straight, fluted, and tapered, that are available for post top mounted luminaires. Poles vary in size, shape, height, and material, designed to fit any need.

Direct Bury Light Pole, Tapered Steel, 11 Gauge 5.8" Butt x 19' Tall 3-1/2" OD x 3" Long Tenon w/ Hand Hole Cover & Grounding Lug

AP-3056 -

Coating
P__=Paint

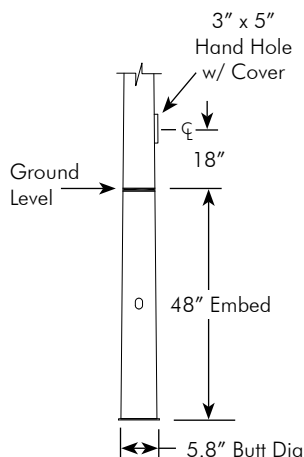

ABS Bases:



AP-0809-4.88-5.63
Rochester II



AP-0803-4.88-5.63
Rochester I

Aluminum Bases:

Ground Level →



AP-0814-4.88
LeGrande



AP-0811-5.00
Country Club

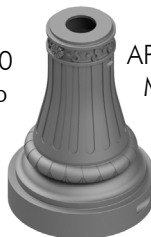

AP-0819-5.00
Manchester



AP-0816-5.00
Hamilton

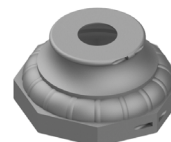

AP-0817-5.25
Oxford

Note: 1. For additional information on Bases see page T15-27 through T15-31.
2. See Reference Section page v for available paint colors.



Post Top Luminaire Poles

Pelco manufactures a variety of Lighting Poles, straight, fluted, and tapered, that are available for post top mounted luminaires. Poles vary in size, shape, height, and material, designed to fit any need.



**Direct Bury Light Pole, Tapered Steel, 11 Gauge
7.5" Butt x 25' Tall
3-1/2" OD x 3" Long Tenon
w/ Hand Hole Cover & Grounding Lug**

AP-3057 - Coating
P__=Paint

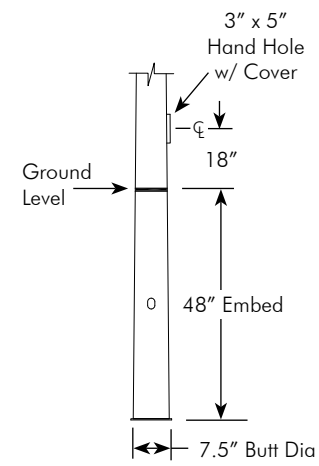

ABS Bases:



AP-0809-6.56-7.25
Rochester II

Aluminum Bases:

Ground Level →



AP-0802-6.63
Ornamental



AP-0819-6.69
Manchester



AP-0816-6.75
Hamilton

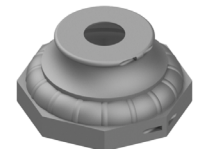

AP-0817-6.88
Oxford

Note: 1. For additional information on Bases see page T15-27 through T15-31.
2. See Reference Section page v for available paint colors.



Majestic Roadway Luminaire Poles

The Majestic Roadway Lighting Poles are available for single or twin luminaires and with 6' or 8' arms fabricated with a 29" rise. The fluted tapered steel pole offers great strength and durability, with the Hamilton base completing the classic decorative look.

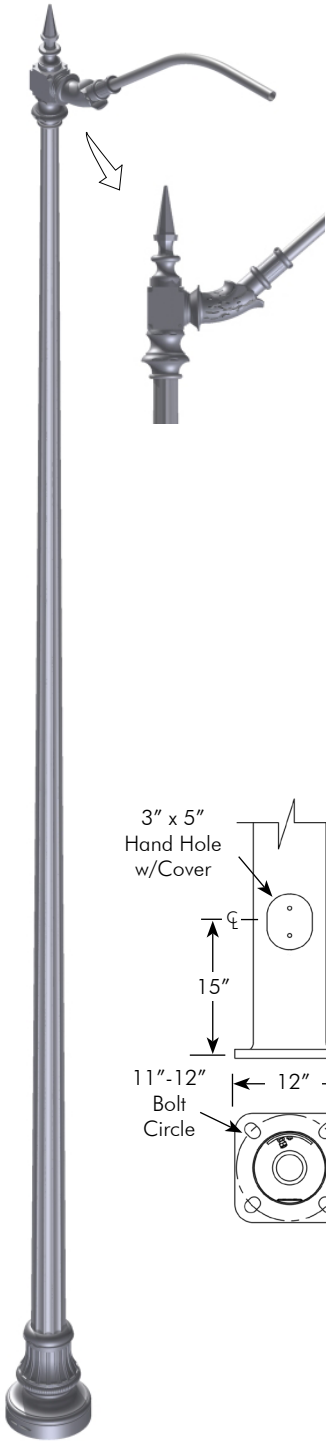

Pole Height	Arm Length	Arm	Part Number	Allowable EPA (ft ²) per arm at 90 mph with max. luminaire weight of 60 lbs	Allowable EPA (ft ²) per arm at 100 mph with max. luminaire weight of 60 lbs
30'-0"	6'-0"	Single	AP-8327	7.0	5.6
	8'-0"	Single	AP-8347	4.6	3.6

Notes:

Majestic Poles come standard with Hamilton Base. Optional base w/ Riser for use with PB-5431 break-away bolts can be specify by adding -BR, i.e., AP-8327-BR-P59.

EPA=Projected area of luminaire multiplied by coefficient of drag

Compliant with AASHTO 2013

Anchors:

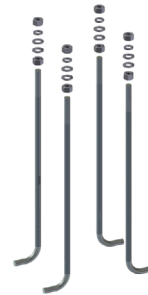
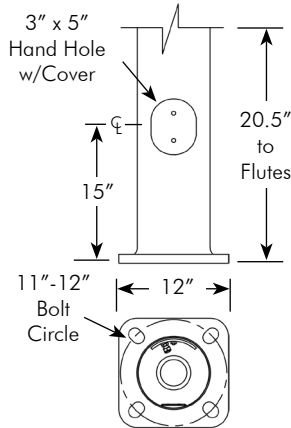

AP-1007-3-GLV
Anchor Bolts Set,
1"-8NC
w/ Template



AP-3129-GLV
Anchor Bolt Cage,
1"-8NC

Aluminum Bases:



AP-0816-7.75
Hamilton
(Standard)



AP-0823-7.75
Hamilton w/ Riser
(Optional)

- Note: 1. For additional information on Bases see page T15-27 through T15-31.
2. For Anchors see sections T11 and T12.
3. See Reference Section page v for available paint colors.



Majestic Roadway Luminaire Poles

The Majestic Roadway Lighting Poles are available for single or twin luminaires and with 6' or 8' arms fabricated with a 29" rise. The fluted tapered steel pole offers great strength and durability, with the Hamilton base completing the classic decorative look.

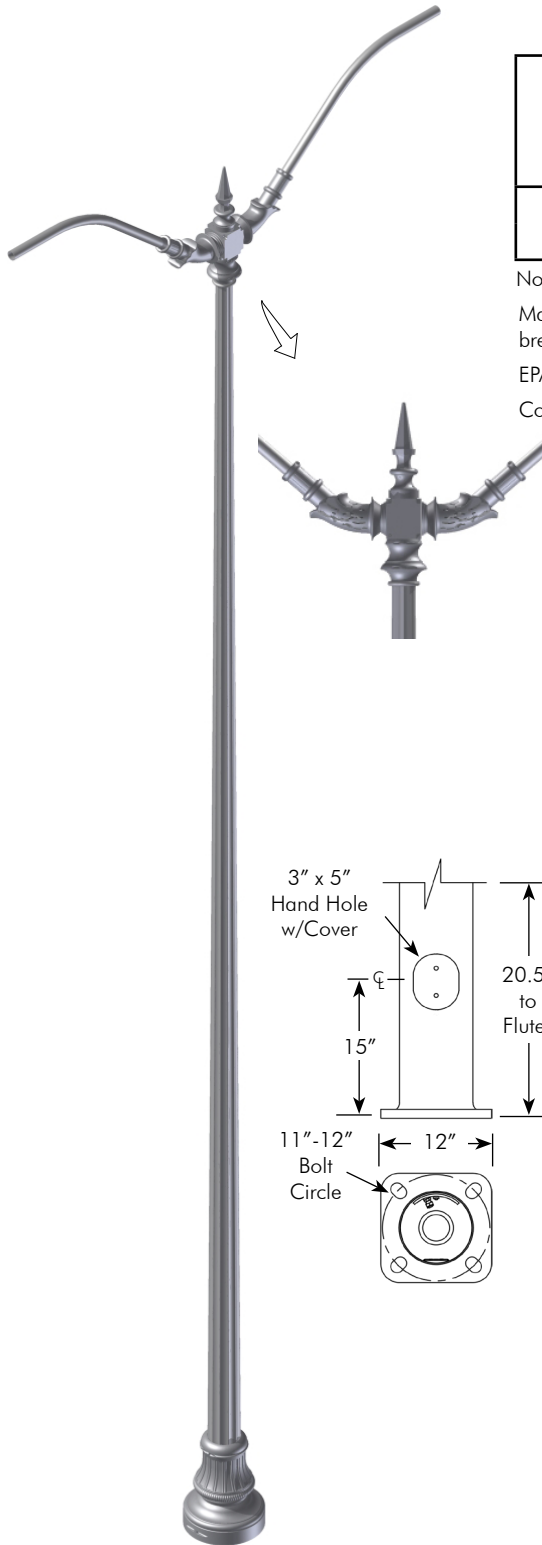

Pole Height	Arm Length	Arm	Part Number	Allowable EPA (ft ²) per arm at 90 mph with max. luminaire weight of 60 lbs	Allowable EPA (ft ²) per arm at 100 mph with max. luminaire weight of 60 lbs
30'-0"	6'-0"	Single	AP-8328	7.0	5.6
	8'-0"	Single	AP-8348	4.6	3.6

Notes:

Majestic Poles come standard with Hamilton Base. Optional base w/ Riser for use with PB-5431 break-away bolts can be specify by adding -BR, i.e., AP-8328-BR-P59.

EPA=Projected area of luminaire multiplied by coefficient of drag

Compliant with AASHTO 2013

Anchors:



AP-1007-3-GLV
Anchor Bolts Set,
1"-8NC
w/ Template



AP-3129-GLV
Anchor Bolt Cage,
1"-8NC

Aluminum Bases:



AP-0816-7.75
Hamilton
(Standard)



AP-0823-7.75
Hamilton w/ Riser
(Optional)

- Note: 1. For additional information on Bases see page T15-27 through T15-31.
 2. For Anchors see sections T11 and T12.
 3. See Reference Section page v for available paint colors.



Majestic Roadway Luminaire Poles

The Majestic Roadway Lighting Poles are available for single or twin luminaires and with 6' or 8' arms fabricated with a 29" rise. The fluted tapered steel pole offers great strength and durability, with the Hamilton base completing the classic decorative look. Available with upper, middle, or lower GFCI and handle hole.

With GFCI Options

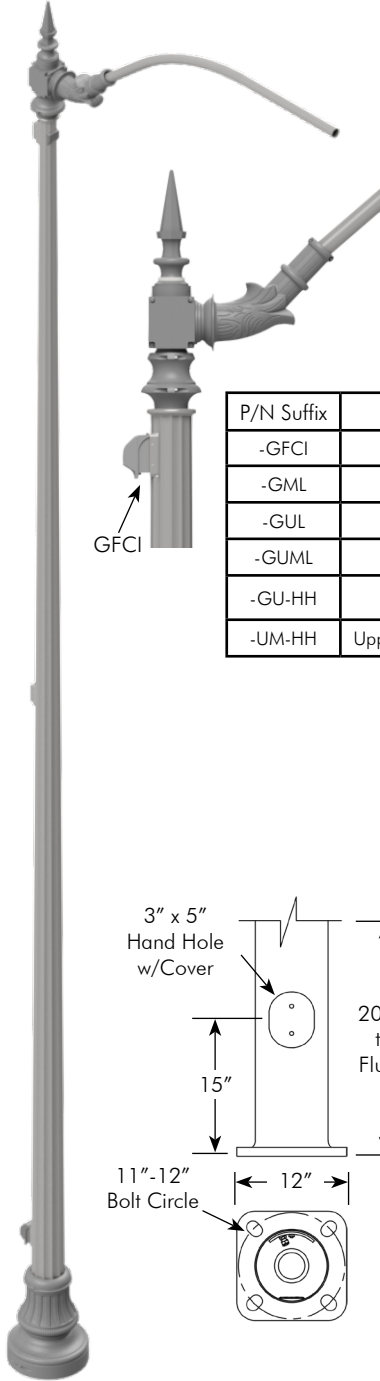

Pole Height	Arm Length	Arm	Part Number	Allowable EPA (ft ²) per arm at 90 mph with max. luminaire weight of 60 lbs	Allowable EPA (ft ²) per arm at 100 mph with max. luminaire weight of 60 lbs
20'-0"	6'-0"	Single	AP-8495	-	-
30'-0"	8'-0"	Single	AP-8381	4.6	3.6

Notes:

Majestic Poles come standard with Hamilton Base. Optional base w/ Riser for use with PB-5431 break-away bolts can be specify by adding -BR, i.e., AP-8381-BR-P59.

For GFCI and Hand Hole options see chart. Specify by adding suffix to part number , i.e., AP-8495-GFCI-P59 for a lower GFCI only. Lower GFCI not available with base riser option.

EPA=Projected area of luminaire multiplied by coefficient of drag

Compliant with AASHTO 2013

P/N Suffix	GFCI & Hand Hole	GFCI Qty
-GFCI	Lower GFCI only	1
-GML	Middle & Lower GFCI	2
-GUL	Upper & Lower GFCI	2
-GUML	Upper, Middle, & Lower GFCI	3
-GU-HH	Upper GFCI & Lower Hand Hole	1
-UM-HH	Upper & Middle GFCI & Lower Hand Hole	2

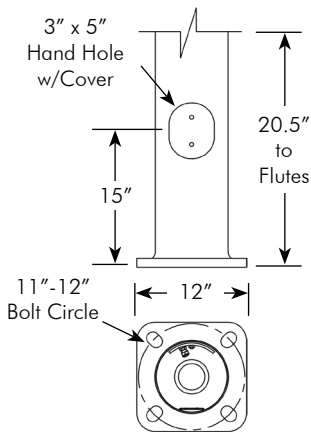

Anchors:

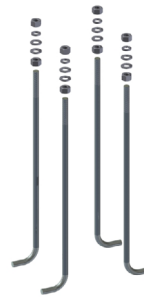

AP-1007-3-GLV
Anchor Bolts Set,
1"-8NC
w/ Template



AP-3129-GLV
Anchor Bolt Cage,
1"-8NC

Aluminum Bases:



AP-0816-7.75
Hamilton
(Standard)



AP-0823-7.75
Hamilton w/ Riser
(Optional)

- Note: 1. For additional information on Bases see page T15-27 through T15-31.
2. For Anchors see sections T11 and T12.
3. See Reference Section page v for available paint colors.



Majestic Roadway Luminaire Poles

The Majestic Roadway Lighting Poles are available for single or twin luminaires and with 6' or 8' arms fabricated with a 29" rise. The fluted tapered steel pole offers great strength and durability, with the Hamilton base completing the classic decorative look. Available with upper, middle, or lower GFCI and handle hole.

With GFCI Options

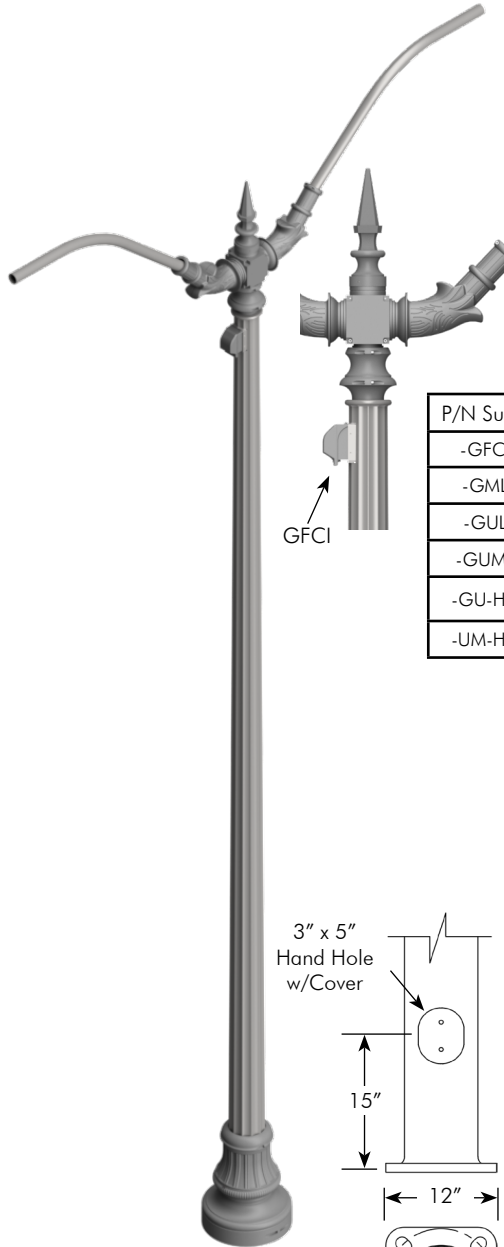

Pole Height	Arm Length	Arm	Part Number	Allowable EPA (ft ²) per arm at 90 mph with max. luminaire weight of 60 lbs	Allowable EPA (ft ²) per arm at 100 mph with max. luminaire weight of 60 lbs
20'-0"	6'-0"	Twin	AP-8496	-	-
30'-0"	8'-0"	Twin	AP-8382	4.6	3.6

Notes:

Majestic Poles come standard with Hamilton Base. Optional base w/ Riser for use with PB-5431 break-away bolts can be specify by adding -BR, i.e., AP-8382-BR-P59.

For GFCI and Hand Hole options see chart. Specify by adding suffix to part number , i.e., AP-8496-GFCI-P59 for a lower GFCI only. Lower GFCI not available with base riser option.

EPA=Projected area of luminaire multiplied by coefficient of drag

Compliant with AASHTO 2013

P/N Suffix	GFCI & Hand Hole	GFCI Qty
-GFCI	Lower GFCI only	1
-GML	Middle & Lower GFCI	2
-GUL	Upper & Lower GFCI	2
-GUML	Upper, Middle, & Lower GFCI	3
-GU-HH	Upper GFCI & Lower Hand Hole	1
-UM-HH	Upper & Middle GFCI & Lower Hand Hole	2

Anchors:

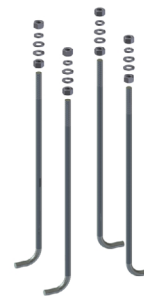

AP-1007-3-GLV
Anchor Bolts Set,
1"-8NC
w/ Template



AP-3129-GLV
Anchor Bolt Cage,
1"-8NC

Aluminum Bases:



AP-0816-7.75
Hamilton
(Standard)



AP-0823-7.75
Hamilton w/ Riser
(Optional)

Note: 1. For additional information on Bases see page T15-27 through T15-31.

2. For Anchors see sections T11 and T12.

3. See Reference Section page v for available paint colors.



Traditional Roadway Luminaire Poles

The Traditional Roadway Luminaire Poles are range from 22-1/2' through 40' heights. They are provided with either 6' or 8' single or twin arms fabricated with a 26" rise and decorative scroll. Steel tapered poles offer an affordable graceful look that can accept a variety of decorative bases or be provided with simple nut covers.

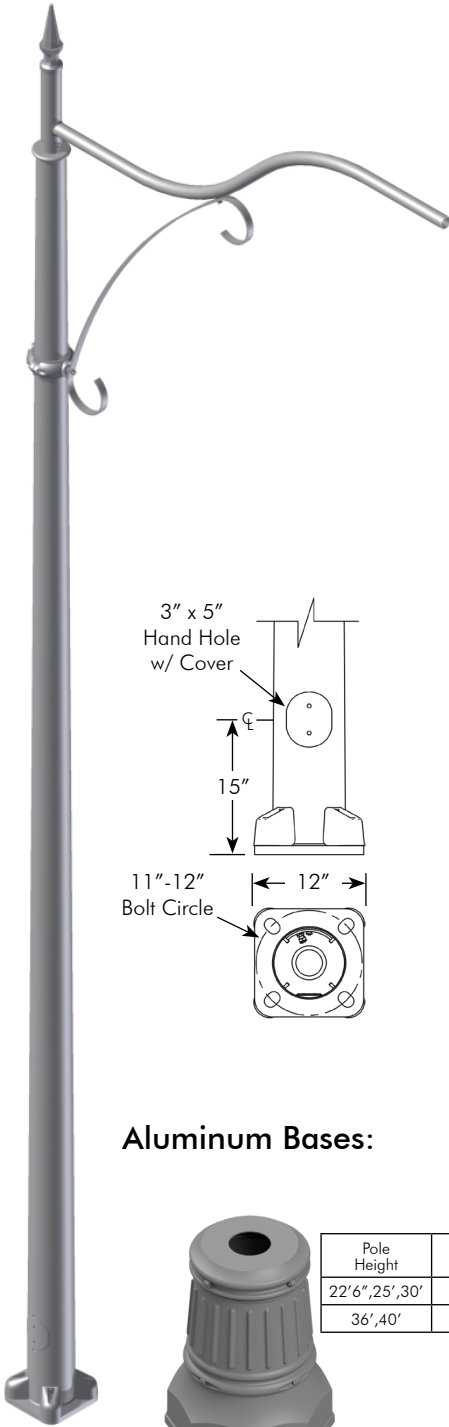

Pole Height	Arm Length	Arm	Part Number	Allowable EPA (ft ²) per arm at 90 mph with max. luminaire weight of 60 lbs	Allowable EPA (ft ²) per arm at 100 mph with max. luminaire weight of 60 lbs
22'-6"	8'-0"	Single	AP-8489	5.0	3.9
25'-0"	8'-0"	Single	AP-8556	4.8	3.8
30'-0"	8'-0"	Single	AP-8301	4.6	3.6
35'-0"	6'-0"	Single	AP-8578	-	-
40'-0"	6'-0"	Single	AP-8577	-	-

Note:

Bolt/Nut Covers are available. Specify by adding -BC in the part number, i.e., AP-8301-BC-P59

EPA=Projected area of luminaire multiplied by coefficient of drag

Compliant with AASHTO 2013

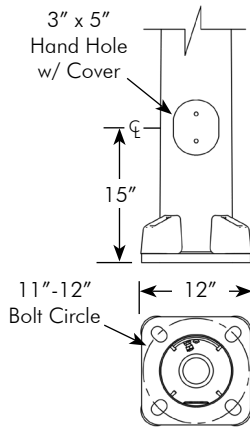

Anchors:



AP-1007-3-GLV
1"-8NC
(22'6", 25', 30' Poles)



AP-3129-GLV
1"-8NC
(22'6", 25', 30' Poles)

AP-1020-GLV
1-1/4"-7NC
(36', 40' Poles)

AP-3146-GLV
1-1/4"-7NC
(36', 40' Poles)

Aluminum Bases:

Pole Height	Base ID
22'6", 25', 30'	7.75"
36', 40'	8.75"

Hamilton Base	Pole Height	Base ID
AP-0816	22'6", 25', 30'	7.80"
AP-0823	36', 40'	8.69"

Pole Height	Base ID
22'6", 25', 30'	8.00"
36', 40'	9.00"

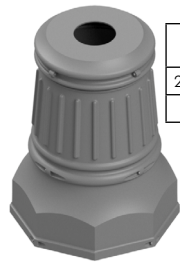

PB-5384 Rochester

Pole Height	Base ID
22'6", 25', 30'	7.69"
36', 40'	8.69"



AP-0802 Ornamental

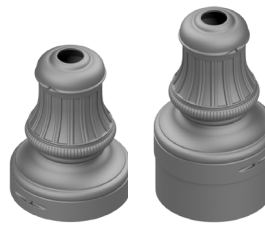

Hamilton

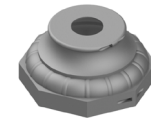

AP-0817 Oxford

Note: 1. For additional information on Bases see page T15-27 through T15-31.

2. For Anchors see sections T11 and T12.

3. See Reference Section page v for available paint colors.



Traditional Roadway Luminaire Poles

The Traditional Roadway Luminaire Poles are range from 22-1/2' through 40' heights. They are provided with either 6' or 8' single or twin arms fabricated with a 26" rise and decorative scroll. Steel tapered poles offer an affordable graceful look that can accept a variety of decorative bases or be provided with simple nut covers.

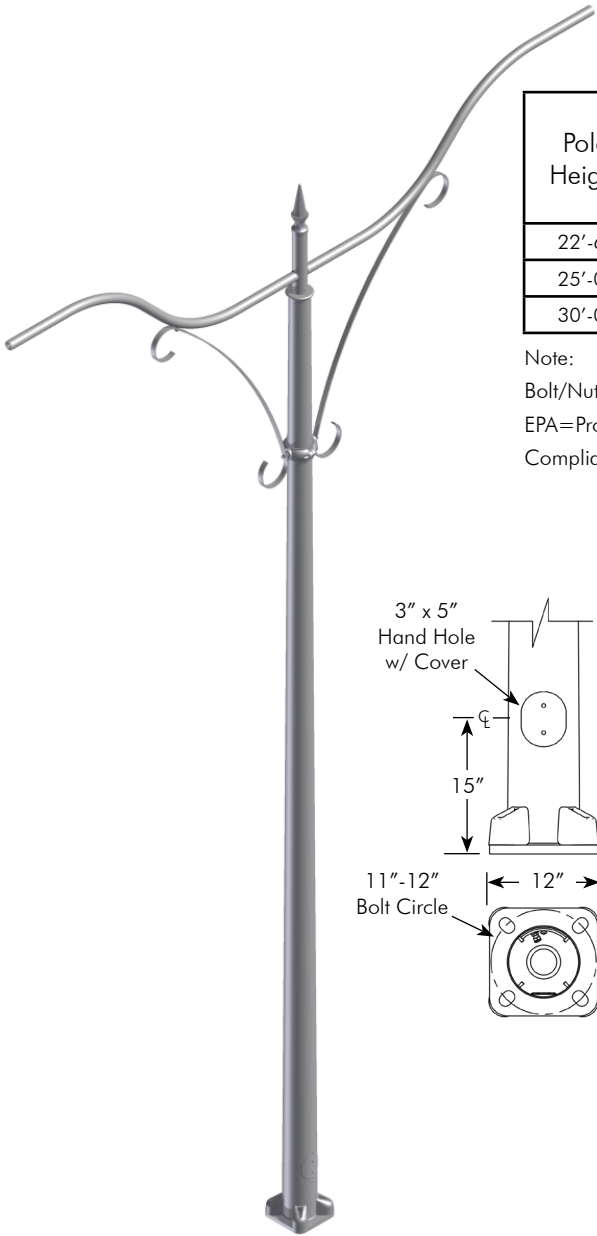

Pole Height	Arm Length	Arm	Part Number	Allowable EPA (ft ²) per arm at 90 mph with max. luminaire weight of 60 lbs	Allowable EPA (ft ²) per arm at 100 mph with max. luminaire weight of 60 lbs
22'-6"	8'-0"	Twin	AP-8490	5.0	3.9
25'-0"	8'-0"	Twin	AP-8563	4.8	3.8
30'-0"	8'-0"	Twin	AP-8302	4.6	3.6

Note:
 Bolt/Nut Covers are available. Specify by adding -BC in the part number, i.e., AP-8302-BC-P59
 EPA=Projected area of luminaire multiplied by coefficient of drag
 Compliant with AASHTO 2013

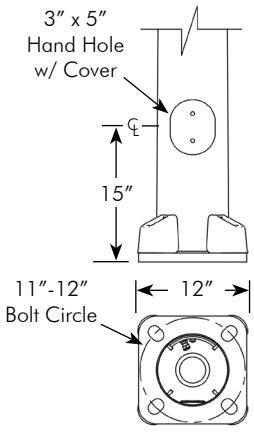

Anchors:

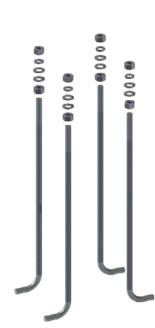

AP-1007-3-GLV
Anchor Bolt Set,
1"-8NC



AP-3129-GLV
Anchor Bolt Cage,
1"-8NC

Aluminum Bases:

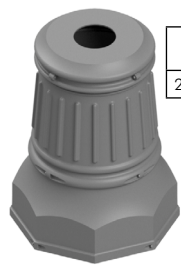

PB-5384 Rochester

Pole Height	Base ID
22'6",25',30'	7.69"



AP-0802 Ornamental

Pole Height	Base ID
22'6",25',30'	7.75"

Pole Height	Base ID
22'6",25',30'	7.80"



Hamilton

Pole Height	Base ID
22'6",25',30'	8.00"

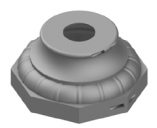

AP-0817 Oxford

Note: 1. For additional information on Bases see page T15-27 through T15-31.
 2. For Anchors see sections T11 and T12.
 3. See Reference Section page v for available paint colors.



Simplex Roadway Luminaire Poles

The Simplex Roadway Luminaire Poles are available in 25' through 40' heights. They are provided with either 6' or 8' single or twin arms fabricated with a 24" rise. The steel tapered poles can accept a variety of decorative bases or be provided with simple nut covers.

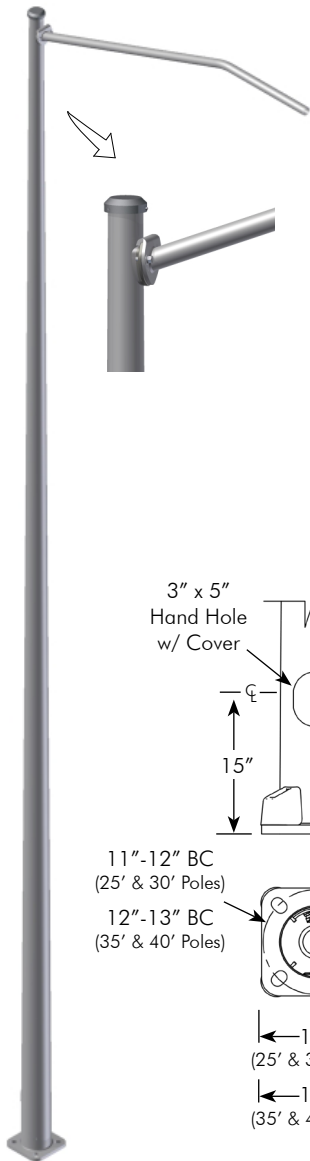

Pole Height	Arm Length	Arm	Part Number	Allowable EPA (ft ²) per arm at 90 mph with max. luminaire weight of 60 lbs	Allowable EPA (ft ²) per arm at 100 mph with max. luminaire weight of 60 lbs
25'-0"	6'-0"	Single	AP-8571-25-6	6.8	5.4
	8'-0"	Single	AP-8571-25-8	4.5	3.5
30'-0"	6'-0"	Single	AP-8571-30-6	6.5	5.2
	8'-0"	Single	AP-8571-30-8	4.3	3.3
35'-0"	6'-0"	Single	AP-8571-35-6	6.3	5.0
	8'-0"	Single	AP-8571-35-8	4.1	3.2
40'-0"	6'-0"	Single	AP-8571-40-6	6.1	4.8
	8'-0"	Single	AP-8571-40-8	4.0	3.1

Note:

Bolt/Nut Covers are available. Specify by adding -BC in the part number, i.e., AP-8571-30-6-BC-GLV.

EPA=Projected area of luminaire multiplied by coefficient of drag

Compliant with AASHTO 2013

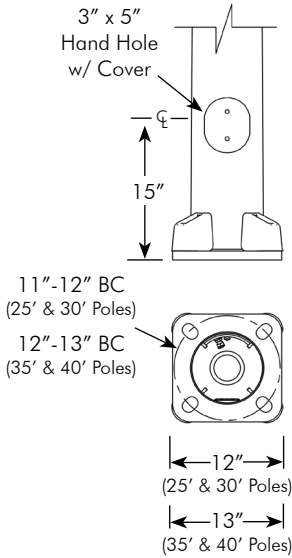

Anchors:

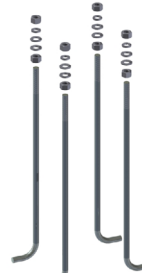

AP-1007-3-GLV
1"-8NC
(25' & 30' Poles)

AP-1020-GLV
1-1/4"-7NC
(35' & 40' Poles)



AP-3129-GLV
1"-8NC
(25' & 30' Poles)

AP-3146-GLV
1-1/4"-7NC
(35' & 40' Poles)

Aluminum Bases:



PB-5384 Rochester

Pole Height	Base ID
25'	7.13"
30'	7.63"
35'	8.13"
40'	8.63"



AP-0802 Ornamental

Pole Height	Base ID
25'	7.25"
30'	7.75"
35'	8.25"
40'	8.75"



AP-0816 Hamilton

Pole Height	Base ID
25'	7.31"
30'	7.88"
35'	N/A
40'	N/A

Pole Height	Base ID
25'	7.50"
30'	8.00"
35'	8.44"
40'	9.00"

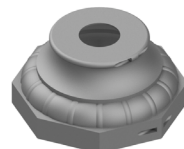

AP-0817 Oxford

Note: 1. For additional information on Bases see page T15-27 through T15-31.

2. For Anchors see sections T11 and T12.

3. See Reference Section page v for available paint colors.



Simplex Roadway Luminaire Poles

The Simplex Roadway Luminaire Poles are available in 25' through 40' heights. They are provided with either 6' or 8' single or twin arms fabricated with a 24" rise. The steel tapered poles can accept a variety of decorative bases or be provided with simple nut covers.



Pole Height	Arm Length	Arm	Part Number	Allowable EPA (ft ²) per arm at 90 mph with max. luminaire weight of 60 lbs	Allowable EPA (ft ²) per arm at 100 mph with max. luminaire weight of 60 lbs
25'-0"	6'-0"	Twin	AP-8572-25-6	6.8	5.4
	8'-0"	Twin	AP-8572-25-8	4.5	3.5
30'-0"	6'-0"	Twin	AP-8572-30-6	6.5	5.2
	8'-0"	Twin	AP-8572-30-8	4.3	3.3
35'-0"	6'-0"	Twin	AP-8572-35-6	6.3	5.0
	8'-0"	Twin	AP-8572-35-8	4.1	3.2
40'-0"	6'-0"	Twin	AP-8572-40-6	6.1	4.8
	8'-0"	Twin	AP-8572-40-8	4.0	3.1

Note:

Bolt/Nut Covers are available. Specify by adding -BC in the part number, i.e., AP-8572-30-6-BC-GLV.

EPA=Projected area of luminaire multiplied by coefficient of drag

Compliant with AASHTO 2013

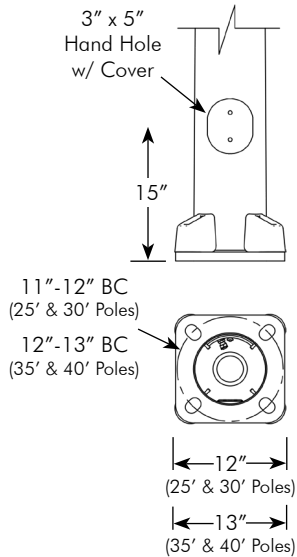

Anchors:

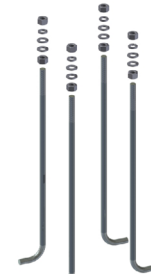

AP-1007-3-GLV
1"-8NC
(25' & 30' Poles)

AP-1020-GLV
1-1/4"-7NC
(35' & 40' Poles)



AP-3129-GLV
1"-8NC
(25' & 30' Poles)

AP-3146-GLV
1-1/4"-7NC
(35' & 40' Poles)

Aluminum Bases:



Pole Height	Base ID
25'	7.13"
30'	7.63"
35'	8.13"
40'	8.63"

PB-5384 Rochester

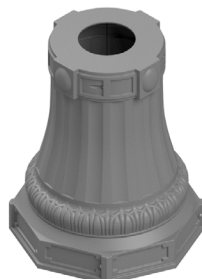

Pole Height	Base ID
25'	7.25"
30'	7.75"
35'	8.25"
40'	8.75"

AP-0802 Ornamental



Pole Height	Base ID
25'	7.31"
30'	7.88"
35'	N/A
40'	N/A

AP-0816 Hamilton

Pole Height	Base ID
25'	7.50"
30'	8.00"
35'	8.44"
40'	9.00"

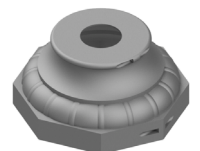

AP-0817 Oxford

Note: 1. For additional information on Bases see page T15-27 through T15-31.

2. For Anchors see sections T11 and T12.

3. See Reference Section page v for available paint colors.



This page is intentionally left blank.



ABS Plastic Bases

Pelco ABS Plastic Bases are manufactured from an ultraviolet inhibited material that provides protections against U.V. degradation which ensures years of lasting beauty. A variety of styles and sizes are available. Lightweight and easy installation.



AP-0804 - $\begin{matrix} \text{Top ID} \\ \square \\ 3.5=3-1/2" \end{matrix}$ - $\begin{matrix} \text{Bottom ID} \\ \square \\ 7.5=7-1/2" \end{matrix}$ - PNC

Note: Top Opening: 3-1/2" max
Bottom Opening: 7-1/2" max



Rochester I Base Assy, Black ABS Plastic 41" High x 15-11/16" Across Points

AP-0803 - $\begin{matrix} \text{Top ID} \\ \square \\ 5.75=5-3/4" \end{matrix}$ - $\begin{matrix} \text{Bottom ID} \\ \square \\ 11.0=11" \end{matrix}$ - PNC

Note: Top Opening: 5-3/4" max
Bottom Opening: 11" max



Rochester II Base Assy, Black ABS Plastic 41" High x 19" Across Points

AP-0809 - $\begin{matrix} \text{Top ID} \\ \square \\ 9.0=9" \end{matrix}$ - $\begin{matrix} \text{Bottom ID} \\ \square \\ 15.0=15" \end{matrix}$ - PNC

Note: Top Opening: 9" max
Bottom Opening: 15" max



Hamilton Base Assy, Black ABS Plastic 21" High x 16-1/8" Base Dia

AP-0810 - $\begin{matrix} \text{Top ID} \\ \square \\ 6.5=6-1/2" \end{matrix}$ - $\begin{matrix} \text{Bottom ID} \\ \square \\ 14.5=14-1/2" \end{matrix}$ - PNC

Note: Top Opening: 6-1/2" max
Bottom Opening: 14-1/2" max

- Note: 1. Refer to individual pole pages for cross reference for proper fit of base and pole.
2. ABS Plastic Bases are manufactured from an ultraviolet inhibited material that provides protections against U.V. degradation.

Aluminum Bases

Pelco has several different Aluminum Base designs. A variety of styles and sizes are available to fit any specific requirement.



Old Town I Base Assy, Alum 23-1/2" High x 9-1/4" Across Points

AP-0801 - -
 Base ID Coating
 2.38=2-3/8" PNC=Process No Color
 2.88"=2-7/8" P_ _=Paint
 3.5=3-1/2"

Note: Top Opening: 2-3/8" min to 3-1/2" max
 Bottom Opening: 7-1/2" max



Country Club Base Assy, Alum 28" High x 13-5/8" OD

AP-0811 - -
 Base ID Coating
 3.5=3-1/2" PNC=Process No Color
 4.5=4-1/2" P_ _=Paint
 3F= 3" Fluted

Note: Top Opening: 3-1/2" min to 4-1/2" max
 Bottom Opening: 12" max

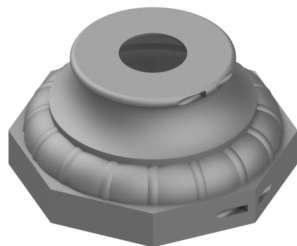

Oxford Base Assy, Alum 9" High x 19-1/4" Across Points

AP-0817 - -
 Base ID Coating
 8.5= 8-1/2" PNC=Process No Color
 4F=4" Fluted P_ _=Paint
 6F=6" Fluted

Note: Top Opening: 3-1/2" min to 8-1/2" max
 Bottom Opening: 17" max

Note: 1. Refer to individual pole pages for cross reference for proper fit of base and pole.
 2. See Reference Section page v for available paint colors.



Aluminum Bases

Pelco has several different Aluminum Base designs. A variety of styles and sizes are available to fit any specific requirement.



Huntington Base Assy, Alum 15-3/4" High x 11-1/4" OD

AP-0820 - -
 Base ID Coating
 3.5=3-1/2" PNC=Process No Color
 4.0=4" P__=Paint

Note: Top Opening: 3" min to 4" max
 Bottom Opening: 10-3/4" max



Manchester Base Assy w/ Door, Alum 27" High x 18-1/2" OD

AP-0819 - -
 Base ID Coating
 4.0=4" PNC=Process No Color
 7.0=7" P__=Paint
 4F=4" Fluted

Note: Top Opening: 4" min to 7" max
 Bottom Opening: 11-1/2" max

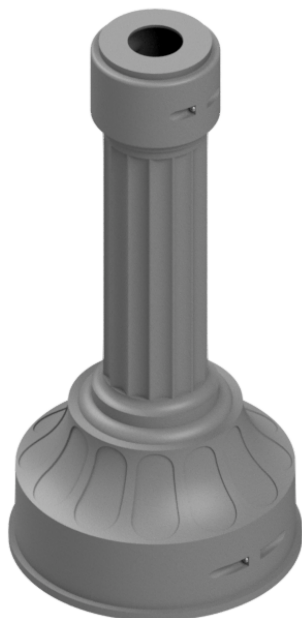

LeGrande Base Assy, Alum 38" High x 18-1/2" OD

AP-0814 - -
 Base ID Coating
 3.5=3-1/2" PNC=Process No Color
 4.5=4-1/2" P__=Paint
 5.5=5-1/2"
 3F= 3" Fluted
 4F=4" Fluted

Note: Top Opening: 3-1/2" min to 5-3/4" max
 Bottom Opening: 17" max

Note: 1. Refer to individual pole pages for cross reference for proper fit of base and pole.
 2. See Reference Section page v for available paint colors.

Aluminum Bases

Pelco has several different Aluminum Base designs. A variety of styles and sizes are available to fit any specific requirement.

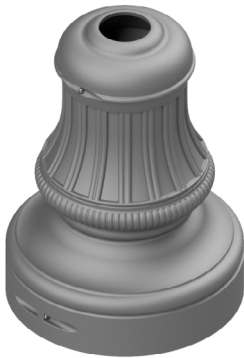

Hamilton Base Assy, Alum 24" High x 18-1/2" OD

	Base ID	Coating
AP-0816	- <input type="text"/>	- <input type="text"/>
	4.06=4-1/16"	PNC=Process No Color
	4.5=4-1/2"	P__=Paint
	5.5=5-1/2"	
	8.5=8-1/2" (max)	

Note: Top Opening: 4" min to 8-1/2" max
Bottom Opening: 16-3/4" max



Hamilton Base Assy w/ Riser, Alum 24" High x 18-1/2" OD

	Base ID	Coating
AP-0823	- <input type="text"/>	- <input type="text"/>
	4.06=4-1/16"	PNC=Process No Color
	4.5=4-1/2"	P__=Paint
	5.5=5-1/2"	
	8.5=8-1/2" (max)	

Note: Top Opening: 4" min to 8-1/2" max
Bottom Opening: 16-3/4" max
To be used with PB-5431 break-away bolts.



Octagonal Base Assy, Alum 14-3/16" High x 17-13/16" Across Points

	Base ID	Coating
PB-5416	- <input type="text"/>	- <input type="text"/>
	2.88=2-7/8"	PNC=Process No Color
	3.5=3-1/2"	P__=Paint
	4=4"	
	4.5=4-1/2"	
	5=5"	

Note: Top Opening: 2-7/8" min to 5" max
Bottom Opening: 16" max

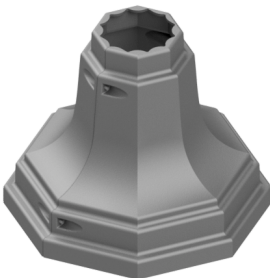

Octagonal Base Assy, for 4" Fluted Pole, Alum 14" High x 17-13/16" Across Points

	Coating
PB-5414	- <input type="text"/>
	PNC=Process No Color
	P__=Paint

Note: Top Opening: 4" Fluted Only
Bottom Opening: 16" max

Note: 1. Refer to individual pole pages for cross reference for proper fit of base and pole.
2. See Reference Section page v for available paint colors.



Aluminum Bases

Pelco has several different Aluminum Base designs. A variety of styles and sizes are available to fit any specific requirement.

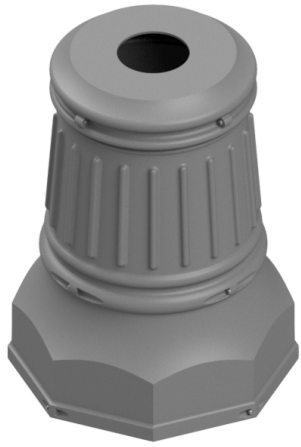

Rochester Base Assy, Alum 36" High x 28" Across Points

PB -5384 - -
 Base ID Coating
 8.0=8" PNC=Process No Color
 10.63=10-5/8" P__=Paint
 14.13=14-1/8"
 16"=16"

Note: Top Opening: 8" min to 16" max
Bottom Opening: 26" max



Ornamental Base Assy, Alum 32" High x 28-3/4" Across Points

AP-0802 - - -
 Base ID Trim Coating
 8.0=8" T__=Trim Color PNC=Process No Color
 10.0=10" P__=Paint
 12.0=12"

Note: Top Opening: 6" min to 12" max
Bottom Opening: 23" max

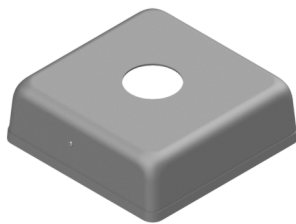

Square Cover Assy, 2-Piece, Alum 5-1/4" High x 16" Square

PB-5399 - -
 Base ID Coating
 4.5=4-1/2" PNC=Process No Color
 6.8=6-13/16" P__=Paint
 7.5=7-1/2"
 8.0=8-1/2"

Note: Top Opening: 4-1/2" min to 8-5/8" max
Bottom Opening: 15" max

Note: 1. Refer to individual pole pages for cross reference for proper fit of base and pole.
2. See Reference Section page v for available paint colors.



Lighting Arms

Pelco manufactures a variety of Lighting Arms that are available for single or twin luminaires. Both 1-5/8" and 2-3/8" diameter arms are available in aluminum and steel.

For 2-3/8" Tenon

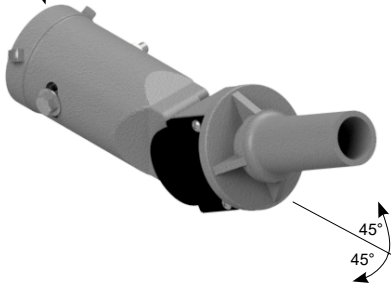

Lumi-Brac, Adjustable View 2-3/8" OD Tenon Mount, Alum

Tenon Coating
 SP-6350 - -
 Blank= 1-5/8" OD x 4" PNC= Process No Color
 1.9=1-7/8" OD x 7" P__=Paint
 2.38=2-3/8" OD x 7"

Note:
 For mounting a single security light or Wi Fi antenna.

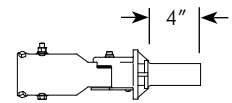

Lumi-Brac, 1-5/8" Dia Tenon, Adjustable View Stainless Cable Mount, Alum

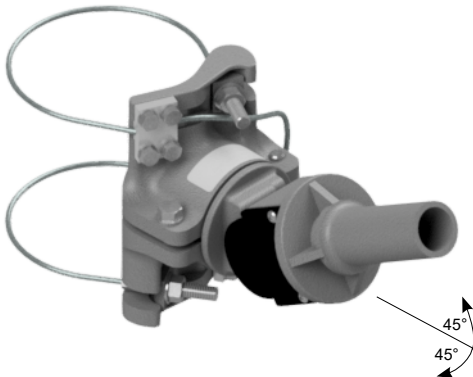

Cable Length Coating
 SP-6351 - -
 See Table PNC= Process No Color
 P__=Paint

Cable Length:	62"	84"	96"	110"	120"	132"	144"	220"	280"
Maximum Pole Dia:	7.0"	10.5"	12.4"	14.6"	16.2"	18.2"	20.1"	32.2"	35.0"
Pole Dia w/ Ty-back:	4.5"	7.6"	9.6"	11.8"	13.4"	15.3"	17.2"	29.3"	35.0"

Note:
 For mounting a single security light or Wi Fi antenna.

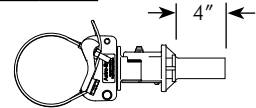

Lumi-Brac, 1-5/8" Dia Tenon, Adjustable View Simplex Mount, Alum

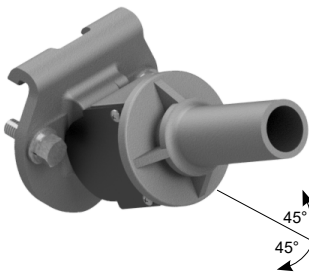

Coating
 SP-6353 -
 PNC= Process No Color
 P__=Paint

Note:
 For mounting a single security light or Wi Fi antenna.

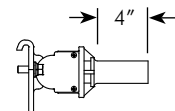

Note: 1. All assemblies are supplied standard with stainless steel cable, clamp screw, and fasteners.
 2. See Reference Section page v for available paint colors.



Lighting Arms

Pelco manufactures a variety of Lighting Arms that are available for single or twin luminaires. Both 1-5/8" and 2-3/8" diameter arms are available in aluminum and steel.

Mounting Bracket Assy, Double Luminaire Arm, 2-3/8" Dia, Galvanized Steel

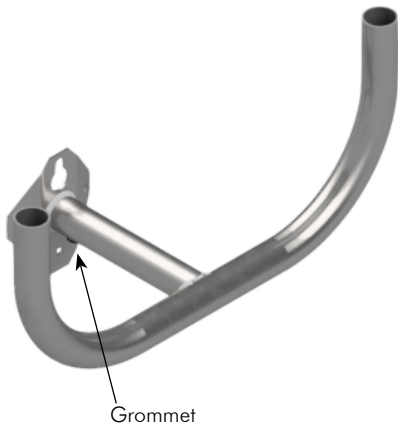

SP-6308 - Coating
 GLV= Galvanized
 P_ =Paint

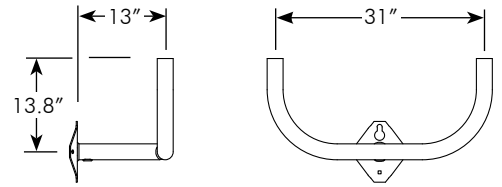

Note:
 Bullhorn mounting brackets mount with an offset from the wood pole.
 Includes rubber grommet on the underneath side for wiring. Mounting hardware not included.

Mounting Arm Assy, Flood Light, 2-3/8" OD, Galvanized Steel

SP-6349-GLV

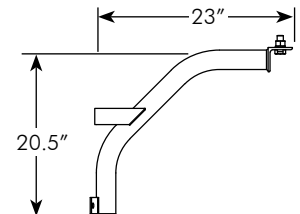

Note:
 Mounting arm with a 2-3/8" OD pipe for mounting a single flood light with the 3/4"-10NC supplied hardware.

Note: 1. See Reference Section page v for available paint colors.



Lighting Arms

Pelco manufactures a variety of Lighting Arms that are available for single or twin luminaires. Both 1-5/8" and 2-3/8" diameter arms are available in aluminum and steel.

Luminaire Support Arm, 1-5/8" Dia, Upsweep, Galvanized Steel



SP-6272 - Coating
 GLV= Galvanized
 P__=Paint

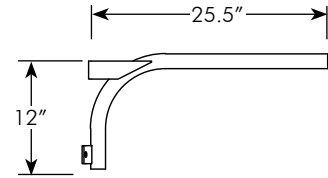

Note:
 For mounting a single security light or Wi Fi antenna.
 Mounting hardware not included.

Luminaire Mounting Arm, 1-5/8" Dia w/ Hardware, 1-5/8" Dia, Alum

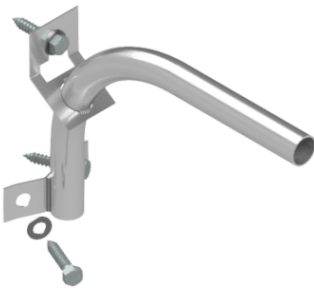

SP-6348 - - PNC Arm Length
 16=16"
 24=14"
 30=30"

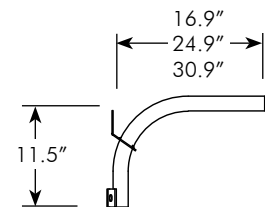

Part Number	EPA (ft ^2) per arm at 120 mph with max. luminaire weight of 30 lbs
SP-6348-16-PXX	3.0
SP-6348-24-PXX	2.0
SP-6348-30-PXX	3.6

Note:
 For mounting a single security light or Wi Fi antenna.
 Includes three 3/8"-16 x 3" hex head lag bolts and flat washers.

Note: 1. See Reference Section page v for available paint colors.



Lighting Arms

Pelco manufactures a variety of Lighting Arms that are available for single or twin luminaires. Both 1-5/8" and 2-3/8" diameter arms are available in aluminum and steel.

Luminaire Mounting Arm, 2-3/8" OD Galvanized Steel

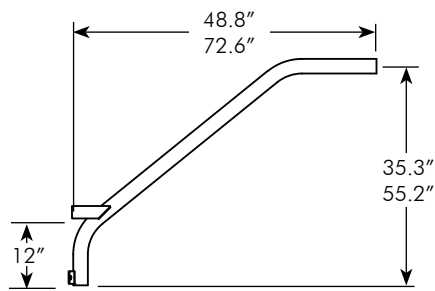
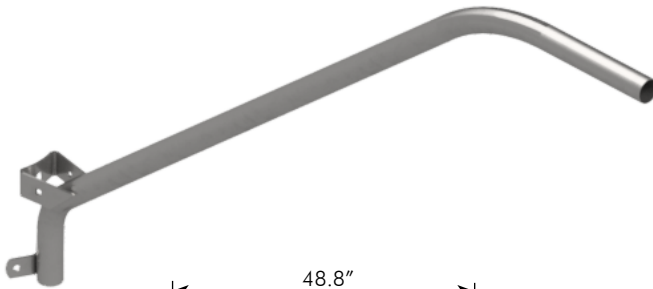

SP-6309 -	Arm Length	-	Coating
	<input type="text"/>	-	<input type="text"/>
	4=4'		GLV=Galvanized
	6=6'		P__=Paint

Note:
For mounting a single luminaire on 2" Sch10 (2-3/8") pipe with a 4' length x 35" rise or 6' length x 55" rise. Mounting hardware not included. Galvanized or powder coated.

Luminaire Arm, Clamp-on 3" Sch 40 w/ 2-3/8" Dia x 8" Tenon, Steel

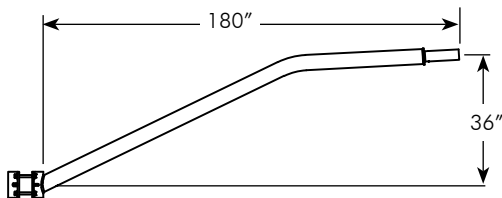
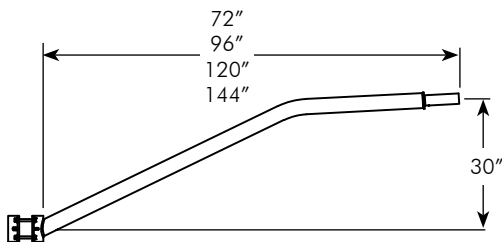

For 4"-5" Dia Pole

AP-3001 -	Arm Length	-	Coating
	<input type="text"/>	-	<input type="text"/>
	72=6'		GLV=Galvanized
	96=8'		P__=Paint
	120=10'		
	144=12'		
	180=15'		

For 5-1/2" to 7-1/2" Dia Pole

AP-3002 -	Arm Length	-	Coating
	<input type="text"/>	-	<input type="text"/>
	96=8'		GLV=Galvanized
	120=10'		GLV-P__=Paint
	144=12'		
	180=15'		

Note:
For mounting a single luminaire onto the 2-3/8" OD x 8" long tenon. Includes 1/2"-13NC hardware for attaching arm to the pole. Galvanized or powder coated.

Note: 1. See Reference Section page v for available paint colors.



This page is intentionally left blank.



Banner Brackets

Pelco has a wide variety of mounting bracket for banners and flags. Choose from ornamental hubs, banded mini-bracs, or flat mounted hubs. Banner bracs for square poles are also available, as well as articulating arms for collapsing against the pole when not in use.

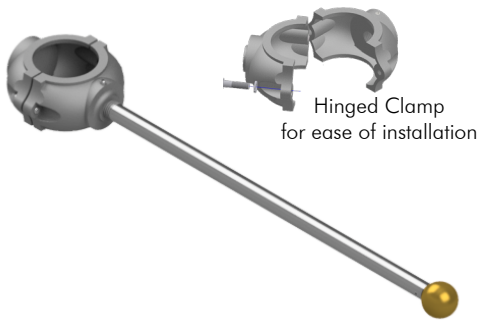

Banner Mounting Bracket, Alum Hinged Single Arm,

	Pole Dia	Banner Width	Finial/Color	Coating
SH-3551	- [] -	[] -	[] -	[]
	2.38=2-3/8"	18=18"	BL_ =2" Ball	P_ =Paint
	2.88=2-7/8"	24=24"	ST_ =Steeple	
	3.50=3-1/2"	30=30"	SI_ =Spire	
	4.06=3" Fluted	36=36"	FL_ =Fleur	
	4.50=4-1/2"		SE_ =1-1/2" Spear	
	5.08=4" Fluted			
	5.56=5-9/16"			



Note:
 Finial may be ordered as P28 Gold or same color as assembly, i.e., SH-3551-3.50-24-BL28-P33, for Gold Ball finial and Gloss Black assembly.

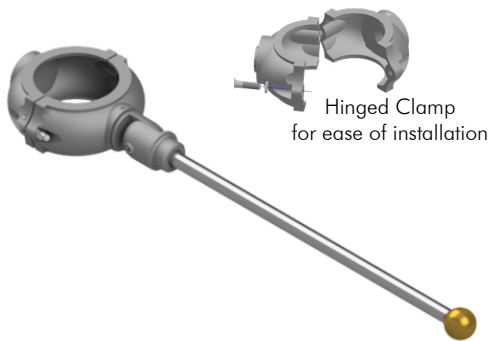

Banner Mounting Bracket, Alum Hinged Articulating Single Arm

	Pole Dia	Banner Width	Finial/Color	Coating
SH-3547	- [] -	[] -	[] -	[]
	2.38=2-3/8"	18=18"	BL_ =2" Ball	P_ =Paint
	2.88=2-7/8"	24=24"	ST_ =Steeple	
	3.50=3-1/2"	30=30"	SI_ =Spire	
	4.06=3" Fluted	36=36"	FL_ =Fleur	
	4.50=4-1/2"		SE_ =1-1/2" Spear	
	5.08=4" Fluted			
	5.56=5-9/16"			



Note:
 Finial may be ordered as P28 Gold or same color as assembly, i.e., SH-3547-3.50-24-BL28-P33, for Gold Ball finial and Gloss Black assembly.

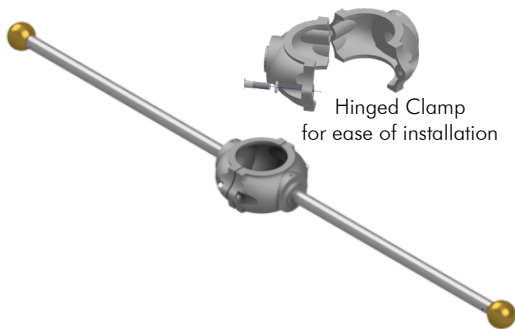
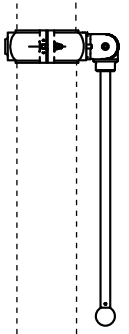

Banner Mounting Bracket, Alum Hinged Double Arm,

	Pole Dia	Banner Width	Banner Width	Finial/Color	Coating
SH-3556	- [] -	[] -	[] -	[] -	[]
	2.38=2-3/8"	18=18"	18=18"	BL_ =2" Ball	P_ =Paint
	2.88=2-7/8"	24=24"	20=21"	ST_ =Steeple	
	3.50=3-1/2"	30=30"	24=24"	SI_ =Spire	
	4.06=3" Fluted	36=36"	30=30"	FL_ =Fleur	
	4.50=4-1/2"		36=36"	SE_ =1-1/2" Spear	
	5.08=4" Fluted				
	5.56=5-9/16"				



Note:
 Finial may be ordered as P28 Gold or same color as assembly, i.e., SH-3556-3.50-24-24-BL28-P33, for Gold Ball finial and Gloss Black assembly.

Note: 1. 2 bracket assemblies are required for mounting a banner.
 2. See Reference Section page v for available paint colors.



Banner Brackets

Pelco has a wide variety of mounting bracket for banners and flags. Choose from ornamental hubs, banded mini-bracs, or flat mounted hubs. Banner bracs for square poles are also available, as well as articulating arms for collapsing against the pole when not in use.

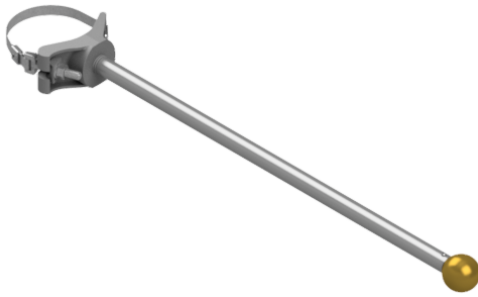

Banner Mounting Bracket, Alum Band Mini-Brac

Banner Width	Band Length/Painted	Finial/Color	Coating
SH-3520 - <input type="text"/>	- <input type="text"/>	- <input type="text"/>	- <input type="text"/>
18=18"	29=29"	BL__=2" Ball	P__=Paint
24=24"	42=42"	ST__=Steeple	
30=30"	29PB=29" Painted	SI__=Spire	
36=36"	42PB=42" Painted	FL__=Fleur	
		SE__=1-1/2" Spear	

Band Length:	29"	42"
Maximum Pole Dia:	7.3"	11.5"

Note:

Finial may be ordered as P28 Gold or same color as assembly, i.e., SH-3520-42PB-24-BL28-P33, for Gold Ball finial and Gloss Black assembly. If painted band is required, band will be painted same color as assembly.

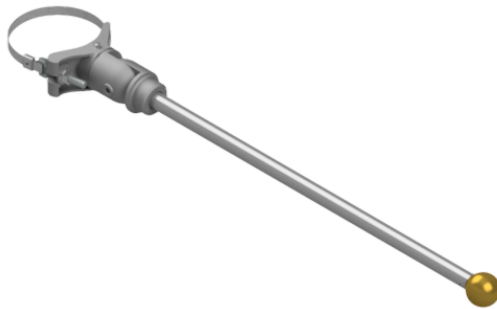

Banner Mounting Bracket, Alum Band Mini-Brac, Articulating Arm

Banner Width	Band Length/Painted	Finial/Color	Coating
SH-3525 - <input type="text"/>	- <input type="text"/>	- <input type="text"/>	- <input type="text"/>
18=18"	29=29"	BL__=2" Ball	P__=Paint
24=24"	42=42"	ST__=Steeple	
30=30"	29PB=29" Painted	SI__=Spire	
36=36"	42PB=42" Painted	FL__=Fleur	
		SE__=1-1/2" Spear	

Band Length:	29"	42"
Maximum Pole Dia:	7.3"	11.5"

Note:

Finial may be ordered as P28 Gold or same color as assembly, i.e., SH-3551-3.50-24-BL28-P33, for Gold Ball finial and Gloss Black assembly. If painted band is required, band will be painted same color as assembly.

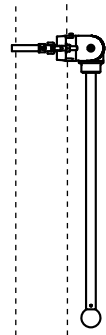

Note: 1. 2 bracket assemblies are required for mounting a banner.
 2. See Reference Section page v for available paint colors.



Banner Brackets

Pelco has a wide variety of mounting bracket for banners and flags. Choose from ornamental hubs, banded mini-bracs, or flat mounted hubs. Banner bracs for square poles are also available, as well as articulating arms for collapsing against the pole when not in use.

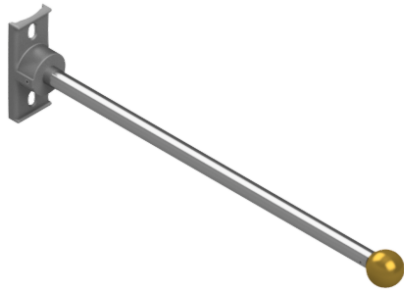

Banner Mounting Bracket, Alum Universal Hub Mount

SH-3523 -	<input type="text"/>	-	<input type="text"/>	-	<input type="text"/>
	18=18"		BL__=2" Ball		P__=Paint
	24=24"		ST__=Steeple		
	30=30"		SI__=Spire		
	36=36"		FL__=Fleur		
			SE__=1-1/2" Spear		



Note:
 Finial may be ordered as P28 Gold or same color as assembly, i.e., SH-3523-24-BL28-P33, for Gold Ball finial and Gloss Black assembly.



Banner Mounting Bracket, Alum For Square Poles, Articulating Arm

SH-3532 -	<input type="text"/>	-	<input type="text"/>	-	<input type="text"/>	-	<input type="text"/>
	4=4" Square		18=18"		BL__=2" Ball		P__=Paint
	5=2-7/8" Square		24=24"		ST__=Steeple		
	6.63=6-5/8" Square		30=30"		SI__=Spire		
			36=36"		FL__=Fleur		
					SE__=1-1/2" Spear		



Note:
 Finial may be ordered as P28 Gold or same color as assembly, i.e., SH-3532-4-24-BL28-P33, for Gold Ball finial and Gloss Black assembly.

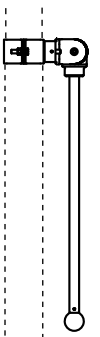

Banner & Flag Mounting Bracket, Alum Hinged Articulating Double Arm

SH-3571 -	<input type="text"/>	-	<input type="text"/>	-	<input type="text"/>	-	<input type="text"/>
	2.38=2-3/8"		18=18"		BL__=2" Ball		P__=Paint
	2.88=2-7/8"		24=24"		ST__=Steeple		
	3.50=3-1/2"		30=30"		SI__=Spire		
	4.06=3" Fluted		36=36"		FL__=Fleur		
	4.50=4-1/2"				SE__=1-1/2" Spear		
	5.08=4" Fluted						
	5.56=5-9/16"						



Note:
 Finial may be ordered as P28 Gold or same color as assembly, i.e., SH-3571-3.50-24-BL28-P33, for Gold Ball finial and Gloss Black assembly.

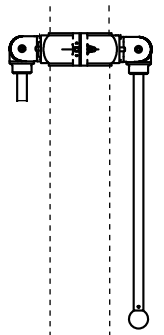

Note: 1. 2 bracket assemblies are required for mounting a banner.
 2. See Reference Section page v for available paint colors.



Flag Mounts

Pelco has a wide variety of mounting bracket for banners and flags. Choose from ornamental hubs, banded mini-bracs, or flat mounted hubs. Banner bracs for square poles are also available, as well as articulating arms for collapsing against the pole when not in use.



Flag Mount, Hinged Articulating Serrated, Alum

SH-3549 - Pole Dia - Coating
 2.88=2-7/8" P__=Paint
 3.50=3-1/2"
 4.06=3" Fluted
 4.50=4-1/2"
 5.08=4" Fluted
 5.56=5-9/16"

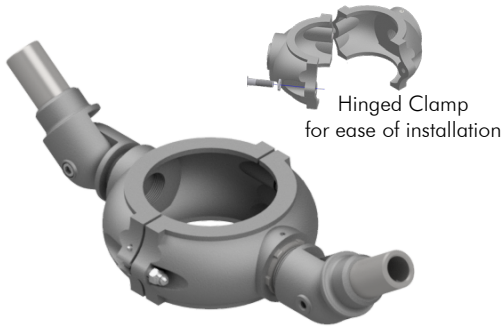

Flag Mount, 2-Way Hinged Articulating Serrated, Alum

SH-3561 - Pole Dia - Coating
 2.88=2-7/8" P__=Paint
 3.50=3-1/2"
 4.06=3" Fluted
 4.50=4-1/2"
 5.08=4" Fluted
 5.56=5-9/16"



Flag Mount, Articulating Serrated, Alum Band Mini-Brac

SH-3539 - BandLength/Painted - Coating
 29=29" P__=Paint
 42=42"
 29PB=29" Painted
 42PB=42" Painted

Band Length:	29"	42"
Maximum Pole Dia:	7.3"	11.5"

Note:
 If painted band is required, band will be painted same color as assembly.

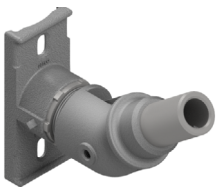

Flag Mount w/ Articulating Serated, Alum Universal Hub

SH-3538 - Coating
 P__=Paint

Note: 1. 2 bracket assemblies are required for mounting a banner.
 2. See Reference Section page v for available paint colors.



Pole Accessories

Pelco has a wide variety of mounting bracket for banners and flags. Choose from ornamental hubs, banded mini-bracs, or flat mounted hubs. Banner bracs for square poles are also available, as well as articulating arms for collapsing against the pole when not in use.



Flag Rod Assy, Alum

Rod Length Finial/Color Coating
 AP-7380 - - -
 42=42" BL__=2" Ball P__=Paint
 52=52" SE__=1-1/2" Spear
 SL__=Spire
 ST__=Steeple
 FL__=Fleur



Note:
 Finial may be ordered as P28 Gold or same color as assembly, i.e., AP-7380-42-ST28-P33, for Gold Ball Steeple finial and Gloss Black assembly.

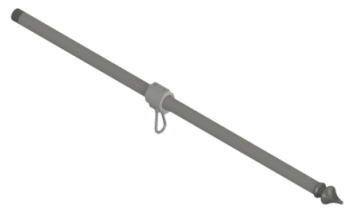

Plant Hanger Rod Assy, Alum

Rod Length Finial/Color Coating
 AP-7386 - - -
 18=18" BL__=2" Ball P__=Paint
 24=24" SE__=1-1/2" Spear
 30=30" SL__=Spire
 ST__=Steeple
 FL__=Fleur



Note:
 Finial may be ordered as P28 Gold or same color as assembly, i.e., AP-7386-18-BL28-P33, for Gold Ball Ball finial and Gloss Black assembly.

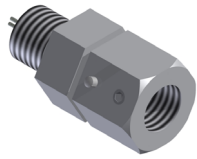

AP-7239 - **Break-a-way Coupler, 1"-8NC, Alum For Banner Bracs**
 Coating
 P__=Paint



AP-5105 - **Mounting Kit, 1" Tube Collar, Alum For Rigid Signs**
 Coating
 P__=Paint



AP-5132 - **Mounting Kit, 1" Tube Collar, Alum For Free-Swinging Signs**
 Coating
 P__=Paint



AP-5110 - **Mounting Kit, 1" Tube Collar, Alum For Plant Hanger**
 Coating
 P__=Paint

Note: 1. See Reference Section page v for available paint colors.



This page is intentionally left blank.

