

Table of Contents

Coatings.....	ii
General Notes	iii
Shipping Notice	iv

Product:

Free-Swinging	1-13
Side-of-Pole.....	15
Post Top	17
Pedestrian Poles.....	19

CODE	COATING
PNC	Process No Color
BRS	Brass
CRM	Chrome
GLV	Galvanized
ZN1	Zinc Bright
ZN2	Zinc Yellow
P_ _	Paint (<i>add color #</i>)

POWDER COAT STANDARD COLORS	
P29	Federal Yellow
P30	Automatic Green (dark)
P32	Clear Coat
P33	Gloss Black
P34	Flat Black
P35	Iron Gray
P36	New York State Green (forest)
P39	Bronze
P40	Silver
P45	Super Wet White
P59	Textured Black
P63	Mocha Brown
P71	Dark Green
P75	Fir Green
P76	Forest Green

Note:

Pelco can match your custom colors.
Please provide the following and contact Pelco for pricing.

- For custom powder: RAL number or paint chip.
- For wet paint: Federal Standard 595 paint code or paint chip.

Special setup and paint charge will apply.



SHIPMENT & DELIVERY

Pelco is very diligent in selecting the most competent and economical carrier. However, Pelco will use the carrier of your choice if indicated on the face of your PO. See Shipping Notice, on page v of this catalog, for shipment specifics and freight claims.

RETURNED GOODS

In order to expedite handling, written authorization must accompany all returned goods. Upon request, a Returned Merchandise Authorization (RMA) will be issued and must be used. Use this RMA as a packing list when returning a shipment. A restocking fee plus freight charges shall be assessed against the return of goods unless return of goods was due to an error of Pelco.

REQUESTS FOR CERTIFICATIONS

Representative material test reports are available on request for most Pelco products. If your order contains materials that require lot or heat treat number traceability, or if the materials must be of domestic origin, those requirements must be clearly stated at the time your order is placed.

GENERAL WARRANTY

All statements, technical information and recommendations contained in Pelco Product Brochures and Bulletins are based on tests Pelco believes to be reliable. However, the accuracy or completeness thereof is not guaranteed and the following is made in lieu of all warranties, expressed or implied:

LIMITED WARRANTY

Pelco's only obligations shall be to replace such quantity of the product proven to be defective. Repair or replacement of any product will be made at Pelco's facilities. The extent of repair or replacement is at Pelco's discretion. Transportation to and from Pelco's facilities is the responsibility of the buyer.

Pelco shall not be liable for injury, loss or damage direct or consequential arising out of the use of, or the inability to use the product. Before using, user shall determine the suitability of the product for his intended use, and assumes all risk and liability whatsoever in connection therewith. No statement or recommendation not contained herein shall have any effect unless in an agreement signed by the officers of Pelco Products Inc.

WARRANTY PERIOD

Unless otherwise noted, standard product warranty is 12 months from date of shipment.

COPY OF SHIPMENT NOTICE INCLUDED WITH EACH SHIPMENT

NOTICE SHIPMENTS MADE WITH FACTORY AS F.O.B. POINT

CARRIER HAS ACCEPTED SHIPMENT IN GOOD CONDITION-
LOST OR DAMAGED GOODS ARE THE CARRIER'S RESPONSIBILITY in all shipments of this type.

PELCO'S Responsibility For This Shipment Has Now Ceased.

CHECK YOUR SHIPMENT CAREFULLY WHEN DELIVERED to see that it is in good order and received complete. When packages check short or are in bad condition, have the Carrier's agent make notation of this fact in detail on the freight bill or express receipt and then require that he sign it.

LOST OR DAMAGED GOODS ARE THE CARRIER'S RESPONSIBILITY in all LTL (less than truckload) shipments. In TL (truckload) shipments, the Carrier is responsible for damage to exposed surfaces of the goods (top and ends) caused by collision with other vehicles or objects when the Carrier is negligent, and by loading other freight on or against Pelco goods. When the trailer itself shows evidence of fresh damage, call at once for inspection of the contents just as though it were an LTL shipment.

CONCEALED LOSS OR DAMAGE DISCOVERED AFTER DELIVERY of shipment must be reported to the delivering Carrier upon discovery, and in any event within 15 days after receipt. Hold goods, containers, and packing materials in exact condition as found for inspection by the Carrier. An inspector for the Carrier should call within 48 hours. If nothing is heard in that time, notify them by registered mail and get a receipt. The Carrier will issue an inspection report and give you a copy which must be used to support your claim.

FAILURE TO COMPLY WITH ANY OF THE FOREGOING REGULATIONS IS REGARDED AS INDICATING COMPLETE DELIVERY OF FREIGHT IN GOOD CONDITION.

Make Your Claim Promptly
Carrier Will Not Consider a Claim Unless Presented Within 9 Months After Receipt of Shipment.

IMPORTANT!

DO NOT DEDUCT THE AMOUNT OF LOSS OR DAMAGE from Pelco invoice while awaiting adjustment of a claim, as we can not guarantee safe delivery for actions beyond our control.

Please do not return goods to Pelco or instruct Carriers to return goods without first securing written authorization and shipping instructions.

SHIPMENTS MADE WITH DESTINATION AS F.O.B. POINT

-CARRIER HAS ACCEPTED SHIPMENT IN GOOD CONDITION-

CHECK YOUR SHIPMENT CAREFULLY WHEN DELIVERED to see that it is in good order and received complete.

When packages check short or are in damaged condition, have the carriers agent make notation of this fact on the freight bill or express receipt, and then require that he sign it.

Check your shipment immediately to make sure the contents agree with the Pelco packing list enclosed and to determine if any damage has occurred during transit.

Any shortages and or concealed damages MUST be reported to Pelco within 10 DAYS.

FAILURE TO COMPLY WITH THE FOREGOING IS REGARDED AS AN INDICATION THAT YOUR SHIPMENT HAS ARRIVED IN SATISFACTORY CONDITION AND THAT IT IS COMPLETE AS SHOWN ON OUR PACKING LIST.

Please do not return damaged goods to Pelco without first securing authorization and shipping instructions.

Pelco will make every effort possible to effect prompt correction of any short or damaged goods when claims are made within these guidelines.



320 W. 18th
Edmond, OK 73013
(405)340-3434 FAX:(405)340-3435





Span Wire Hanger Assy, 1-Way Iron

Coating
SP-1064-NY -
P__=Paint

Note:
Long Cast Nipple SE-0644-ZN2 upgrade available.
Specify by including -LCN in the part number, i.e., SP-1064-NY-LCN-PXX.



Span Wire Hanger Assy, 1-Way w/ Balance Adjuster, Iron

Coating
SP-1011-NY -
P__=Paint

Note:
Long Cast Nipple SE-0644-ZN2 upgrade available.
Specify by including -LCN in the part number, i.e., SP-1011-NY-LCN-PXX.

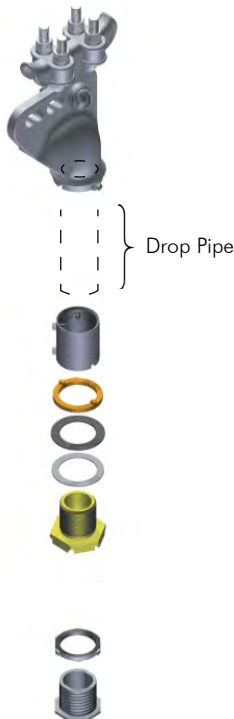

Span Wire Hanger Assy, 1-Way w/ Coupling Assy, Iron

Coating
SP-1038-NY -
P__=Paint

Note:
Long Cast Nipple SE-0644-ZN2 upgrade available.
Specify by including -LCN in the part number, i.e., SP-1038-NY-LCN-PXX.

Notes: Materials, descriptions, and other specifications subject to change without notification. The assemblies listed in this catalog may not meet specification. Check with your local DOT to confirm.





Span Wire Hanger Assy, Iron

SP-1070-NY - Coating
P__=Paint



Span Wire Hanger Assy, Iron Balance Adjuster

SP-1083-NY - Coating
P__=Paint



Span Wire Hanger Assy, Iron Balance Adjuster w/ All Thread

SP-1037-NY - Coating
P__=Paint



Span Wire Hanger Assy, Iron P.A.L. Balance Adjuster w/ All Thread

SP-1093-NY - Coating
P__=Paint

Notes: Materials, descriptions, and other specifications subject to change without notification. The assemblies listed in this catalog may not meet specification. Check with your local DOT to confirm.





Balance Adjuster Assy, Iron 1/2" Slot & Eyebolt

SP-1036-NY - Coating
P__=Paint



Mounting Assy, Steel w/ Coupling

SP-1030-NY - Coating
P__=Paint



Note:
Long Cast Nipple SE-0644-ZN2 upgrade available.
Specify by including -LCN in the part number, i.e., SP-1030-NY-LCN-PXX.

Notes: Materials, descriptions, and other specifications subject to change without notification.
The assemblies listed in this catalog may not meet specification. Check with your local DOT to confirm.



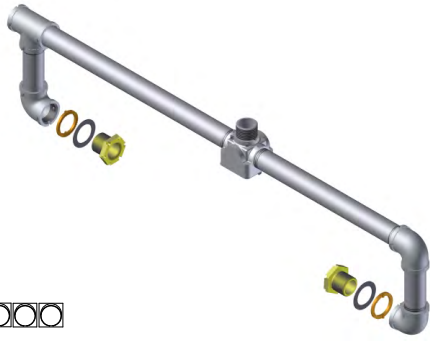

1-Way Span Wire Assy, 3-Sec Signal Double Set Screws, Iron

SP-1041-NY - Coating
P__=Paint

Note:
Long Cast Nipple SE-0644-ZN2 upgrade available.
Specify by including -LCN in the part number, i.e., SP-1041-NY-LCN-PXX.

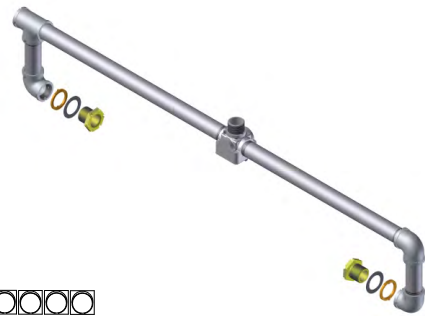

1-Way Span Wire Assy, 4-Sec Signal Double Set Screws, Iron

SP-1051-NY - Coating
P__=Paint

Note:
Long Cast Nipple SE-0644-ZN2 upgrade available.
Specify by including -LCN in the part number, i.e., SP-1051-NY-LCN-PXX.



2-Way Span Wire Assy, 21" CTC Double Set Screws, Iron

SP-2027-NY - Coating
P__=Paint

Note:
Long Cast Nipple SE-0644-ZN2 upgrade available.
Specify by including -LCN in the part number, i.e., SP-2027-NY-LCN-PXX.



3-Way Span Wire Assy, 10-1/2" Radial CTC Double Set Screws, Iron

SP-2028-NY - Coating
P__=Paint

Note:
Long Cast Nipple SE-0644-ZN2 upgrade available.
Specify by including -LCN in the part number, i.e., SP-2028-NY-LCN-PXX.

Notes: Materials, descriptions, and other specifications subject to change without notification.
The assemblies listed in this catalog may not meet specification. Check with you local DOT to confirm.





3-Way Span Wire Assy, 10-1/2" Radial CTC Double Set Screws, Iron

SP-1092-NY - Coating
P__=Paint

Note:
Long Cast Nipple SE-0644-ZN2 upgrade available.
Specify by including -LCN in the part number, i.e., SP-1092-NY-LCN-PXX.



4-Way Span Wire Assy, 21" CTC Double Set Screws, Iron

SP-2029-NY - Coating
P__=Paint

Note:
Long Cast Nipple SE-0644-ZN2 upgrade available.
Specify by including -LCN in the part number, i.e., SP-2029-NY-LCN-PXX.



2-Way Span Wire Assy, 1-Sec & 3-Sec Double Set Screws, Iron

SP-1095-NY - Coating
P__=Paint

Note:
Long Cast Nipple SE-0644-ZN2 upgrade available.
Specify by including -LCN in the part number, i.e., SP-1028-NY-LCN-PXX.



2-Way Span Wire Assy, 3-Sec & 4-Sec Double Set Screws, Iron

SP-1028-NY - Coating
P__=Paint

Note:
Long Cast Nipple SE-0644-ZN2 upgrade available.
Specify by including -LCN in the part number, i.e., SP-1028-NY-LCN-PXX.

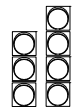

Notes: Materials, descriptions, and other specifications subject to change without notification. The assemblies listed in this catalog may not meet specification. Check with your local DOT to confirm.



Free-Swinging



1-Way Span Wire Assy 5-Sec Cluster, 16-1/2" CTC for 12" & 8" Signals, Iron

SP-1090-NY - Coating
P__=Paint



Note:
Long Cast Nipple SE-0644-ZN2 upgrade available.
Specify by including -LCN in the part number, i.e., SP-1090-NY-LCN-PXX.



1-Way Span Wire Assy 5-Sec Cluster, 16-1/2" CTC, Iron

SP-1002-NY - Coating
P__=Paint



Note:
Long Cast Nipple SE-0644-ZN2 upgrade available.
Specify by including -LCN in the part number, i.e., SP-1002-NY-LCN-PXX.



1-Way Span Wire Assy 5-Sec Cluster, 16-1/2" CTC w/ Pipe Lower, Iron

SP-1046-NY - Coating
P__=Paint



Note:
Long Cast Nipple SE-0644-ZN2 upgrade available.
Specify by including -LCN in the part number, i.e., SP-1046-NY-LCN-PXX.

SP-1043-NY

NEW YORK



Notes: Materials, descriptions, and other specifications subject to change without notification. The assemblies listed in this catalog may not meet specification. Check with your local DOT to confirm.



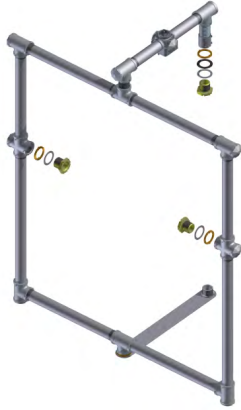

**2-Way Span Wire Assy
3-Sec Straight & 3-Sec Horizontal, Iron**

SP-1057-NY - Coating
P__=Paint

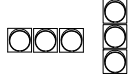

Note:
Long Cast Nipple SE-0644-ZN2 upgrade available.
Specify by including -LCN in the part number, i.e., SP-1057-NY-LCN-PXX.

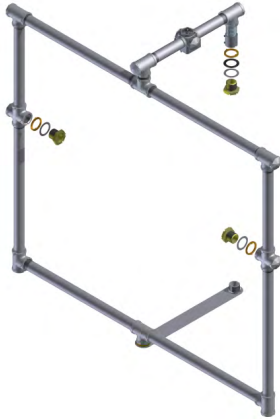

**2-Way Span Wire Assy
3-Sec Straight & 4-Sec Horizontal, Iron**

SP-1074-NY - Coating
P__=Paint



Note:
Long Cast Nipple SE-0644-ZN2 upgrade available.
Specify by including -LCN in the part number, i.e., SP-1074-NY-LCN-PXX.

Notes: Materials, descriptions, and other specifications subject to change without notification.
The assemblies listed in this catalog may not meet specification. Check with your local DOT to confirm.





2-Way Span Wire Assy 3-Sec Straight & 5-Sec Cluster, Iron

SP-1016-NY - Coating
P__=Paint

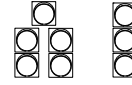

Note:
Long Cast Nipple SE-0644-ZN2 upgrade available.
Specify by including -LCN in the part number, i.e., SP-1016-NY-LCN-PXX.



2-Way Span Wire Assy 3-Sec Straight & 5-Sec Cluster w/ Pipe Lower, Iron

SP-1047-NY - Coating
P__=Paint

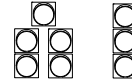

Note:
Long Cast Nipple SE-0644-ZN2 upgrade available.
Specify by including -LCN in the part number, i.e., SP-1047-NY-LCN-PXX.



2-Way Span Wire Assy 5-Sec Cluster w/ Pipe Lower, Iron

SP-1049-NY - Coating
P__=Paint

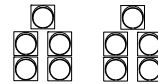

Note:
Long Cast Nipple SE-0644-ZN2 upgrade available.
Specify by including -LCN in the part number, i.e., SP-1049-NY-LCN-PXX.

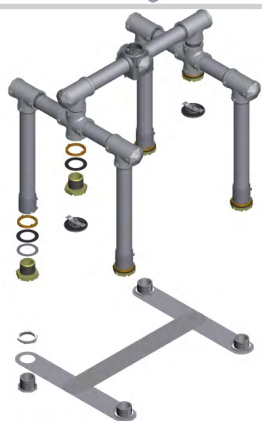

2-Way Span Wire Assy 5-Sec Clusters, Iron

SP-1020-NY - Coating
P__=Paint

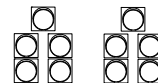

Note:
Long Cast Nipple SE-0644-ZN2 upgrade available.
Specify by including -LCN in the part number, i.e., SP-1020-NY-LCN-PXX.

Notes: Materials, descriptions, and other specifications subject to change without notification.
The assemblies listed in this catalog may not meet specification. Check with you local DOT to confirm.





2-Way Span Wire Assy 5-Sec Cluster, Iron

SP-1023-NY - Coating
P__=Paint

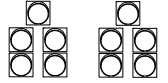

Note:
Long Cast Nipple SE-0644-ZN2 upgrade available.
Specify by including -LCN in the part number, i.e., SP-1023-NY-LCN-PXX.



2-Way Span Wire Assy 2-Sec & 3-Sec Straight Unbalanced, Iron

SP-1094-NY - Coating
P__=Paint

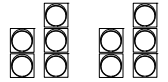

Note:
Long Cast Nipple SE-0644-ZN2 upgrade available.
Specify by including -LCN in the part number, i.e., SP-1094-NY-LCN-PXX.

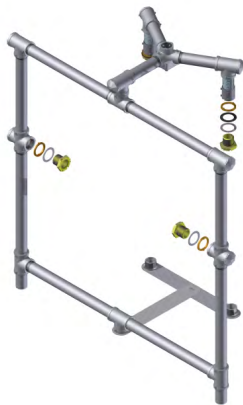

3-Way Span Wire Assy 3-Sec Straight & 3-Sec Horizontal, Iron

SP-1081-NY - Coating
P__=Paint

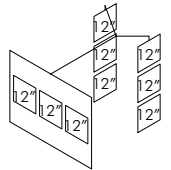

Note:
Long Cast Nipple SE-0644-ZN2 upgrade available.
Specify by including -LCN in the part number, i.e., SP-1081-NY-LCN-PXX.

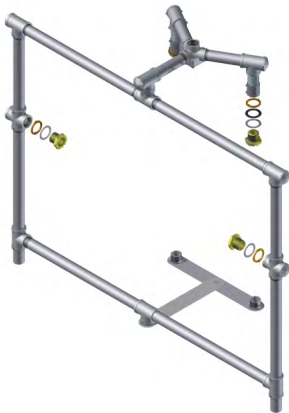

3-Way Span Wire Assy 3-Sec Straight & 4-Sec Horizontal, Iron

SP-1053-NY - Coating
P__=Paint

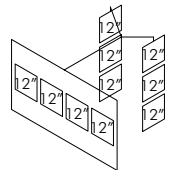

Note:
Long Cast Nipple SE-0644-ZN2 upgrade available.
Specify by including -LCN in the part number, i.e., SP-1053-NY-LCN-PXX.

Notes: Materials, descriptions, and other specifications subject to change without notification.
The assemblies listed in this catalog may not meet specification. Check with you local DOT to confirm.





3-Way Span Wire Assy 3-Sec Straight & 5-Sec Cluster, Iron

SP-1017-NY - Coating
P__=Paint

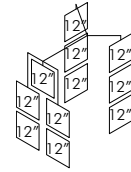

Note:
Long Cast Nipple SE-0644-ZN2 upgrade available.
Specify by including -LCN in the part number, i.e., SP-1017-NY-LCN-PXX.



3-Way Span Wire Assy 3-Sec Straight & 5-Sec Cluster w/ Pipe Lower, Iron

SP-1075-NY - Coating
P__=Paint

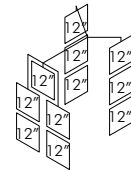

Note:
Long Cast Nipple SE-0644-ZN2 upgrade available.
Specify by including -LCN in the part number, i.e., SP-1075-NY-LCN-PXX.



3-Way Straight Span Wire Assy, Tri-Stud 3-Sec Straight & 5-Sec Cluster, Iron

SP-1061-NY - Coating
P__=Paint

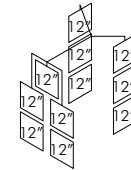

Note:
Long Cast Nipple SE-0644-ZN2 upgrade available.
Specify by including -LCN in the part number, i.e., SP-1061-NY-LCN-PXX.



3-Way Span Wire Assy 3-Sec Straight & 5-Sec Cluster, Iron

SP-1024-NY - Coating
P__=Paint

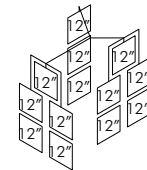

Note:
Long Cast Nipple SE-0644-ZN2 upgrade available.
Specify by including -LCN in the part number, i.e., SP-1024-NY-LCN-PXX.

Notes: Materials, descriptions, and other specifications subject to change without notification.
The assemblies listed in this catalog may not meet specification. Check with you local DOT to confirm.





3-Way Span Wire Assy 3-Sec Straight & 5-Sec Cluster, Iron

SP-1021-NY - Coating
P__=Paint

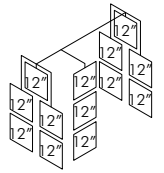

Note:
Long Cast Nipple SE-0644-ZN2 upgrade available.
Specify by including -LCN in the part number, i.e., SP-1021-NY-LCN-PXX.



4-Way Span Wire Assy 3-Sec Straight & 3-Sec Horizontal, Iron

SP-1058-NY - Coating
P__=Paint

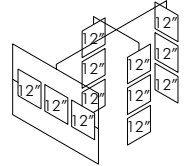

Note:
Long Cast Nipple SE-0644-ZN2 upgrade available.
Specify by including -LCN in the part number, i.e., SP-1058-NY-LCN-PXX.



4-Way Span Wire Assy 3-Sec Straight for 8" Signal & 5-Sec Cluster for 12" Signal, Iron

SP-1029-NY - Coating
P__=Paint

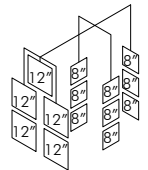

Note:
Long Cast Nipple SE-0644-ZN2 upgrade available.
Specify by including -LCN in the part number, i.e., SP-1029-NY-LCN-PXX.



4-Way Span Wire Assy 3-Sec Straight for 8" Signal & 5-Sec Cluster for 12" Signal, Pipe Lower, Iron

SP-1076-NY - Coating
P__=Paint

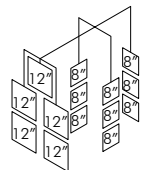

Note:
Long Cast Nipple SE-0644-ZN2 upgrade available.
Specify by including -LCN in the part number, i.e., SP-1076-NY-LCN-PXX.

Notes: Materials, descriptions, and other specifications subject to change without notification.
The assemblies listed in this catalog may not meet specification. Check with you local DOT to confirm.





2-Way Span Wire Assy 16-1/2" CTC w/ NPS & NPT Threads, Iron

SP-1032-NY - Coating
P__=Paint

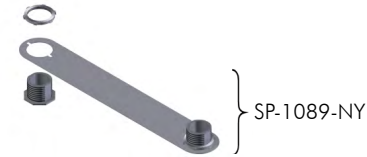

Note:
Long Cast Nipple SE-0644-ZN2 upgrade available.
Specify by including -LCN in the part number, i.e., SP-1032-NY-LCN-PXX.



3-Way Span Wire Assy, 18-1/2" Radial CTC w/ NPS & NPT Threads, Iron

SP-1033-NY - Coating
P__=Paint

Note:
Long Cast Nipple SE-0644-ZN2 upgrade available.
Specify by including -LCN in the part number, i.e., SP-1033-NY-LCN-PXX.



4-Way Span Wire Assy 16-1/2" CTC w/ NPS & NPT Threads, Iron

SP-1034-NY - Coating
P__=Paint

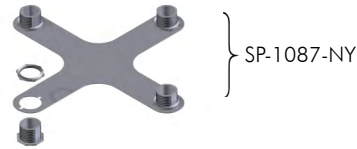

Note:
Long Cast Nipple SE-0644-ZN2 upgrade available.
Specify by including -LCN in the part number, i.e., SP-1034-NY-LCN-PXX.



2-Way Span Wire Assy 16-1/2" CTC w/ NPS & NPT Threads Pipe Lower, Iron

SP-1048-NY - Coating
P__=Paint

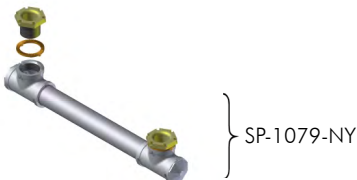

Note:
Long Cast Nipple SE-0644-ZN2 upgrade available.
Specify by including -LCN in the part number, i.e., SP-1048-NY-LCN-PXX.

Notes: Materials, descriptions, and other specifications subject to change without notification. The assemblies listed in this catalog may not meet specification. Check with you local DOT to confirm.



Disconnect Hanger



**18 Circuit w/ 1-1/2" NPS Top & Bottom Hub,
1" NPT Ends, w/ 7' Wiring Harness, Alum**

SP-1042-NY - Coating
P__=Paint



**18 Circuit w/ 1-1/2" NPS Top & Bottom Hub,
1" NPT Ends, Alum**

SP-1082-NY - Coating
P__=Paint

NEW YORK

pelco
PELCO PRODUCTS, INC.

Notes: Materials, descriptions, and other specifications subject to change without notification. The assemblies listed in this catalog may not meet specification. Check with you local DOT to confirm.



This page is intentionally left blank.

NEW YORK





1-Way Side of Pole Assy w/ Universal Hubs, Iron

SP-1069-NY - ^{Coating}
P__=Paint

Note:
Long Cast Nipple SE-0644-ZN2 upgrade available.
Specify by including -LCN in the part number, i.e., SP-1013-NY-LCN-PXX.



1-Way Side of Pole Assy w/ Large Pole Hub, Iron

SP-1040-NY - ^{Nipple Length} - ^{Coating}
P__=Paint
10=10"



US-8124-06 Band
(order separately)

Notes:
1. 16' (4.88M) of US-8124-06 band is required per each assembly. Order separately.
2. Long Cast Nipple SE-0644-ZN2 upgrade available.
Specify by including -LCN in the part number, i.e., SP-1040-NY-10-LCN-PXX.



1-Way Side of Pole Assy w/ Extended Hubs, Iron

SP-1012-NY - ^{Nipple Length} - ^{Coating}
P__=Paint
10=10"



US-8124-06 Band
(order separately)

Notes:
1. 16' (4.88M) of US-8124-06 band is required per each assembly. Order separately.
2. Long Cast Nipple SE-0644-ZN2 upgrade available.
Specify by including -LCN in the part number, i.e., SP-1012-NY-10-LCN-PXX.



1-Way Upper Side of Pole w/ Extended Hub, Iron

SP-1013-NY - ^{Coating}
P__=Paint

Note:
Long Cast Nipple SE-0644-ZN2 upgrade available.
Specify by including -LCN in the part number, i.e., SP-1013-NY-LCN-PXX.



Notes: Materials, descriptions, and other specifications subject to change without notification.
The assemblies listed in this catalog may not meet specification. Check with your local DOT to confirm.



This page is intentionally left blank.

NEW YORK

pelco
PELCO PRODUCTS, INC.





1-Way Span Wire Slip Fitter Assy, Iron

SP-1084-NY - Coating
 P__=Paint

Note:
 Long Cast Nipple SE-0644-ZN2 upgrade available.
 Specify by including -LCN in the part number, i.e., SP-1084-NY-LCN-PXX.



1-Way Post Top Assy w/ 34" Support Tube 2-Sec for Ped Signals, Iron

SP-3023-NY - Coating
 P__=Paint

Note:
 Long Cast Nipple SE-0644-ZN2 upgrade available.
 Specify by including -LCN in the part number, i.e., SP-3023-NY-LCN-PXX.



2-Way Post Top Assy 16-1/2" CTC, Iron

SP-1085-NY - Coating
 Signal Section P__=Paint
 3=3-Sec
 4=4-Sec
 5=5-Sec

Note:
 Long Cast Nipple SE-0644-ZN2 upgrade available.
 Specify by including -LCN in the part number, i.e., SP-1085-NY-LCN-PXX.



2-Way Post Top Assy, w/ 30" Support Tube 16-1/2" CTC, Iron

SP-1035-NY - Coating
 P__=Paint

Note:
 Long Cast Nipple SE-0644-ZN2 upgrade available.
 Specify by including -LCN in the part number, i.e., SP-1035-NY-LCN-PXX.

Notes: Materials, descriptions, and other specifications subject to change without notification. The assemblies listed in this catalog may not meet specification. Check with you local DOT to confirm.



This page is intentionally left blank.

NEW YORK

pelco
PELCO PRODUCTS, INC.





**Ped Pole Assy, 4" Sch 40
w/ Hand Hole & Steel Base, Alum**

SP-2026-NY - Length - Coating
 5=5'-0" P__=Paint
 10=10'-0"



**Pole Assy, 4" Sch 40 x 8'
w/ Steel Flange Base & Round Cover
Alum**

SP-3021-NY - Coating
 P__=Paint



**Pole Assy, 4" Sch 40 x 12'
w/ Steel Flange Base, Round Cover & Cap,
Alum**

SP-3022-NY - Coating
 P__=Paint

Notes: Materials, descriptions, and other specifications subject to change without notification. The assemblies listed in this catalog may not meet specification. Check with you local DOT to confirm.

