

Part Number System	ii
Coatings.....	iii
Shipping Notice	iv
Terms & Conditions.....	v
Warranty	vi

Product:

Span Wire	1-2
Plumbizers	3-5
Side-of-Pole.....	7
Post Top	9
Terminal Compartments, Post Top.....	11-22
Terminal Compartments, Side-of-Pole	23-39
Components.....	41-44



Terminal Compartment Assy, Post Top 1-Way 12" Signals, Bronze

Signal Section	Orientation	Wiring	Door	Coating
SP-8022 - 3	- LH	- WH	-	- P30
3=3 Section, 34" Tube	RH=Right Hand LH=Left Hand	Blank =None WH=Wiring Harness	Blank=Plastic AD=Aluminum	P__=Paint
4=4 Section, 47.5" Tube				

Part Number
SP-8022-3-LH-WH-P30

Terminal Compartment Assy, Post Top Left Hand, 1-Way 3-Sec 12" Signals w/ Wiring, Bronze, Automatic Green

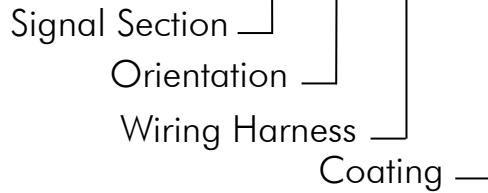

- LH=Left Hand (left of door); RH=Right Hand (right of door)
- WH=Wiring Harness (wires are attached to terminal block, pulled through the lower arms, and coiled in the serrated ells)

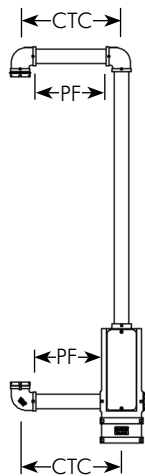

- PF = Measured distance from pipe fitting to pipe fitting
- CTC = Measured center to center distance of signals or fittings

Note: All information is assumed to be correct at the time of printing.

CODE	COATING
PNC	Process No Color
BOX	Black Oxide
BRS	Brass
CRM	Chrome
EC1	E-coat Black
GLV	Galvanized
ZN1	Zinc Bright
ZN2	Zinc Yellow
P_ _	Paint (add color #)

POWDER COAT STANDARD COLORS	
P29	Federal Yellow
P30	Automatic Green
P33	Gloss Black
P34	Flat Black
P36	New York State Green (forest)
P38	Louisiana Green
P39	Bronze
P40	Silver
P59	Textured Black
P67	Ansi Gray

WET PAINT STANDARD COLORS	
P01	Federal Yellow
P02	Semi-Gloss Black
P03	Flat Black
P04	Gloss Black
P05	New York State Green (forest)
P06	Automatic Green (dark olive)
P16	Industrial Red Primer
P22	Gloss White (industrial enamel)

POWDER COAT SPECIAL COLORS	
(SUBJECT TO SPECIAL SETUP CHARGE)	
P28	Sun Gold (w/ clear top coat)
P32	Clear Coat
P35	Iron Gray
P44	Antique Black Matte
P45	Super Wet White
P46	Brown Rust
P47	Brown Base
P48	Gray Primer (zinc rich)
P49	Cratered Pewter
P51	Cratered Bronze
P61	Blood Red
P62	MDC Gray
P63	Mocha Brown
P64	KOMO Bronze
P69	Brushing Brown
P71	Dark Green
P74	Bottle Green
P75	Fir Green
P76	Forest Green
P79	Dark Sepia Brown

Note:

Pelco can match your custom colors.

Please provide the following and contact Pelco for pricing.

- For custom powder: RAL number or paint chip.
- For wet paint: Federal Standard 595 paint code or paint chip.

Special setup and paint charge will apply.



PAYMENT TERMS

Net 30 Days.

A 1 1/2% per month (18% APR Service Charge) will be assessed on invoices whose payment has not been received within 45 days.

CREDIT CARD TERMS

We accept American Express, Mastercard, Visa, and Discover. A service fee of 3% will be added to all invoices. Credit Card will be charged prior to shipment.

CREDIT HOLD

Accounts over 90 Days will be placed on credit hold and remain so until brought current including Service Charges. Orders on credit hold will be pulled from production and will only be rescheduled for shipment after release from credit hold.

MINIMUM BILLING

A \$20.00 Minimum Service Charge will be assessed to each order for \$50.00 or less.

F.O.B. POINT

Edmond, Oklahoma unless otherwise quoted.

PRICING

As stated in Price Schedule, prices are subject to change without notice.

QUOTATIONS

Pricing on quotations is firm for 30 days from date of quotation unless otherwise indicated. Please reference quotation when ordering.

CANCELLATIONS

Orders cancelled for stock items will be assessed at a minimum of 10% of net value.

Orders cancelled for special or non-stock items will be assessed at a minimum of 20% of net value.

CUSTOMER PICK UP

Customer pick up requests will be accommodated. A 10% service charge will apply if not picked up within 30 days of notification of completion of order.

SHIPMENT & DELIVERY

Pelco is very diligent in selecting the most competent and economical carrier. However, upon written request Pelco will use a carrier of your specific choice. See Shipping Notice, in the Reference Section of this catalog, for shipment specifics and freight claims.

RETURNED GOODS

In order to expedite handling, written authorization must accompany all returned goods. Upon request, a Returned Merchandise Authorization (RMA) will be issued and must be used. Use this RMA as a packing list when returning a shipment. A restocking fee plus freight charges shall be assessed against the return of goods unless return of goods was due to an error of Pelco.

REQUESTS FOR CERTIFICATIONS

Representative material test reports are available on request for most Pelco products. If your order contains materials that require lot or heat treat number traceability, or if the materials must be of domestic origin, those requirements must be clearly stated at the time your order is placed.



COPY OF SHIPMENT NOTICE INCLUDED WITH EACH SHIPMENT

NOTICE SHIPMENTS MADE WITH FACTORY AS F.O.B. POINT

CARRIER HAS ACCEPTED SHIPMENT IN GOOD CONDITION-
LOST OR DAMAGED GOODS ARE THE CARRIER'S RESPONSIBILITY in all shipments of this type.

PELCO'S Responsibility For This Shipment Has Now Ceased.

CHECK YOUR SHIPMENT CAREFULLY WHEN DELIVERED to see that it is in good order and received complete. When packages check short or are in bad condition, have the Carrier's agent make notation of this fact in detail on the freight bill or express receipt and then require that he sign it.

LOST OR DAMAGED GOODS ARE THE CARRIER'S RESPONSIBILITY in all LTL (less than truckload) shipments. In TL (truckload) shipments, the Carrier is responsible for damage to exposed surfaces of the goods (top and ends) caused by collision with other vehicles or objects when the Carrier is negligent, and by loading other freight on or against Pelco goods. When the trailer itself shows evidence of fresh damage, call at once for inspection of the contents just as though it were an LTL shipment.

CONCEALED LOSS OR DAMAGE DISCOVERED AFTER DELIVERY of shipment must be reported to the delivering Carrier upon discovery, and in any event within 15 days after receipt. Hold goods, containers, and packing materials in exact condition as found for inspection by the Carrier. An inspector for the Carrier should call within 48 hours. If nothing is heard in that time, notify them by registered mail and get a receipt. The Carrier will issue an inspection report and give you a copy which must be used to support your claim.

FAILURE TO COMPLY WITH ANY OF THE FOREGOING REGULATIONS IS REGARDED AS INDICATING COMPLETE DELIVERY OF FREIGHT IN GOOD CONDITION.

Make Your Claim Promptly
Carrier Will Not Consider a Claim Unless Presented Within 9 Months After Receipt of Shipment.

IMPORTANT!

DO NOT DEDUCT THE AMOUNT OF LOSS OR DAMAGE from Pelco invoice while awaiting adjustment of a claim, as we can not guarantee safe delivery for actions beyond our control.

Please do not return goods to Pelco or instruct Carriers to return goods without first securing written authorization and shipping instructions.

SHIPMENTS MADE WITH DESTINATION AS F.O.B. POINT

-CARRIER HAS ACCEPTED SHIPMENT IN GOOD CONDITION-

CHECK YOUR SHIPMENT CAREFULLY WHEN DELIVERED to see that it is in good order and received complete.

When packages check short or are in damaged condition, have the carriers agent make notation of this fact on the freight bill or express receipt, and then require that he sign it.

Check your shipment immediately to make sure the contents agree with the Pelco packing list enclosed and to determine if any damage has occurred during transit.

Any shortages and or concealed damages MUST be reported to Pelco within 10 DAYS.

FAILURE TO COMPLY WITH THE FOREGOING IS REGARDED AS AN INDICATION THAT YOUR SHIPMENT HAS ARRIVED IN SATISFACTORY CONDITION AND THAT IT IS COMPLETE AS SHOWN ON OUR PACKING LIST.

Please do not return damaged goods to Pelco without first securing authorization and shipping instructions.

Pelco will make every effort possible to effect prompt correction of any short or damaged goods when claims are made within these guidelines.



320 W. 18th
Edmond, OK 73013
(405)340-3434 FAX:(405)340-3435



WARRANTY

General:

All statements, technical information and recommendations contained in Pelco Product Brochures and Bulletins are based on tests Pelco believes to be reliable. However, the accuracy or completeness thereof is not guaranteed and the following is made in lieu of all warranties, expressed or implied:

Limited Warranty:

Pelco's only obligations shall be to replace such quantity of the product proven to be defective.

Repair or replacement of any product will be made at Pelco's facilities. The extent of repair or replacement is at Pelco's discretion. Transportation to and from Pelco's facilities is the responsibility of the buyer.

Pelco shall not be liable for injury, loss or damage direct or consequential arising out of the use of, or the inability to use the product. Before using, user shall determine the suitability of the product for his intended use, and assumes all risk and liability whatsoever in connection therewith. No statement or recommendation not contained herein shall have any effect unless in an agreement signed by the officers of Pelco Products Inc.

Warranty Period:

Unless otherwise noted, standard product warranty is 12 months from date of shipment.



Span Wire Assy, 1-1/2" NPS Wire Entrance, Steel Nipple, Bronze

Nipple Length Coating
 SP-8010 - -
 06.75=6-3/4" P_ =Paint

Note: Includes bronze clamp and wire outlet body with steel nipple and aluminum octagonal closure cap.



Span Wire Assy, 1-1/2" NPS Wire Entrance, Steel Nipple, Alum Tether, Bronze

Nipple Length Coating
 SP-8011 - -
 06.75=6-3/4" P_ =Paint

Note: Includes bronze clamp and wire outlet body with steel nipple and aluminum tri-stud hanger.



Span Wire Assy, 1-1/2" NPS Wire Entrance, Steel Nipple, Alum Tri-Stud Adapter, Bronze

Nipple Length Coating
 SP-8012 - -
 06.75=6-3/4" P_ =Paint

Note: Includes bronze clamp and wire outlet body with steel nipple, aluminum tri-stud hanger and octagonal closure cap.

Note: 1. All assemblies supplied standard with stainless steel slotted washers and fasteners.
 2. See Reference Section for available paint colors.



Span Wire Assy, 1-1/2" NPS Male Wire Entrance, 5/8" Wide, Insulator Bushing, Bronze

SP-8034 - Coating
 P__=Paint

Note: Includes bronze wire outlet body, insulator bushing, and steel check nuts.



Span Wire Assy, 1-1/2" NPS Wire Entrance, Alum Nipple, Alum

SP-5929 - Nipple Length - Coating
 03=3" P__=Paint
 04=4"

Note: Includes aluminum clamp and wire outlet body with aluminum nipple and octogonal closure cap.

Note: 1. All assemblies supplied standard with stainless steel fasteners.
 2. See Reference Section for available paint colors.





Plumbizer Assy, Elbow Iron Hex Nipple & Alum Octagonal Cap, Bronze

ADOT TS 9-1 Type 1
Caltrans MAT

SP-8000 -
Coating
P__=Paint

Note: Includes bronze elbow, iron hex nipple, and aluminum octagonal closure cap.



Plumbizer Assy, Elbow Steel Nipple, for Signs, Bronze

SP-8001 - -
Nipple Length Coating
06.75=6-3/4" P__=Paint

Note: Includes bronze elbow, steel nipple, and steel conduit locknut.



Plumbizer Assy, Steel Nipple, Conduit Locknuts, Bronze

SP-8002 - -
Nipple Length Coating
06.75=6-3/4" P__=Paint

Note: Includes bronze elbow, steel nipple, steel check nuts, and aluminum octagonal closure cap.

Note: 1. All assemblies supplied standard with stainless steel fasteners.
2. See Reference Section for available paint colors.





Plumbizer Assy, Elbow Steel Nipple, Tri-Stud Adapter, Alum Octagonal Cap, Bronze

SP-8003 - -
 Nipple Length Coating
 06.75=6-3/4" P_=_Paint

Note: Includes bronze elbow, steel nipple, aluminum tri-stud adapter, and aluminum octagonal cap.

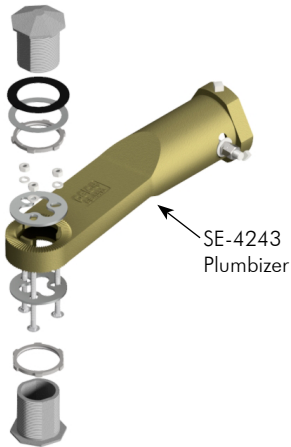

Plumbizer Assy, Elevator Mount 1-Way w/ Alum Octagonal Caps, Hdwr Kit, Bronze ADOT TS 9-1 Type II

SP-8055 -
 Coating
 P_=_Paint

Note: Includes bronze plumbizer, aluminum octagonal caps, and hardware kit.

Note: 1. All assemblies supplied standard with stainless steel slotted washers and fasteners.
 2. See Reference Section for available paint colors.





**Plumbizer Assy, Elevator Mount, 5-Sec Cluster
Alum Tri-Stud, 17" CTC, Bronze**

Caltrans MAS-5A

SP-8005 - Coating
P_ _=Paint



Note: Includes bronze plumbizer, aluminum tri-stud arm, steel spreader, and aluminum octagonal caps.

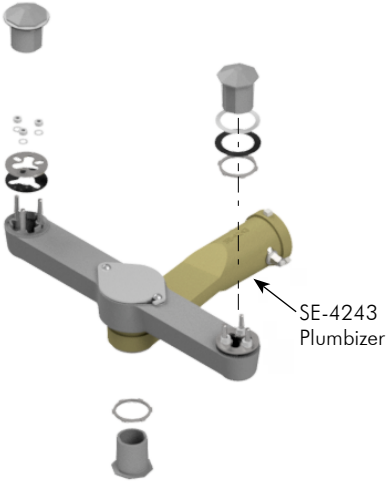

**Plumbizer Assy, Elevator Mount, Hawk
Alum Tri-Stud, 17" CTC, Bronze**

SP-8006 - Coating
P_ _=Paint



Note: Includes bronze plumbizer, aluminum tri-stud arm, and aluminum octagonal caps.

Note: 1. All assemblies supplied standard with stainless steel slotted washers and fasteners.
2. See Reference Section for available paint colors.



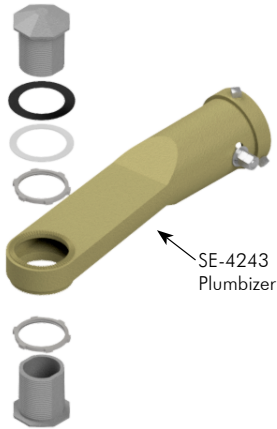

Plumbizer Assy, Offset Elevator Mount, Large Hole 1-Way w/ Alum Octagonal Caps, Bronze

SP-8066 - Coating
P__=Paint

Note: Includes bronze plumbizer and aluminum octagonal caps.

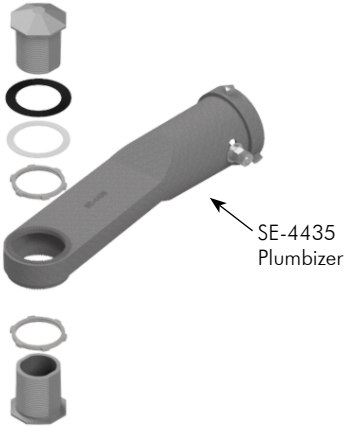

Plumbizer Assy, Offset Elevator Mount, Large Hole 1-Way w/ Alum Octagonal Caps, Iron

SP-8304 - Coating
P__=Paint

Note: Includes iron plumbizer and aluminum octagonal caps.

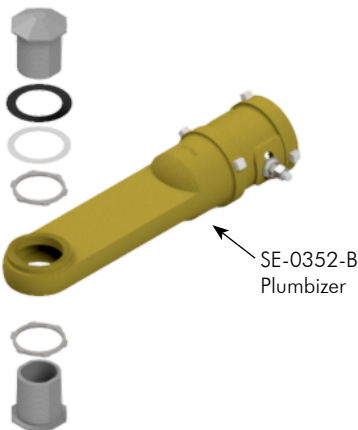

Plumbizer Assy, Straight Elevator Mount, 1-Way w/ Alum Octagonal Caps, Copper Alloy

SP-8007 - Coating
P__=Paint

Note: Includes bronze plumbizer and aluminum octagonal caps.

Note: 1. All assemblies supplied standard with stainless steel fasteners.
2. See Reference Section for available paint colors.





Side-of-Pole Assy, 1-Way for Ped Signal Steel Nipples, Bronze

Caltrans SP-1

	Nipple Length	-	Coating
SP-8009	- <input type="text"/>	-	<input type="text"/>
	08=8"		P__=Paint
	12.5=12-1/2"		



Note: Includes bronze hub plates, steel nipples, and iron serrated ells.



Side-of-Pole Assy, 2-Way for Traffic Signal, Pedestrian Signal, or Illuminated Message, Steel Nipples, Bronze

ADOT TS 9-9 Type XI

	Nipple Length	-	Coating
SP-8041	- <input type="text"/>	-	<input type="text"/>
	06=6" (traffic signal)		P__=Paint
	12=12" (sign or ped signal)		
	16=16" (programmed signal)		



SIGN

Note: Includes bronze hub plates with mounting hardware, steel nipples, and iron serrated ells.

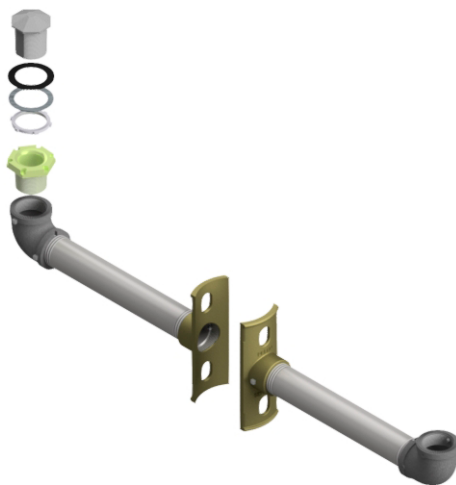

Side-of-Pole Assy, 2-Way for 1-Sec 8" Signal & Solar Panel Steel Nipples, Bronze

	Nipple Length	-	Coating
SP-8013	- <input type="text"/>	-	<input type="text"/>
	12.5=12-1/2"		P__=Paint



Note: Includes bronze hub plates, steel nipples, and iron serrated ells.

Note: 1. All assemblies supplied standard with stainless steel fasteners.
2. See Reference Section for available paint colors.



This page is intentionally left blank.

WEST COAST

pelco
PELCO PRODUCTS, INC.



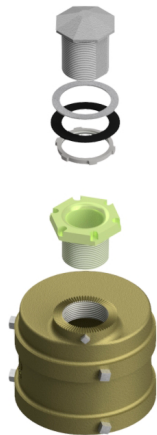

Post Top Assy, 1-Way Offset Beacon Mount, Bronze

ADOT TS 9-2 Type III
Caltrans TP-1-T

SP-8037 - Coating
P__=Paint



Note: Includes bronze slip fitter, iron hex nipple, and aluminum octagonal cap.

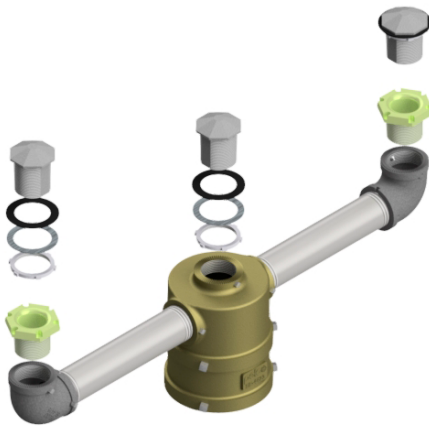

Post Top Assy, 2-Way Beacon Mount, 26" CTC, Bronze

SP-8027 - Coating
P__=Paint



Note: Includes bronze slip fitter, steel nipples, iron serrated ells, and aluminum octagonal caps.



Post Top Assy, 2-Way for 12" Signals & Solar Panel, 26" CTC, Bronze

SP-8028 - - Signal Section Coating
1=15" Tube P__=Paint

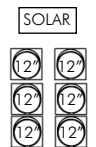

Note: Includes bronze slip fitter, steel nipples, iron serrated ells, and aluminum octagonal caps.

Note: 1. All assemblies supplied standard with stainless steel fasteners.
2. See Reference Section for available paint colors.

This page is intentionally left blank.

WEST COAST

pelco
PELCO PRODUCTS, INC.



Terminal Compartments, Post Top

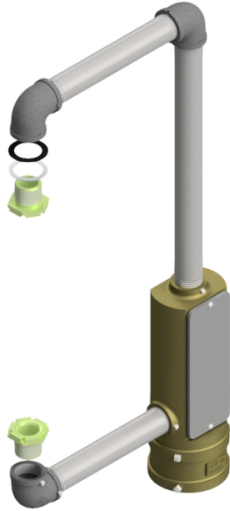

Terminal Compartment Assy, Post Top 1-Way 8" Signals, 15" CTC, Bronze

ADOT TS 9-2 Type IV

Signal Section	Orientation	Wiring	Coating
SP-8042 - <input type="text"/>	- <input type="text"/>	- <input type="text"/>	<input type="text"/>
3 =24" Tube	RH=Right Hand LH=Left Hand	Blank =None WH=Wiring Harness	P__=Paint

Note: Left hand shown, right hand opposite.
Includes steel nipples, iron ells, 12-circuit terminal block, and bronze terminal compartment. Aluminum door standard.

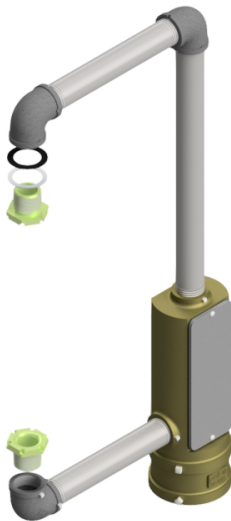

Terminal Compartment Assy, Post Top 1-Way 12" Signal, 15" CTC, Bronze

ADOT TS 9-2 Type IV

Signal Section	Orientation	Wiring	Coating
SP-8043 - <input type="text"/>	- <input type="text"/>	- <input type="text"/>	<input type="text"/>
2=21" Tube 3 =34.5" Tube 4=48" Tube 5=61.5" Tube	RH=Right Hand LH=Left Hand	Blank =None WH=Wiring Harness	P__=Paint

Note: Left hand shown, right hand opposite.
Includes steel nipples, iron ells, 12-circuit terminal block, and bronze terminal compartment. Aluminum door standard.



Note: 1. All assemblies supplied standard with stainless steel fasteners.
2. See Reference Section for available paint colors.



Terminal Compartments, Post Top



Terminal Compartment Assy, Post Top 2-Way 8" Signal, 30" CTC, Bronze

ADOT TS 9-4 Type VI

SP-8049 -

Signal Section	-	Wiring	-	Coating
<input type="text"/>	-	<input type="text"/>	-	<input type="text"/>
3 =24" Tube		Blank =None WH=Wiring Harness		P_ =Paint



Note: Includes steel nipples, iron ells, 12-circuit terminal block, and bronze terminal compartment. Aluminum door standard.



Terminal Compartment Assy, Post Top 2-Way 12" Signal, 30" CTC, Bronze

ADOT TS 9-4 Type VI

SP-8048 -

Signal Section	-	Wiring	-	Coating
<input type="text"/>	-	<input type="text"/>	-	<input type="text"/>
2=21" Tube 3 =34.5" Tube 4=48" Tube 5=61.5" Tube		Blank =None WH=Wiring Harness		P_ =Paint



Note: Includes steel nipples, iron ells, 12-circuit terminal block, and bronze terminal compartment. Aluminum door standard.

Note: 1. All assemblies supplied standard with stainless steel fasteners.
2. See Reference Section for available paint colors.



Terminal Compartments, Post Top

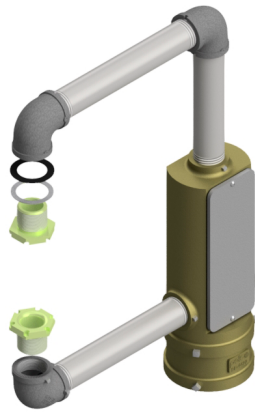

Terminal Compartment Assy, Post Top, 1-Way for Pedestrian Signal or Illuminated Message, 15" CTC, Bronze

ADOT TS 9-2 Type IV

Tube	Orientation	Wiring	Coating
SP-8044 - <input type="text"/>	- <input type="text"/>	- <input type="text"/>	- <input type="text"/>
Blank=9.5" (ped signal) IM= 23.63" (Illum Msg Sign)	RH=Right Hand LH=Left Hand	Blank =None WH=Wiring Harness Ped Only)	P_ _=Paint



Note: Left hand shown, right hand opposite.
Includes steel nipples, iron ells, 12-circuit terminal block, and bronze terminal compartment. Aluminum door standard.

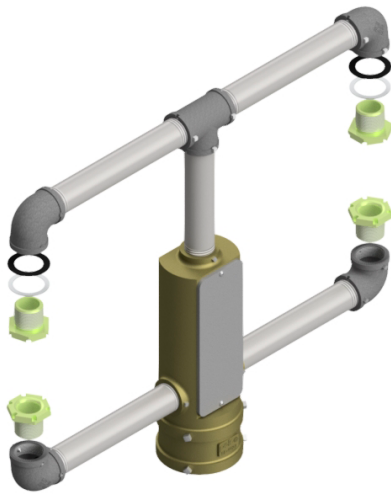

Terminal Compartment Assy, Post Top 2-Way Pedestrian Signal, 30" CTC, Bronze

ADOT TS 9-4 Type VI

Wiring	Coating
SP-8050 - <input type="text"/>	- <input type="text"/>
Blank =None WH=Wiring Harness	P_ _=Paint

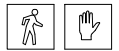

Note: Includes steel nipples, iron ells, 12-circuit terminal block, and bronze terminal compartment. Aluminum door standard.

Note: 1. All assemblies supplied standard with stainless steel fasteners.
2. See Reference Section for available paint colors.



Terminal Compartments, Post Top



Terminal Compartment Assy, Post Top 2-Way 12" Signal, Balanced, Bronze

ADOT TS 9-8 Type X

SP-8056 -	Signal Section	-	Orientation	-	Wiring	-	Coating
	<input type="checkbox"/>		<input type="checkbox"/>		<input type="checkbox"/>		<input type="checkbox"/>
	2=21" Tube		RH=Right Hand		Blank =None		P__=Paint
	3 =34.5" Tube		LH=Left Hand		WH=Wiring		
	4=48" Tube				Harness		
	5=61.5" Tube						



Note: Left hand shown, right hand opposite.
Includes steel nipples, iron ells, bronze hub with mounting hardware, 12-circuit terminal block, and bronze terminal compartment. Aluminum door standard.



Terminal Compartment Assy, Post Top 2-Way 12" Signal, Unbalanced 30" CTC, Bronze

ADOT TS 9-4 Type VI

SP-8061 -	Signal Section	-	Wiring	-	Coating
	<input type="checkbox"/>		<input type="checkbox"/>		<input type="checkbox"/>
	3-2=34.5" Tube		Blank =None		P__=Paint
	4-2=48" Tube		WH=Wiring		
	4-3=48" Tube		Harness		
	5-3=61.5" Tube				
	5-4=61.5" Tube				



Note: Wiring harness wires are not pulled through the lower arms, but instead are bundled and coiled in the terminal compartment.
Includes steel nipples, iron ells, bronze hub with mounting hardware, 12-circuit terminal block, and bronze terminal compartment. Aluminum door standard.

Note: 1. All assemblies supplied standard with stainless steel fasteners.
2. See Reference Section for available paint colors.



Terminal Compartments, Post Top

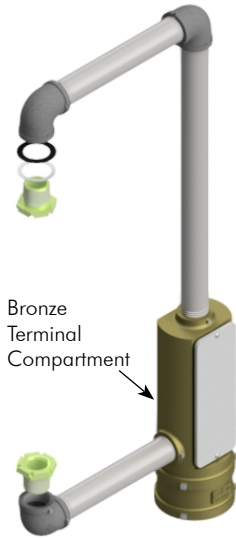

Bronze Terminal Compartment

Terminal Compartment Assy, Post Top 1-Way 12" Signal, 15" CTC, Bronze

Caltrans TV-1-T

SP-8059 -	Signal Section	Orientation	Wiring	Door	Coating
	<input type="checkbox"/>	<input type="checkbox"/>	<input type="checkbox"/>	<input type="checkbox"/>	<input type="checkbox"/>
	1=7.25" Tube 2=20.5" Tube 3=34" Tube 4=47.5" Tube 5=61" Tube	RH=Right Hand LH=Left Hand	Blank =None WH=Wiring Harness	Blank=Plastic AD=Aluminum	P__=Paint



Note: Left hand shown, right hand opposite.
Includes steel nipples, iron ells, 12-circuit terminal block, and bronze terminal compartment. Plastic door standard, aluminum door available.

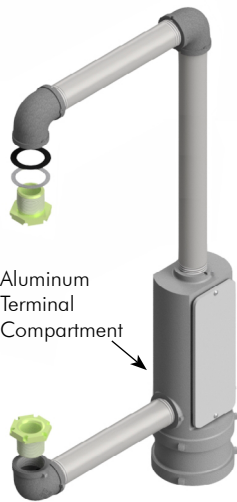

Aluminum Terminal Compartment

Terminal Compartment Assy, Post Top 1-Way 12" Signal, 15" CTC, Alum

Caltrans TV-1-T

SP-8259 -	Signal Section	Orientation	Wiring	Door	Coating
	<input type="checkbox"/>	<input type="checkbox"/>	<input type="checkbox"/>	<input type="checkbox"/>	<input type="checkbox"/>
	1=7.25" Tube 2=20.5" Tube 3=34" Tube 4=47.5" Tube 5=61" Tube	RH=Right Hand LH=Left Hand	Blank =None WH=Wiring Harness	Blank=Plastic AD=Aluminum	P__=Paint



Note: Left hand shown, right hand opposite.
Includes steel nipples, iron ells, 12-circuit terminal block, and aluminum terminal compartment. Plastic door standard, aluminum door available.

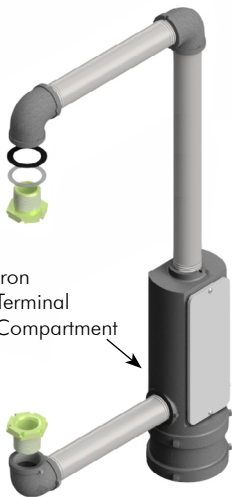

Iron Terminal Compartment

Terminal Compartment Assy, Post Top 1-Way 12" Signal, 15" CTC, Iron

Caltrans TV-1-T

SP-8359 -	Signal Section	Orientation	Wiring	Door	Coating
	<input type="checkbox"/>	<input type="checkbox"/>	<input type="checkbox"/>	<input type="checkbox"/>	<input type="checkbox"/>
	1=7.25" Tube 2=20.5" Tube 3=34" Tube 4=47.5" Tube 5=61" Tube	RH=Right Hand LH=Left Hand	Blank =None WH=Wiring Harness	Blank=Plastic AD=Aluminum	P__=Paint



Note: Left hand shown, right hand opposite.
Includes steel nipples, iron ells, 12-circuit terminal block, and iron terminal compartment. Plastic door standard, aluminum door available.

Note: 1. All assemblies supplied standard with stainless steel fasteners.
2. See Reference Section for available paint colors.



Terminal Compartments, Post Top



Terminal Compartment Assy, Post Top 2-Way 12" Signal, 30" CTC, Bronze

Caltrans TV-2-T

SP-8060 -

Signal Section	Wiring	Door	Coating
<input type="checkbox"/>	<input type="checkbox"/>	<input type="checkbox"/>	<input type="checkbox"/>
1 = 7.25" Tube	Blank = None	Blank = Plastic	P__ = Paint
2 = 20.5" Tube	WH = Wiring	AD = Aluminum	
3 = 34" Tube	Harness		
4 = 47.5" Tube			
5 = 61" Tube			



Note: Includes steel nipples, iron ells, 12-circuit terminal block, and bronze terminal compartment. Plastic door standard, aluminum door available

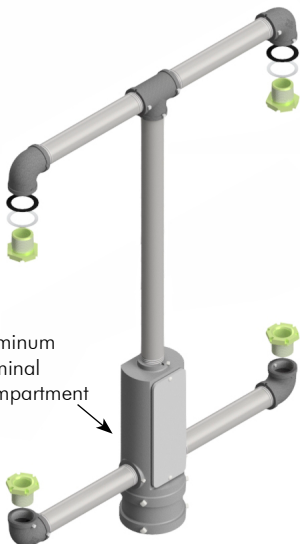

Terminal Compartment Assy, Post Top 2-Way 12" Signal, 30" CTC, Alum

Caltrans TV-2-T

SP-8260 -

Signal Section	Wiring	Door	Coating
<input type="checkbox"/>	<input type="checkbox"/>	<input type="checkbox"/>	<input type="checkbox"/>
1 = 7.25" Tube	Blank = None	Blank = Plastic	P__ = Paint
2 = 20.5" Tube	WH = Wiring	AD = Aluminum	
3 = 34" Tube	Harness		
4 = 47.5" Tube			
5 = 61" Tube			



Note: Includes steel nipples, iron ells, 12-circuit terminal block, and aluminum terminal compartment. Plastic door standard, aluminum door available

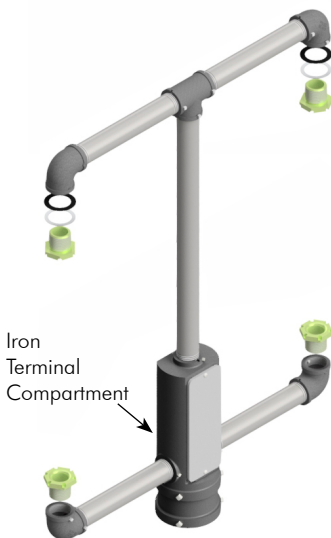

Terminal Compartment Assy, Post Top 2-Way 12" Signal, 30" CTC, Iron

Caltrans TV-2-T

SP-8360 -

Signal Section	Wiring	Door	Coating
<input type="checkbox"/>	<input type="checkbox"/>	<input type="checkbox"/>	<input type="checkbox"/>
1 = 7.25" Tube	Blank = None	Blank = Plastic	P__ = Paint
2 = 20.5" Tube	WH = Wiring	AD = Aluminum	
3 = 34" Tube	Harness		
4 = 47.5" Tube			
5 = 61" Tube			



Note: Includes steel nipples, iron ells, 12-circuit terminal block, and iron terminal compartment. Plastic door standard, aluminum door available

Note: 1. All assemblies supplied standard with stainless steel fasteners.
2. See Reference Section for available paint colors.



Terminal Compartments, Post Top

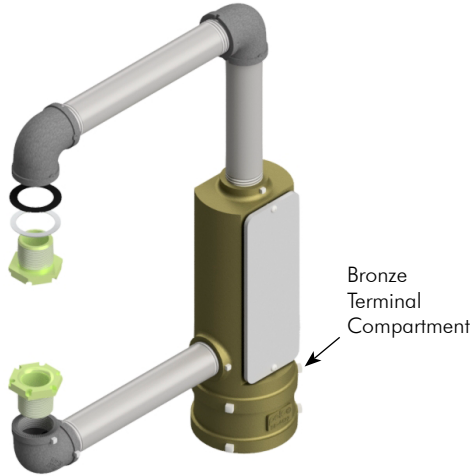

Terminal Compartment Assy, Post Top 1-Way Pedestrian Signal, 15" CTC, Bronze

Caltrans TP-1-T

SP-8016 -	Orientation	-	Wiring	-	Door	-	Coating
	<input type="checkbox"/>		<input type="checkbox"/>		<input type="checkbox"/>		<input type="checkbox"/>
	RH=Right Hand LH=Left Hand		Blank =None WH=Wiring Harness		Blank=Plastic AD=Aluminum		P_ _=Paint

Note: Left hand shown, right hand opposite.
Includes steel nipples, iron ells, 12-circuit terminal block, and bronze terminal compartment. Plastic door standard, aluminum door available.

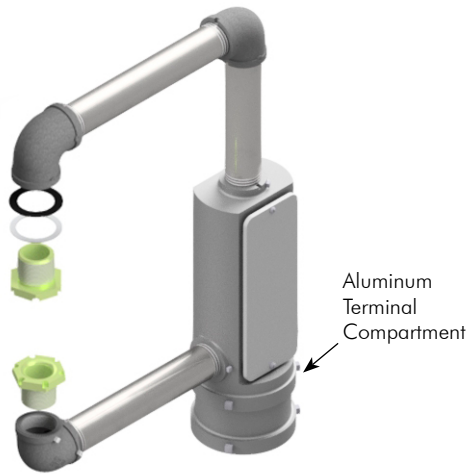

Terminal Compartment Assy, Post Top 1-Way Pedestrian Signal, 15" CTC, Alum

Caltrans TP-1-T

SP-8216 -	Orientation	-	Wiring	-	Door	-	Coating
	<input type="checkbox"/>		<input type="checkbox"/>		<input type="checkbox"/>		<input type="checkbox"/>
	RH=Right Hand LH=Left Hand		Blank =None WH=Wiring Harness		Blank=Plastic AD=Aluminum		P_ _=Paint

Note: Left hand shown, right hand opposite.
Includes steel nipples, iron ells, 12-circuit terminal block, and aluminum terminal compartment. Plastic door standard, aluminum door available.

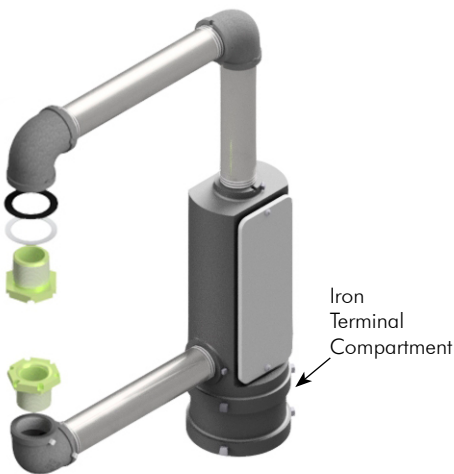

Terminal Compartment Assy, Post Top 1-Way Pedestrian Signal, 15" CTC, Iron

Caltrans TP-1-T

SP-8316 -	Orientation	-	Wiring	-	Door	-	Coating
	<input type="checkbox"/>		<input type="checkbox"/>		<input type="checkbox"/>		<input type="checkbox"/>
	RH=Right Hand LH=Left Hand		Blank =None WH=Wiring Harness		Blank=Plastic AD=Aluminum		P_ _=Paint

Note: Left hand shown, right hand opposite.
Includes steel nipples, iron ells, 12-circuit terminal block, and iron terminal compartment. Plastic door standard, aluminum door available.



Note: 1. All assemblies supplied standard with stainless steel fasteners.
2. See Reference Section for available paint colors.



Terminal Compartments, Post Top

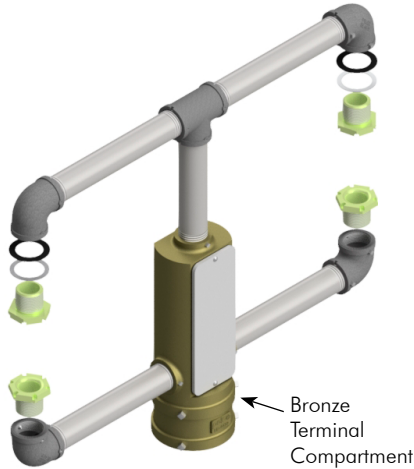

Terminal Compartment Assy, Post Top 2-Way Pedestrian Signal, 30" CTC, Bronze

Caltrans TP-2-T

SP-8026 - - -
 Wiring Door Coating
 Blank = None Blank = Plastic P__ = Paint
 WH = Wiring AD = Aluminum
 Harness

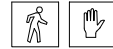

Note: Includes steel nipples, iron ells, 12-circuit terminal block, and bronze terminal compartment. Plastic door standard, aluminum door available.

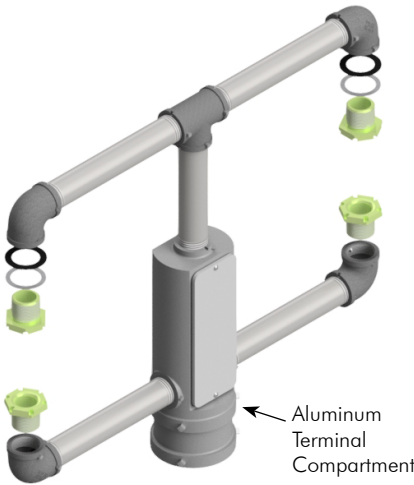

Terminal Compartment Assy, Post Top 2-Way Pedestrian Signal, 30" CTC, Alum

Caltrans TP-2-T

SP-8226 - - -
 Wiring Door Coating
 Blank = None Blank = Plastic P__ = Paint
 WH = Wiring AD = Aluminum
 Harness

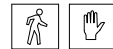

Note: Includes steel nipples, iron ells, 12-circuit terminal block, and aluminum terminal compartment. Plastic door standard, aluminum door available.

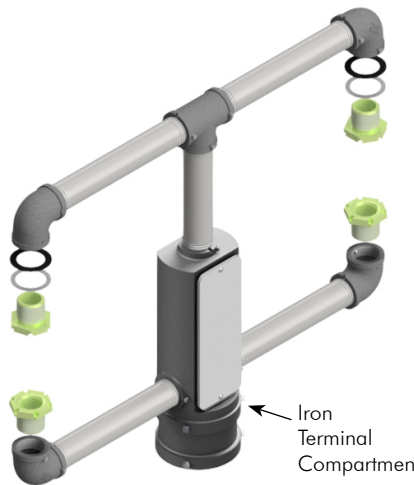

Terminal Compartment Assy, Post Top 2-Way Pedestrian Signal, 30" CTC, Iron

Caltrans TP-2-T

SP-8326 - - -
 Wiring Door Coating
 Blank = None Blank = Plastic P__ = Paint
 WH = Wiring AD = Aluminum
 Harness

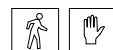

Note: Includes steel nipples, iron ells, 12-circuit terminal block, and iron terminal compartment. Plastic door standard, aluminum door available.

Note: 1. All assemblies supplied standard with stainless steel fasteners.
 2. See Reference Section for available paint colors.



Terminal Compartments, Post Top



Terminal Compartment Assy, Post Top 1-Way 12" Signal, 13" CTC, Bronze

Signal Section	Orientation	Wiring	Door	Coating
SP-8022 - <input type="text"/>	- <input type="text"/>	- <input type="text"/>	- <input type="text"/>	- <input type="text"/>
1=7.25" Tube	RH=Right Hand	Blank =None	Blank=Plastic	P__=Paint
2=20.5" Tube	LH=Left Hand	WH=Wiring	AD=Aluminum	
3 =34" Tube		Harness		
4=47.5" Tube				
5=61" Tube				

Note: Left hand shown, right hand opposite.
Includes steel nipples, iron ells, 12-circuit terminal block, and bronze terminal compartment. Plastic door standard, aluminum door available.

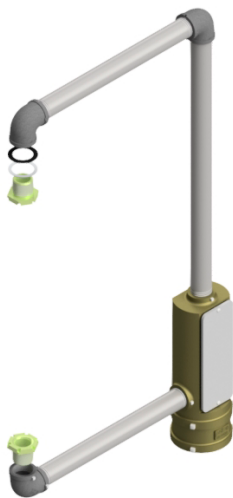

Terminal Compartment Assy, Post Top 1-Way 12" Signal, 22" CTC, Bronze

Signal Section	Orientation	Wiring	Door	Coating
SP-8023 - <input type="text"/>	- <input type="text"/>	- <input type="text"/>	- <input type="text"/>	- <input type="text"/>
1=7.25" Tube	RH=Right Hand	Blank =None	Blank=Plastic	P__=Paint
2=20.5" Tube	LH=Left Hand	WH=Wiring	AD=Aluminum	
3 =34" Tube		Harness		
4=47.5" Tube				
5=61" Tube				

Note: Left hand shown, right hand opposite.
Includes steel nipples, iron ells, 12-circuit terminal block, and bronze terminal compartment. Plastic door standard, aluminum door available.



Terminal Compartment Assy, Post Top 2-Way 12" Signal, 26" CTC, Bronze

Signal Section	Wiring	Door	Coating
SP-8030 - <input type="text"/>	- <input type="text"/>	- <input type="text"/>	- <input type="text"/>
1=7.25" Tube	Blank =None	Blank=Plastic	P__=Paint
2=20.5" Tube	WH=Wiring	AD=Aluminum	
3 =34" Tube	Harness		
4=47.5" Tube			
5=61" Tube			

Note: Includes steel nipples, iron ells, 12-circuit terminal block, and bronze terminal compartment. Plastic door standard, aluminum door available.

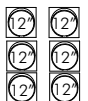

Note: 1. All assemblies supplied standard with stainless steel fasteners.
2. See Reference Section for available paint colors.



Terminal Compartments, Post Top

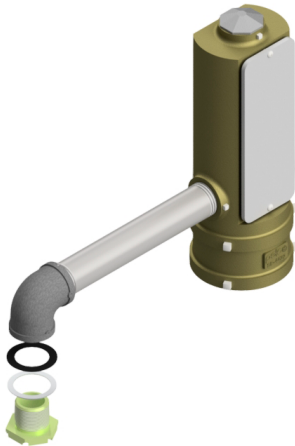

Terminal Compartment Assy, Post Top 1-Way Pedestrian Signal, 15" CTC, Bronze

SP-8018 - - - -

Orientation	Wiring	Door	Coating
RH=Right Hand LH=Left Hand	Blank =None WH=Wiring Harness	Blank=Plastic AD=Aluminum	P_ _=Paint

Note: Left hand shown, right hand opposite.
Includes steel nipples, iron ells, 12-circuit terminal block, and bronze terminal compartment. Plastic door standard, aluminum door available.

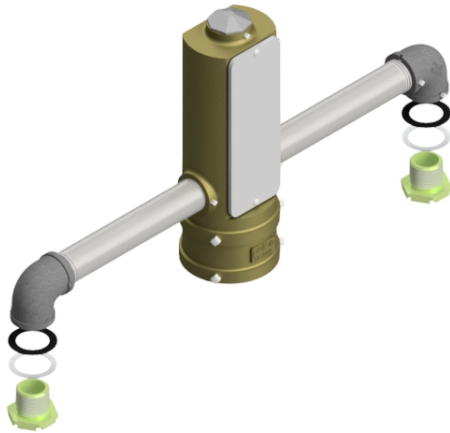

Terminal Compartment Assy, Post Top 2-Way Pedestrian Signal, 30" CTC, Bronze

SP-8054 - - -

Wiring	Door	Coating
Blank =None WH=Wiring Harness	Blank=Plastic AD=Aluminum	P_ _=Paint

Note: Includes steel nipples, iron ells, 12-circuit terminal block, and bronze terminal compartment. Plastic door standard, aluminum door available.

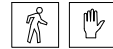

Note: 1. All assemblies supplied standard with stainless steel fasteners.
2. See Reference Section for available paint colors.



Terminal Compartments, Post Top

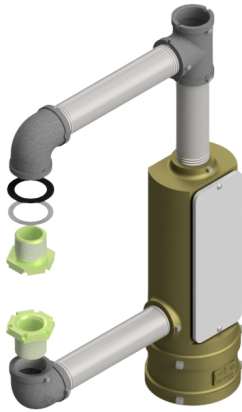

Terminal Compartment Assy, Post Top 1-Way 12" Signal & Solar Panel, 13" CTC, Bronze

Signal Section	Orientation	Door	Coating
SP-8024 - <input type="checkbox"/>	- <input type="checkbox"/>	- <input type="checkbox"/>	- <input type="checkbox"/>
1=7.25" Tube	RH=Right Hand	Blank=Plastic	P__=Paint
2=20.5" Tube	LH=Left Hand	AD=Aluminum	
3=34" Tube			
4=47.5" Tube			
5=61" Tube			

SOLAR



Note: Left hand shown, right hand opposite.
Includes steel nipples, iron ells, 12-circuit terminal block, and bronze terminal compartment. Plastic door standard, aluminum door available.

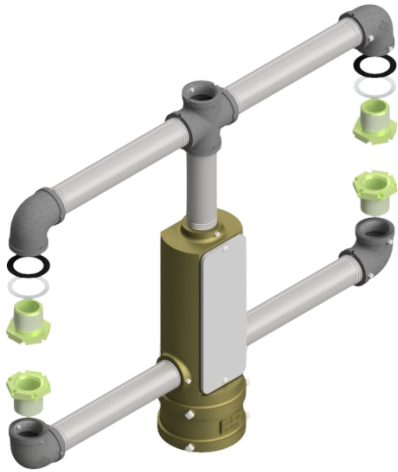

Terminal Compartment Assy, Post Top 1-Way 12" Signal & Solar Panel, 30" CTC, Bronze

Signal Section	Door	Coating
SP-8025 - <input type="checkbox"/>	- <input type="checkbox"/>	- <input type="checkbox"/>
1=7.25" Tube	Blank=Plastic	P__=Paint
2=20.5" Tube	AD=Aluminum	
3=34" Tube		
4=47.5" Tube		
5=61" Tube		

SOLAR



Note: Includes steel nipples, iron ells, 12-circuit terminal block, and bronze terminal compartment. Plastic door standard, aluminum door available.

Note: 1. All assemblies supplied standard with stainless steel fasteners.
2. See Reference Section for available paint colors.



Terminal Compartments, Post Top



Terminal Compartment Assy, Post Top SOP 1-Sec 12" Signal, Solar Panel, and 1-Way School Zone, Bronze

SP-8021 -

--

 -

--

 Blank=Plastic P__=Paint
 AD=Aluminum

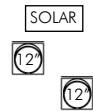

Note: Left hand shown, right hand opposite.
Includes steel nipples, iron ells, aluminum hubs, 12-circuit terminal block, and bronze terminal compartment. Plastic door standard, aluminum door available.



Terminal Compartment Assy, Post Top 3-Way 12" Signal, 30" CTC, Iron

Caltrans TV-3-T

SP-8365 -

--

 -

--

 -

--

 -

--

 1=7.25" Tube Blank =None Blank=Plastic P__=Paint
 2=20.5" Tube WH=Wiring AD=Aluminum
 3=34" Tube Harness
 4=47.5" Tube
 5=61" Tube

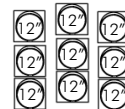

Iron Terminal Compartment

Note: Left hand shown, right hand opposite.
Includes steel nipples, iron ells, 12-circuit terminal block, and iron terminal compartment. Plastic door standard, aluminum door available.

Note: 1. All assemblies supplied standard with stainless steel fasteners.
2. See Reference Section for available paint colors.



Terminal Compartments, SOP

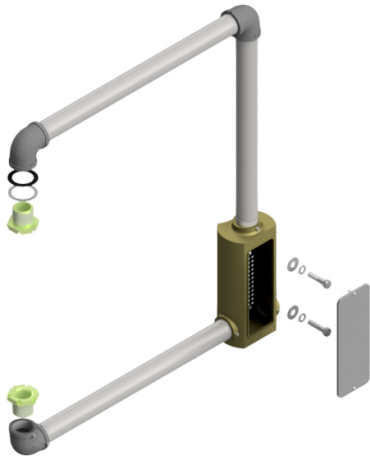

Terminal Compartment Assy, Side-of-Pole 1-Way 8" Signals, 27" CTC, Bronze

ADOT TS 9-3 Type V

SP-8045 - - - -
 3 =24" Tube RH=Right Hand Blank =None P_ _=Paint
 LH=Left Hand WH=Wiring Harness



Note: Left hand shown, right hand opposite.
 Includes steel nipples, iron ells, 12-circuit terminal block, mounting hardware, and bronze terminal compartment. Aluminum door standard.

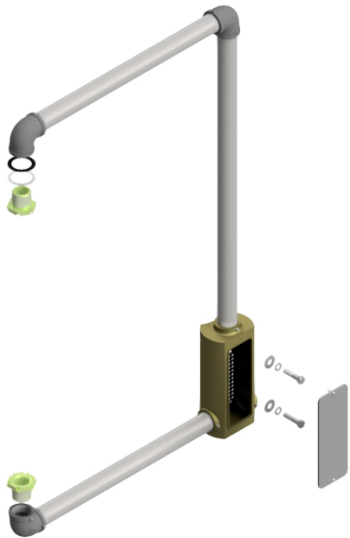

Terminal Compartment Assy, Side-of-Pole 1-Way 12" Signal, 27" CTC, Bronze

ADOT TS 9-3 Type V

SP-8046 - - - -
 2=21" Tube RH=Right Hand Blank =None P_ _=Paint
 3 =34.5" Tube LH=Left Hand WH=Wiring Harness
 4=48" Tube
 5=61.5" Tube



Note: Left hand shown, right hand opposite.
 Includes steel nipples, iron ells, 12-circuit terminal block, mounting hardware, and bronze terminal compartment. Aluminum door standard.

Note: 1. All assemblies supplied standard with stainless steel fasteners.
 2. See Reference Section for available paint colors.



Terminal Compartments, SOP



Terminal Compartment Assy, Side-of-Pole 2-Way 8" Signal, 30" CTC, Bronze

ADOT TS 9-5 Type VII

SP-8052 -

Signal Section	-	Wiring	-	Coating
<input type="text"/>	-	<input type="text"/>	-	<input type="text"/>
3 =24" Tube		Blank =None WH=Wiring Harness		P_ _=Paint



Note: Includes steel nipples, iron ells, 12-circuit terminal block, mounting hardware, and bronze terminal compartment. Aluminum door standard.



Terminal Compartment Assy, Side-of-Pole 2-Way 12" Signal, 30" CTC, Bronze

ADOT TS 9-5 Type VII

SP-8051 -

Signal Section	-	Wiring	-	Coating
<input type="text"/>	-	<input type="text"/>	-	<input type="text"/>
2=21" Tube 3 =34.5" Tube 4=48" Tube 5=61.5" Tube		Blank =None WH=Wiring Harness		P_ _=Paint



Note: Includes steel nipples, iron ells, 12-circuit terminal block, mounting hardware, and bronze terminal compartment. Aluminum door standard.

Note: 1. All assemblies supplied standard with stainless steel fasteners.
2. See Reference Section for available paint colors.



Terminal Compartments, SOP

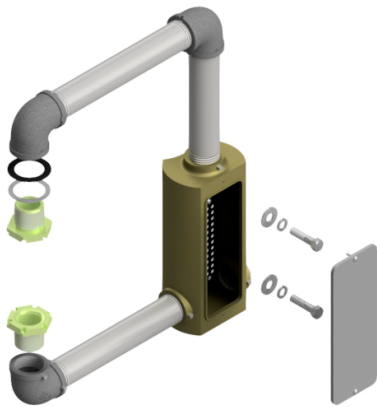

Terminal Compartment Assy, Side-of-Pole 1-Way for Pedestrian Signal or Illuminated Message, 15" CTC, Bronze

ADOT TS 9-3 Type V

SP-8047 - - - -
 Tube Orientation Wiring Coating
 Blank=9.5" (ped signal) RH=Right Hand Blank=None P__=Paint
 IM= 23.63" (Illum Msg Sign) LH=Left Hand WH=Wiring
 Harness
 Ped Only



Note: Left hand shown, right hand opposite.
 Includes steel nipples, iron ells, 12-circuit terminal block, mounting hardware,
 and bronze terminal compartment. Aluminum door standard.

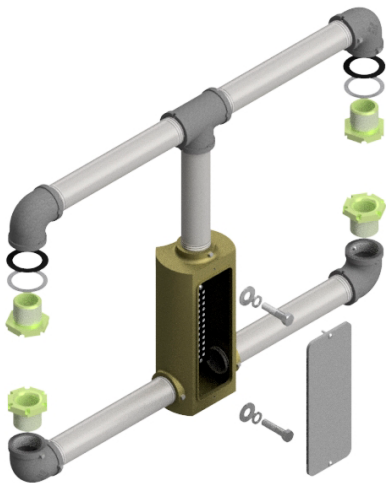

Terminal Compartment Assy, Side-of-Pole 2-Way Pedestrian Signal, 30" CTC, Bronze

ADOT TS 9-5 Type VII

SP-8053 - -
 Wiring Coating
 Blank=None P__=Paint
 WH=Wiring
 Harness



Note: Includes steel nipples, iron ells, 12-circuit terminal block, mounting hardware,
 and bronze terminal compartment. Aluminum door standard.

Note: 1. All assemblies supplied standard with stainless steel fasteners.
 2. See Reference Section for available paint colors.



Terminal Compartments, SOP

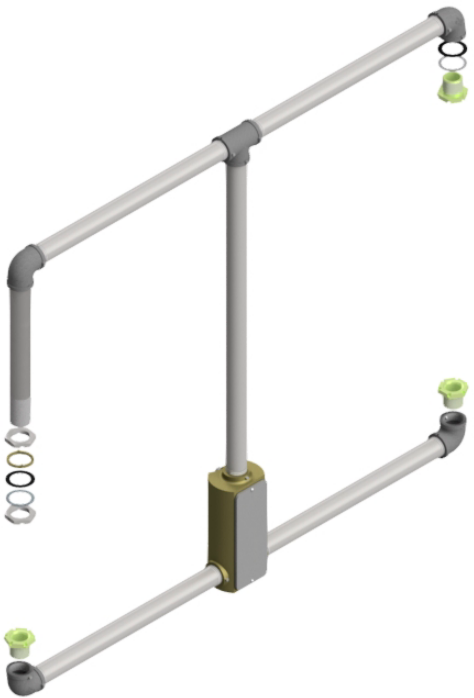

Terminal Compartment Assy, Side-of-Pole 2-Way 12" Signal, Unbalanced 54" CTC, Bronze

ADOT TS 9-5 Type VII

Signal Section	Wiring	Coating
SP-8062 - <input type="text"/>	- <input type="text"/>	- <input type="text"/>
3-2=34.5" Tube	Blank =None	P__=Paint
4-2=48" Tube	WH=Wiring	
4-3=48" Tube	Harness	
5-3=61.5" Tube		
5-4=61.5" Tube		

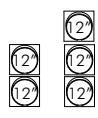

Note: Wiring harness wires are not pulled through the lower arms, but instead are bundled and coiled in the terminal compartment.
Includes steel nipples, iron ells, 12-circuit terminal block, and bronze terminal compartment. Aluminum door standard.

WEST COAST



Note: 1. All assemblies supplied standard with stainless steel fasteners.
2. See Reference Section for available paint colors.



Terminal Compartments, SOP

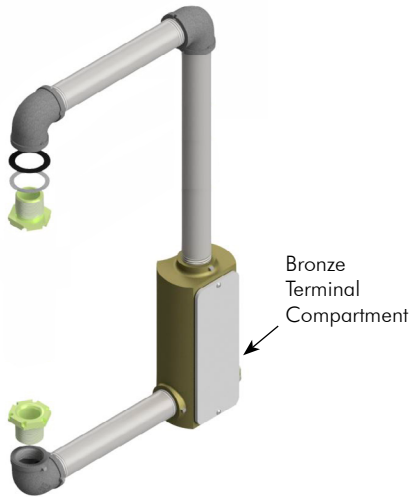

Terminal Compartment Assy, Side-of-Pole 1-Way 12" Signal, 15" CTC, Bronze

Caltrans SV-1-T

Mount	Signal Section	Orientation	Wiring	Door	Coating
SP-8057 - <input type="checkbox"/>	- <input type="checkbox"/>	- <input type="checkbox"/>	- <input type="checkbox"/>	- <input type="checkbox"/>	- <input type="checkbox"/>
Blank=Std Dia Pole LDP=Lg Dia Pole (extended arm for larger pole dia)	1=7.25" Tube 2=20.5" Tube 3=34" Tube 4=47.5" Tube 5=61" Tube	RH=Right Hand LH=Left Hand	Blank =None WH=Wiring Harness	Blank=Plastic AD=Aluminum	P_ _=Paint



Note: Left hand shown, right hand opposite.
Includes steel nipples, iron ells, 12-circuit terminal block, and bronze terminal compartment. Plastic door standard, aluminum door available.

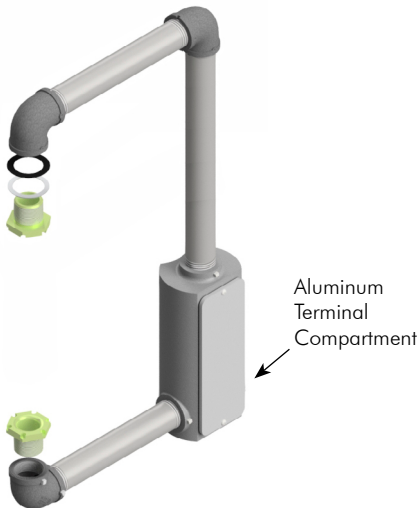

Terminal Compartment Assy, Side-of-Pole 1-Way 12" Signal, 15" CTC, Alum

Caltrans SV-1-T

Mount	Signal Section	Orientation	Wiring	Door	Coating
SP-8257 - <input type="checkbox"/>	- <input type="checkbox"/>	- <input type="checkbox"/>	- <input type="checkbox"/>	- <input type="checkbox"/>	- <input type="checkbox"/>
Blank=Std Dia Pole LDP=Lg Dia Pole (extended arm for larger pole dia)	1=7.25" Tube 2=20.5" Tube 3=34" Tube 4=47.5" Tube 5=61" Tube	RH=Right Hand LH=Left Hand	Blank =None WH=Wiring Harness	Blank=Plastic AD=Aluminum	P_ _=Paint



Note: Left hand shown, right hand opposite.
Includes steel nipples, iron ells, 12-circuit terminal block, and aluminum terminal compartment. Plastic door standard, aluminum door available.

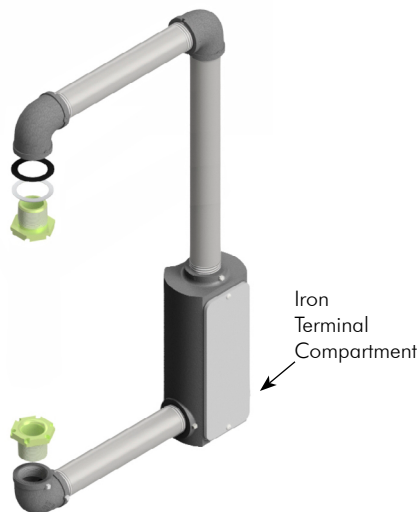

Terminal Compartment Assy, Side-of-Pole 1-Way 12" Signal, 15" CTC, Iron

Caltrans SV-1-T

Mount	Signal Section	Orientation	Wiring	Door	Coating
SP-8357 - <input type="checkbox"/>	- <input type="checkbox"/>	- <input type="checkbox"/>	- <input type="checkbox"/>	- <input type="checkbox"/>	- <input type="checkbox"/>
Blank=Std Dia Pole LDP=Lg Dia Pole (extended arm for larger pole dia)	1=7.25" Tube 2=20.5" Tube 3=34" Tube 4=47.5" Tube 5=61" Tube	RH=Right Hand LH=Left Hand	Blank =None WH=Wiring Harness	Blank=Plastic AD=Aluminum	P_ _=Paint



Note: Left hand shown, right hand opposite.
Includes steel nipples, iron ells, 12-circuit terminal block, and iron terminal compartment. Plastic door standard, aluminum door available.

Note: 1. All assemblies supplied standard with stainless steel fasteners.
2. See Reference Section for available paint colors.



Terminal Compartments, SOP



Terminal Compartment Assy, Side-of-Pole 2-Way 12" Signal, 30" CTC, Bronze

Caltrans SV-2-TA

SP-8058	-	<input type="checkbox"/>	-	<input type="checkbox"/>	-	<input type="checkbox"/>	-	<input type="checkbox"/>	-	<input type="checkbox"/>
		Mount		Signal Section		Wiring		Door		Coating
		Blank=Std Dia Pole LDP=Lg Dia Pole (extended arm for larger pole dia)		1=7.25" Tube 2=20.5" Tube 3=34" Tube 4=47.5" Tube 5=61" Tube		Blank =None WH=Wiring Harness		Blank=Plastic AD=Aluminum		P_ _=Paint



Note: Includes steel nipples, iron ells, 12-circuit terminal block, and bronze terminal compartment. Plastic door standard, aluminum door available.

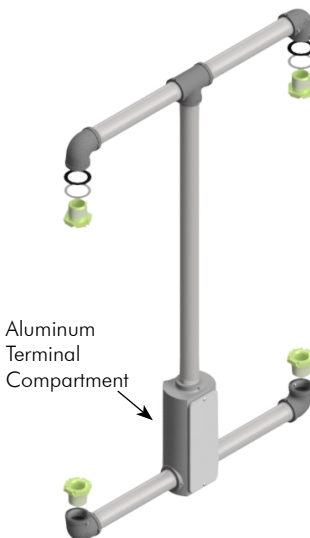

Terminal Compartment Assy, Side-of-Pole 2-Way 12" Signal, 30" CTC, Alum

Caltrans SV-2-TA

SP-8258	-	<input type="checkbox"/>	-	<input type="checkbox"/>	-	<input type="checkbox"/>	-	<input type="checkbox"/>	-	<input type="checkbox"/>
		Mount		Signal Section		Wiring		Door		Coating
		Blank=Std Dia Pole LDP=Lg Dia Pole (extended arm for larger pole dia)		1=7.25" Tube 2=20.5" Tube 3=34" Tube 4=47.5" Tube 5=61" Tube		Blank =None WH=Wiring Harness		Blank=Plastic AD=Aluminum		P_ _=Paint



Note: Includes steel nipples, iron ells, 12-circuit terminal block, and aluminum terminal compartment. Plastic door standard, aluminum door available.

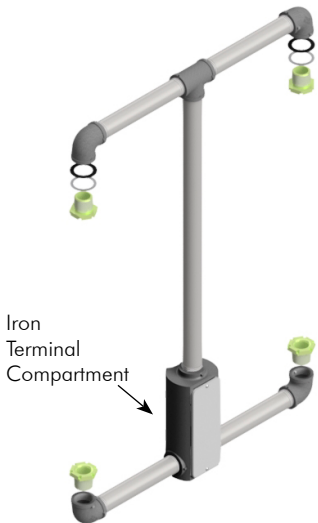

Terminal Compartment Assy, Side-of-Pole 2-Way 12" Signal, 30" CTC, Iron

Caltrans SV-2-TA

SP-8358	-	<input type="checkbox"/>	-	<input type="checkbox"/>	-	<input type="checkbox"/>	-	<input type="checkbox"/>	-	<input type="checkbox"/>
		Mount		Signal Section		Wiring		Door		Coating
		Blank=Std Dia Pole LDP=Lg Dia Pole (extended arm for larger pole dia)		1=7.25" Tube 2=20.5" Tube 3=34" Tube 4=47.5" Tube 5=61" Tube		Blank =None WH=Wiring Harness		Blank=Plastic AD=Aluminum		P_ _=Paint

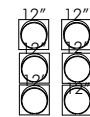

Note: Includes steel nipples, iron ells, 12-circuit terminal block, and iron terminal compartment. Plastic door standard, aluminum door available.

Note: 1. All assemblies supplied standard with stainless steel fasteners.
2. See Reference Section for available paint colors.



Terminal Compartments, SOP

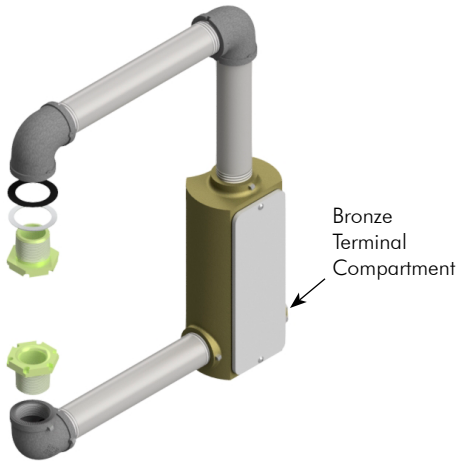

Terminal Compartment Assy, Side-of-Pole 1-Way Pedestrian Signal, 15" CTC, Bronze

Caltrans SP-1-T

SP-8017	-	<input type="checkbox"/>	-	<input type="checkbox"/>	-	<input type="checkbox"/>	-	<input type="checkbox"/>	-	<input type="checkbox"/>
		Mount		Orientation		Wiring		Door		Coating
		Blank=Std Dia Pole LDP=Lg Dia Pole (extended arm for larger pole dia)		RH=Right Hand LH=Left Hand		Blank=None WH=Wiring Harness		Blank=Plastic AD=Aluminum		P__=Paint

Note: Left hand shown, right hand opposite.
Includes steel nipples, iron ells, 12-circuit terminal block, and bronze terminal compartment. Plastic door standard, aluminum door available.

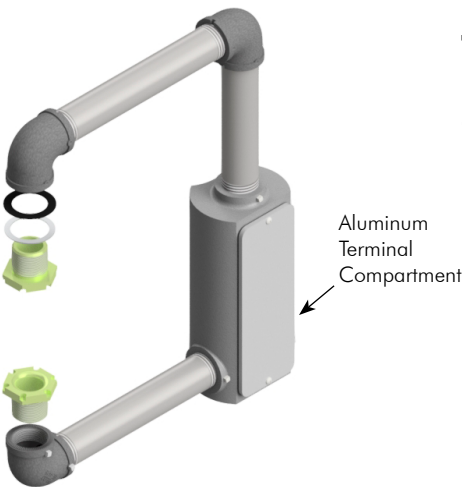

Terminal Compartment Assy, Side-of-Pole 1-Way Pedestrian Signal, 15" CTC, Alum

Caltrans SP-1-T

SP-8217	-	<input type="checkbox"/>	-	<input type="checkbox"/>	-	<input type="checkbox"/>	-	<input type="checkbox"/>	-	<input type="checkbox"/>
		Mount		Orientation		Wiring		Door		Coating
		Blank=Std Dia Pole LDP=Lg Dia Pole (extended arm for larger pole dia)		RH=Right Hand LH=Left Hand		Blank=None WH=Wiring Harness		Blank=Plastic AD=Aluminum		P__=Paint

Note: Left hand shown, right hand opposite.
Includes steel nipples, iron ells, 12-circuit terminal block, and aluminum terminal compartment. Plastic door standard, aluminum door available.

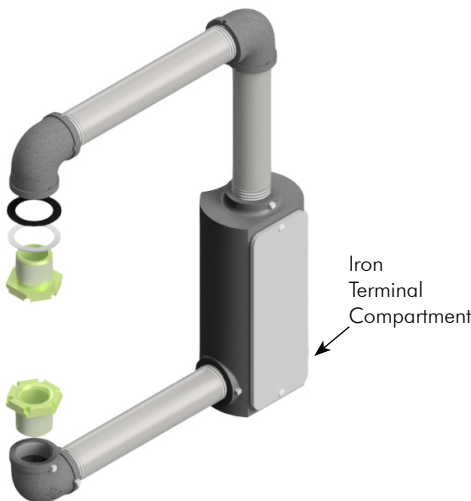

Terminal Compartment Assy, Side-of-Pole 1-Way Pedestrian Signal, 15" CTC, Iron

Caltrans SP-1-T

SP-8317	-	<input type="checkbox"/>	-	<input type="checkbox"/>	-	<input type="checkbox"/>	-	<input type="checkbox"/>	-	<input type="checkbox"/>
		Mount		Orientation		Wiring		Door		Coating
		Blank=Std Dia Pole LDP=Lg Dia Pole (extended arm for larger pole dia)		RH=Right Hand LH=Left Hand		Blank=None WH=Wiring Harness		Blank=Plastic AD=Aluminum		P__=Paint

Note: Left hand shown, right hand opposite.
Includes steel nipples, iron ells, 12-circuit terminal block, and iron terminal compartment. Plastic door standard, aluminum door available.



Note: 1. All assemblies supplied standard with stainless steel fasteners.
2. See Reference Section for available paint colors.



Terminal Compartments, SOP

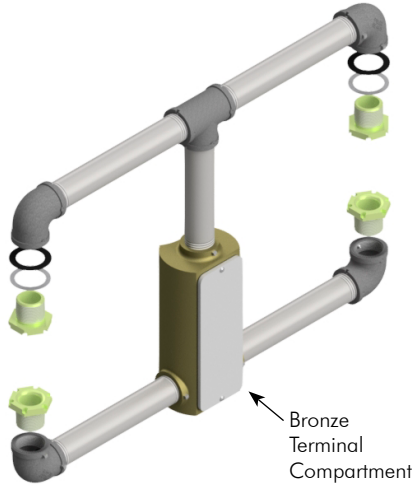

Terminal Compartment Assy, Side-of-Pole 2-Way Pedestrian Signal, 30" CTC, Bronze

Caltrans SP-2-T

SP-8029 - - - -

Mount Wiring Door Coating

Blank=Std Dia Pole Blank =None Blank=Plastic P__=Paint
LDP=Lg Dia Pole WH=Wiring AD=Aluminum
(extended arm for Harness
larger pole dia)

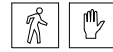

Note: Includes steel nipples, iron ells, 12-circuit terminal block, and bronze terminal compartment. Plastic door standard, aluminum door available.

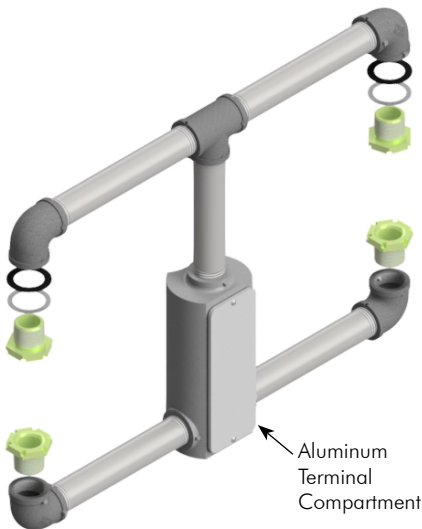

Terminal Compartment Assy, Side-of-Pole 2-Way Pedestrian Signal, 30" CTC, Alum

Caltrans SP-2-T

SP-8229 - - - -

Mount Wiring Door Coating

Blank=Std Dia Pole Blank =None Blank=Plastic P__=Paint
LDP=Lg Dia Pole WH=Wiring AD=Aluminum
(extended arm for Harness
larger pole dia)

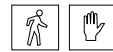

Note: Includes steel nipples, iron ells, 12-circuit terminal block, and aluminum terminal compartment. Plastic door standard, aluminum door available.

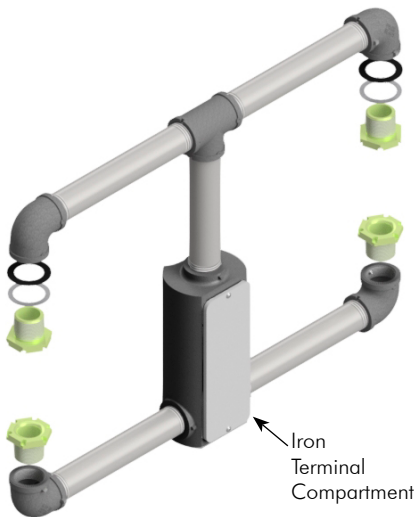

Terminal Compartment Assy, Side-of-Pole 2-Way Pedestrian Signal, 30" CTC, Iron

Caltrans SP-2-T

SP-8329 - - - -

Mount Wiring Door Coating

Blank=Std Dia Pole Blank =None Blank=Plastic P__=Paint
LDP=Lg Dia Pole WH=Wiring AD=Aluminum
(extended arm for Harness
larger pole dia)



Note: Includes steel nipples, iron ells, 12-circuit terminal block, and iron terminal compartment. Plastic door standard, aluminum door available.

Note: 1. All assemblies supplied standard with stainless steel fasteners.
2. See Reference Section for available paint colors.



Terminal Compartments, SOP

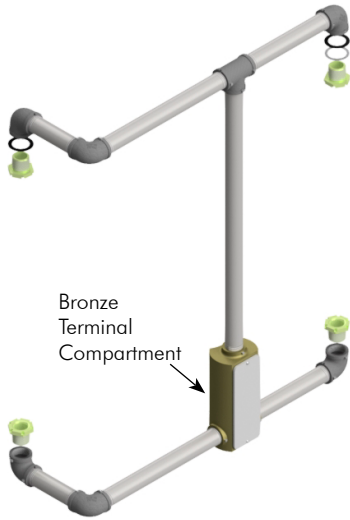

Terminal Compartment Assy, Side-of-Pole 2-Way 12" Signal, Bronze

Caltrans SV-2-TB

SP-8031	-	<input type="checkbox"/>	-	<input type="checkbox"/>	-	<input type="checkbox"/>	-	<input type="checkbox"/>	-	<input type="checkbox"/>	-	<input type="checkbox"/>
		Mount		Signal Section		Orientation		Wiring		Door		Coating
		Blank=Std Dia Pole		2=20.5" Tube		RH=Right Hand		Blank =None		Blank=Plastic		P__=Paint
		LDP=Lg Dia Pole		3 =34" Tube		LH=Left Hand		WH=Wiring		AD=Aluminum		
		(extended arm for larger pole dia)		4=47.5" Tube				Harness				
				5=61" Tube								

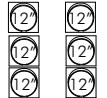

Note: Left hand shown, right hand opposite.
Includes steel nipples, iron ells, 12-circuit terminal block, and bronze terminal compartment. Plastic door standard, aluminum door available.

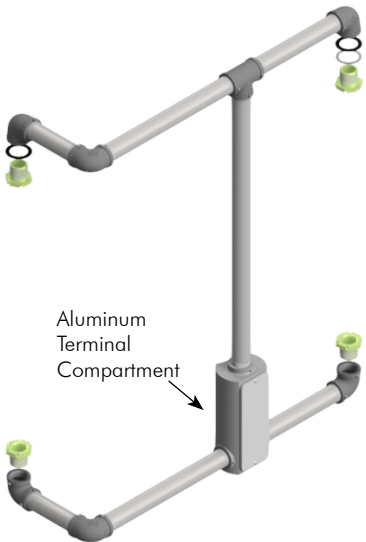

Terminal Compartment Assy, Side-of-Pole 2-Way 12" Signal, Alum

Caltrans SV-2-TB

SP-8231	-	<input type="checkbox"/>	-	<input type="checkbox"/>	-	<input type="checkbox"/>	-	<input type="checkbox"/>	-	<input type="checkbox"/>	-	<input type="checkbox"/>
		Mount		Signal Section		Orientation		Wiring		Door		Coating
		Blank=Std Dia Pole		2=20.5" Tube		RH=Right Hand		Blank =None		Blank=Plastic		P__=Paint
		LDP=Lg Dia Pole		3 =34" Tube		LH=Left Hand		WH=Wiring		AD=Aluminum		
		(extended arm for larger pole dia)		4=47.5" Tube				Harness				
				5=61" Tube								

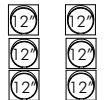

Note: Left hand shown, right hand opposite.
Includes steel nipples, iron ells, 12-circuit terminal block, and aluminum terminal compartment. Plastic door standard, aluminum door available.

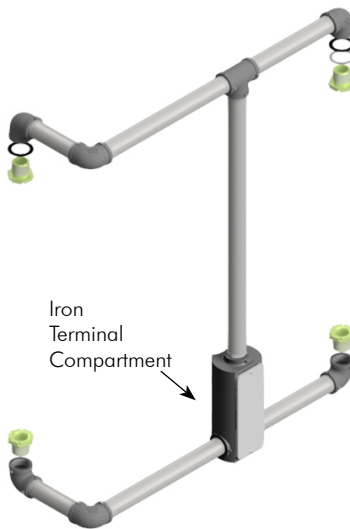

Terminal Compartment Assy, Side-of-Pole 2-Way 12" Signal, Iron

Caltrans SV-2-TB

SP-8331	-	<input type="checkbox"/>	-	<input type="checkbox"/>	-	<input type="checkbox"/>	-	<input type="checkbox"/>	-	<input type="checkbox"/>	-	<input type="checkbox"/>
		Mount		Signal Section		Orientation		Wiring		Door		Coating
		Blank=Std Dia Pole		2=20.5" Tube		RH=Right Hand		Blank =None		Blank=Plastic		P__=Paint
		LDP=Lg Dia Pole		3 =34" Tube		LH=Left Hand		WH=Wiring		AD=Aluminum		
		(extended arm for larger pole dia)		4=47.5" Tube				Harness				
				5=61" Tube								

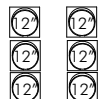

Note: Left hand shown, right hand opposite.
Includes steel nipples, iron ells, 12-circuit terminal block, and iron terminal compartment. Plastic door standard, aluminum door available.

- Note: 1. All assemblies supplied standard with stainless steel fasteners.
2. See Reference Section for available paint colors.



Terminal Compartments, SOP

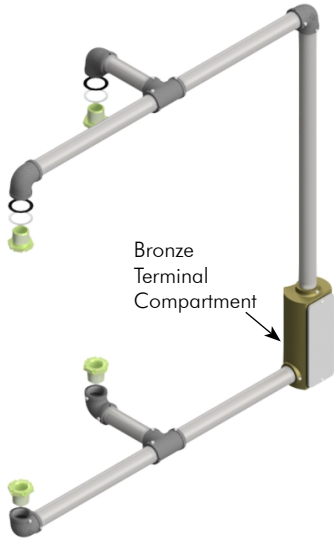

Terminal Compartment Assy, Side-of-Pole 2-Way 12" Signal, Bronze

Caltrans SV-2-TD

SP-8032	-	<input type="checkbox"/>	-	<input type="checkbox"/>	-	<input type="checkbox"/>	-	<input type="checkbox"/>	-	<input type="checkbox"/>	-	<input type="checkbox"/>
		Mount		Signal Section		Orientation		Wiring		Door		Coating
		Blank=Std Dia Pole LDP=Lg Dia Pole (extended arm for larger pole dia)		2=20.5" Tube 3 =34" Tube 4=47.5" Tube 5=61" Tube		RH=Right Hand LH=Left Hand		Blank =None WH=Wiring Harness		Blank=Plastic AD=Aluminum		P__=Paint

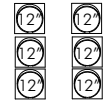

Note: Left hand shown, right hand opposite.
Includes steel nipples, iron ells, 12-circuit terminal block, and bronze terminal compartment. Plastic door standard, aluminum door available.

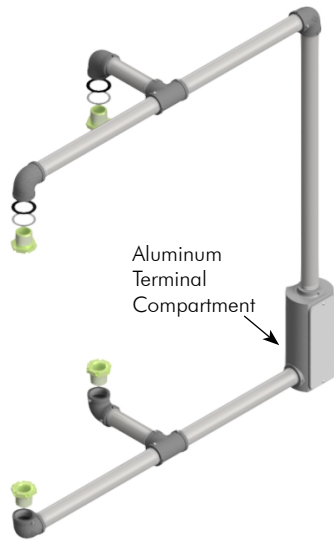

Terminal Compartment Assy, Side-of-Pole 2-Way 12" Signal, Alum

Caltrans SV-2-TD

SP-8232	-	<input type="checkbox"/>	-	<input type="checkbox"/>	-	<input type="checkbox"/>	-	<input type="checkbox"/>	-	<input type="checkbox"/>	-	<input type="checkbox"/>
		Mount		Signal Section		Orientation		Wiring		Door		Coating
		Blank=Std Dia Pole LDP=Lg Dia Pole (extended arm for larger pole dia)		2=20.5" Tube 3 =34" Tube 4=47.5" Tube 5=61" Tube		RH=Right Hand LH=Left Hand		Blank =None WH=Wiring Harness		Blank=Plastic AD=Aluminum		P__=Paint

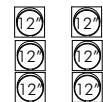

Note: Left hand shown, right hand opposite.
Includes steel nipples, iron ells, 12-circuit terminal block, and aluminum terminal compartment. Plastic door standard, aluminum door available.

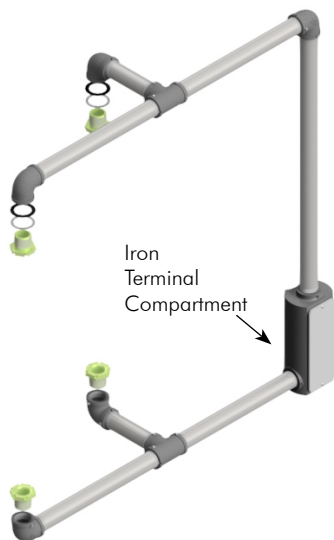

Terminal Compartment Assy, Side-of-Pole 2-Way 12" Signal, Iron

Caltrans SV-2-TD

SP-8332	-	<input type="checkbox"/>	-	<input type="checkbox"/>	-	<input type="checkbox"/>	-	<input type="checkbox"/>	-	<input type="checkbox"/>	-	<input type="checkbox"/>
		Mount		Signal Section		Orientation		Wiring		Door		Coating
		Blank=Std Dia Pole LDP=Lg Dia Pole (extended arm for larger pole dia)		2=20.5" Tube 3 =34" Tube 4=47.5" Tube 5=61" Tube		RH=Right Hand LH=Left Hand		Blank =None WH=Wiring Harness		Blank=Plastic AD=Aluminum		P__=Paint



Note: Left hand shown, right hand opposite.
Includes steel nipples, iron ells, 12-circuit terminal block, and iron terminal compartment. Plastic door standard, aluminum door available.

Note: 1. All assemblies supplied standard with stainless steel fasteners.
2. See Reference Section for available paint colors.



Terminal Compartments, SOP

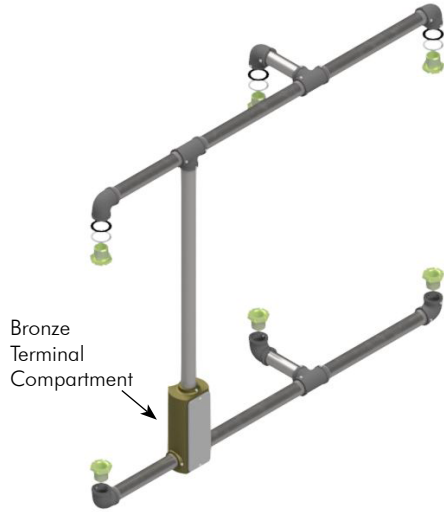

Terminal Compartment Assy, Side-of-Pole 2-Way 12" Signal, Bronze

Caltrans SV-3-TB

SP-8033	-	<input type="checkbox"/>	-	<input type="checkbox"/>	-	<input type="checkbox"/>	-	<input type="checkbox"/>	-	<input type="checkbox"/>	-	<input type="checkbox"/>
		Mount		Signal Section		Orientation		Wiring		Door		Coating
		Blank=Std Dia Pole LDP=Lg Dia Pole (extended arm for larger pole dia)		3 =34" Tube		RH=Right Hand LH=Left Hand		Blank =None WH=Wiring Harness		Blank=Plastic AD=Aluminum		P__=Paint

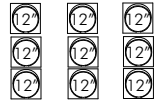

Note: Right hand shown, left hand opposite.
Includes steel nipples, iron ells, 12-circuit terminal block, and bronze terminal compartment. Plastic door standard, aluminum door available.

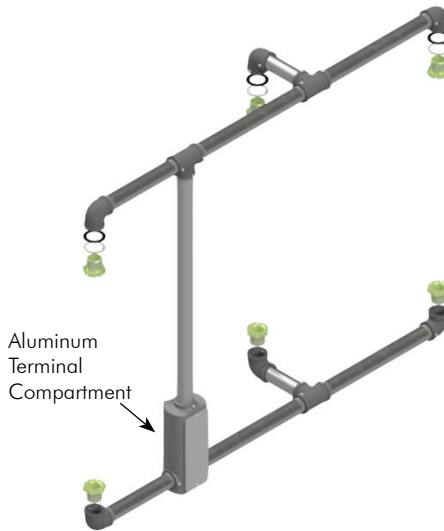

Terminal Compartment Assy, Side-of-Pole 2-Way 12" Signal, Alum

Caltrans SV-3-TB

SP-8233	-	<input type="checkbox"/>	-	<input type="checkbox"/>	-	<input type="checkbox"/>	-	<input type="checkbox"/>	-	<input type="checkbox"/>	-	<input type="checkbox"/>
		Mount		Signal Section		Orientation		Wiring		Door		Coating
		Blank=Std Dia Pole LDP=Lg Dia Pole (extended arm for larger pole dia)		3 =34" Tube		RH=Right Hand LH=Left Hand		Blank =None WH=Wiring Harness		Blank=Plastic AD=Aluminum		P__=Paint

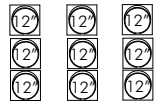

Note: Right hand shown, left hand opposite.
Includes steel nipples, iron ells, 12-circuit terminal block, and aluminum terminal compartment. Plastic door standard, aluminum door available.

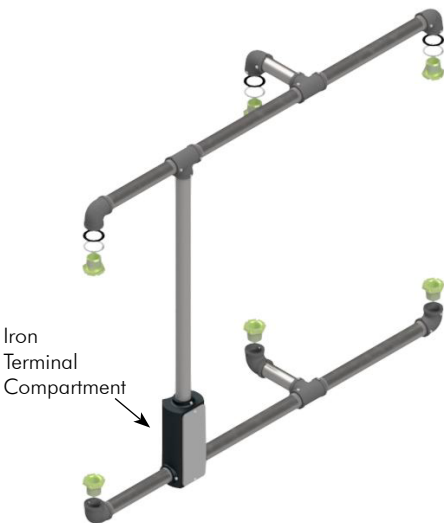

Terminal Compartment Assy, Side-of-Pole 2-Way 12" Signal, Iron

Caltrans SV-3-TB

SP-8333	-	<input type="checkbox"/>	-	<input type="checkbox"/>	-	<input type="checkbox"/>	-	<input type="checkbox"/>	-	<input type="checkbox"/>	-	<input type="checkbox"/>
		Mount		Signal Section		Orientation		Wiring		Door		Coating
		Blank=Std Dia Pole LDP=Lg Dia Pole (extended arm for larger pole dia)		3 =34" Tube		RH=Right Hand LH=Left Hand		Blank =None WH=Wiring Harness		Blank=Plastic AD=Aluminum		P__=Paint



Note: Right hand shown, left hand opposite.
Includes steel nipples, iron ells, 12-circuit terminal block, and iron terminal compartment. Plastic door standard, aluminum door available.

Note: 1. All assemblies supplied standard with stainless steel fasteners.
2. See Reference Section for available paint colors.



Terminal Compartments, SOP

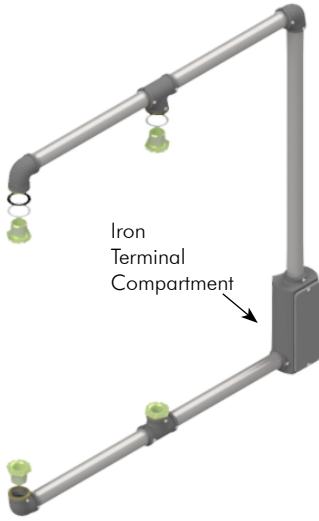

Terminal Compartment Assy, Side-of-Pole 2-Way 12" Signal, Iron

Caltrans SV-2-TC

	Signal Section	Orientation	Wiring	Door	Coating
SP-8364 -	<input type="text"/>	- <input type="text"/>	- <input type="text"/>	- <input type="text"/>	- <input type="text"/>
	1 = 7.25" Tube	RH = Right Hand	Blank = None	Blank = Plastic	P_ _ = Paint
	2 = 20.5" Tube	LH = Left Hand	WH = Wiring	AD = Aluminum	
	3 = 34" Tube		Harness		
	4 = 47.5" Tube				
	5 = 61" Tube				



Note: Left hand shown, right hand opposite.
Includes steel nipples, iron ells, 12-circuit terminal block, and iron terminal compartment. Plastic door standard, aluminum door available.

WEST COAST

pelco
PELCO PRODUCTS, INC.





Terminal Compartment Assy, Side-of-Pole 1-Way 12" Signal, 13" CTC, Bronze

Signal Section	Orientation	Wiring	Door	Coating
SP-8014 - <input type="checkbox"/>	- <input type="checkbox"/>	- <input type="checkbox"/>	- <input type="checkbox"/>	- <input type="checkbox"/>
1=7.25" Tube	RH=Right Hand	Blank =None	Blank=Plastic	P__=Paint
2=20.5" Tube	LH=Left Hand	WH=Wiring	AD=Aluminum	
3=34" Tube		Harness		
4=47.5" Tube				
5=61" Tube				

Note: Left hand shown, right hand opposite.
Includes steel nipples, iron ells, 12-circuit terminal block, and bronze terminal compartment. Plastic door standard, aluminum door available.

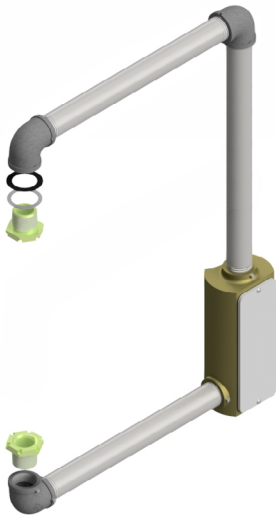

Terminal Compartment Assy, Side-of-Pole 1-Way 12" Signal, 22" CTC, Bronze

Signal Section	Orientation	Wiring	Door	Coating
SP-8036 - <input type="checkbox"/>	- <input type="checkbox"/>	- <input type="checkbox"/>	- <input type="checkbox"/>	- <input type="checkbox"/>
1=7.25" Tube	RH=Right Hand	Blank =None	Blank=Plastic	P__=Paint
2=20.5" Tube	LH=Left Hand	WH=Wiring	AD=Aluminum	
3=34" Tube		Harness		
4=47.5" Tube				
5=61" Tube				

Note: Left hand shown, right hand opposite.
Includes steel nipples, iron ells, 12-circuit terminal block, and bronze terminal compartment. Plastic door standard, aluminum door available.

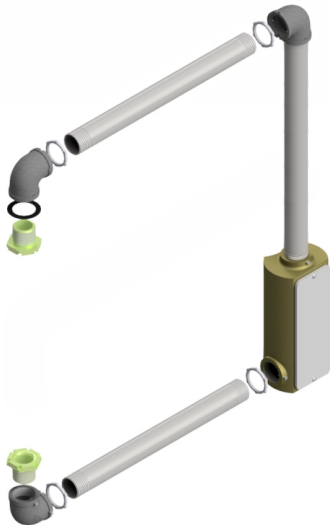

Terminal Compartment Assy, Side-of-Pole 1-Way 12" Signal w/ Locknuts, 22" CTC, Bronze

Signal Section	Orientation	Wiring	Door	Coating
SP-8038 - <input type="checkbox"/>	- <input type="checkbox"/>	- <input type="checkbox"/>	- <input type="checkbox"/>	- <input type="checkbox"/>
1=7.25" Tube	RH=Right Hand	Blank =None	Blank=Plastic	P__=Paint
2=20.5" Tube	LH=Left Hand	WH=Wiring	AD=Aluminum	
3=34" Tube		Harness		
4=47.5" Tube				
5=61" Tube				

Note: Left hand shown, right hand opposite.
Includes steel nipples, iron ells, conduit locknuts, 12-circuit terminal block, and bronze terminal compartment. Plastic door standard, aluminum door available.



Note: 1. All assemblies supplied standard with stainless steel fasteners.
2. See Reference Section for available paint colors.



Terminal Compartments, SOP

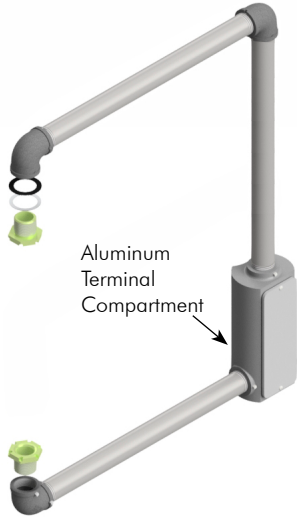

Terminal Compartment Assy, Side-of-Pole 1-Way 12" Signal, 27" CTC, Alum

	Signal Section	Orientation	Door	Coating
SP-8267 -	<input type="checkbox"/>	<input type="checkbox"/>	<input type="checkbox"/>	<input type="checkbox"/>
	1=7.25" Tube	RH=Right Hand	Blank=Plastic	P__=Paint
	2=20.5" Tube	LH=Left Hand	AD=Aluminum	
	3=34" Tube			
	4=47.5" Tube			
	5=61" Tube			



Note: Left hand shown, right hand opposite.
Includes steel nipples, iron ells, 12-circuit terminal block, and aluminum terminal compartment. Plastic door standard, aluminum door available.

WEST COAST

pelco
PELCO PRODUCTS, INC.

Note: 1. All assemblies supplied standard with stainless steel fasteners.
2. See Reference Section for available paint colors.



Terminal Compartments, SOP



Terminal Compartment Assy, Side-of-Pole 2-Way 12" Signal, 26" CTC, Bronze

Signal Section	Wiring	Door	Coating
SP-8015 - <input type="text"/>	- <input type="text"/>	- <input type="text"/>	- <input type="text"/>
1=7.25" Tube	Blank =None	Blank=Plastic	P_ _=Paint
2=20.5" Tube	WH=Wiring	AD=Aluminum	
3=34" Tube	Harness		
4=47.5" Tube			
5=61" Tube			

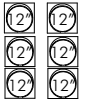

Note: Includes steel nipples, iron ells, 12-circuit terminal block, and bronze terminal compartment. Plastic door standard, aluminum door available.



Terminal Compartment Assy, Side-of-Pole 2-Way 12" Signal w/ Locknuts, 44" CTC, Bronze

Signal Section	Door	Coating
SP-8039 - <input type="text"/>	- <input type="text"/>	- <input type="text"/>
1=7.25" Tube	Blank=Plastic	P_ _=Paint
2=20.5" Tube	AD=Aluminum	
3=34" Tube		
4=47.5" Tube		
5=61" Tube		



Note: Includes steel nipples, iron ells, conduit locknuts, 12-circuit terminal block, and bronze terminal compartment. Plastic door standard, aluminum door available.

Note: 1. All assemblies supplied standard with stainless steel fasteners.
2. See Reference Section for available paint colors.



Terminal Compartments, SOP



Terminal Compartment Assy, Side-of-Pole 2-Way 12" Signal, Unbalanced, Bronze

SP-8035 -	Signal Section	-	Wiring	-	Door	-	Coating
	<input type="text"/>	-	<input type="text"/>	-	<input type="text"/>	-	<input type="text"/>
	3-2=34" Tube		Blank =None		Blank=Plastic		P_=_=Paint
	4-2=47.5" Tube		WH=Wiring		AD=Aluminum		
	4-3=47.5" Tube		Harness				
	5-3=60" Tube						
	5-4=60" Tube						



Note:

Wiring harness wires are not pulled through the lower arms, but instead are bundled and coiled in the terminal compartment.
Includes steel nipples, iron ells, 12-circuit terminal block, and bronze terminal compartment. Plastic door standard, aluminum door available.



Terminal Compartment Assy, Side-of-Pole 2-Way 12" Signal w/ Locknuts, Unbalanced, Bronze

SP-8040 -	Signal Section	-	Wiring	-	Door	-	Coating
	<input type="text"/>	-	<input type="text"/>	-	<input type="text"/>	-	<input type="text"/>
	3-2=34" Tube		Blank =None		Blank=Plastic		P_=_=Paint
	4-2=47.5" Tube		WH=Wiring		AD=Aluminum		
	4-3=47.5" Tube		Harness				
	5-3=60" Tube						
	5-4=60" Tube						

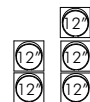

Note:

Wiring harness wires are not pulled through the lower arms, but instead are bundled and coiled in the terminal compartment.
Includes steel nipples, iron ells, conduit locknuts, 12-circuit terminal block, and bronze terminal compartment. Plastic door standard, aluminum door available.

Note: 1. All assemblies supplied standard with stainless steel fasteners.
2. See Reference Section for available paint colors.



Terminal Compartments, SOP

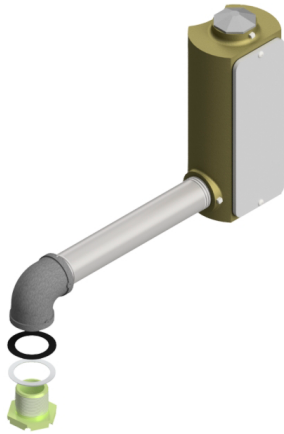

Terminal Compartment Assy, Side-of-Pole 1-Way Pedestrian Signal, 15" CTC, Bronze

SP-8019 - - - -

Orientation	Wiring	Door	Coating
RH=Right Hand LH=Left Hand	Blank =None WH=Wiring Harness	Blank=Plastic AD=Aluminum	P__=Paint



Note: Left hand shown, right hand opposite.
Includes steel nipples, iron ells, 12-circuit terminal block, and bronze terminal compartment. Plastic door standard, aluminum door available.

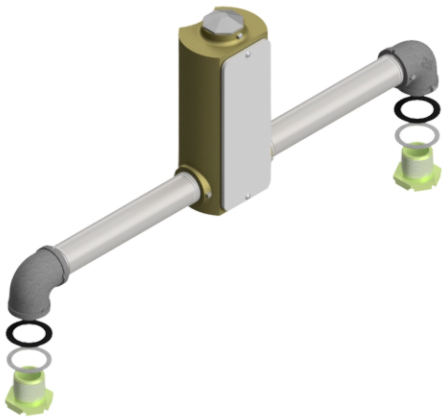

Terminal Compartment Assy, Side-of-Pole 2-Way Pedestrian Signal, 30" CTC, Bronze

SP-8020 - - -

Wiring	Door	Coating
Blank =None WH=Wiring Harness	Blank=Plastic AD=Aluminum	P__=Paint



Note: Includes steel nipples, iron ells, 12-circuit terminal block, and bronze terminal compartment. Plastic door standard, aluminum door available.

Note: 1. All assemblies supplied standard with stainless steel fasteners.
2. See Reference Section for available paint colors.

This page is intentionally left blank.

WEST COAST

pelco
PELCO PRODUCTS, INC.



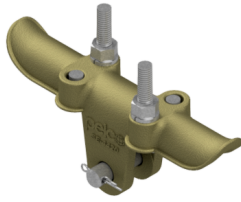

**Span Wire Clamp, Bronze
w/ Stainless Steel J-Bolts, 3/4" Wide Slot**

SE-3323-PNC



**Wire Outlet Body w/Grommet, Bronze
1-1/2" NPS, 3/4" Wide Comb**

SE-4421- Coating
PNC=Process No Color
P_ =Paint

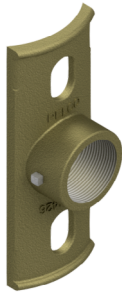

**Hub Plate w/o Cable Guide, Bronze
1-1/2" NPS**

SE-4426- Coating
PNC=Process No Color
P_ =Paint



**Hub Plate w/ Cable Guide, Bronze
1-1/2" NPS**

SE-4427- Coating
PNC=Process No Color
P_ =Paint

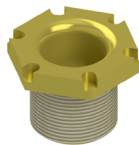

**Hex Nipple, 1-1/2" NPS x 1-1/2" Long,
Steel, Zinc 2**

SE-0435-ZN2

Note: 1. All assemblies supplied standard with stainless steel fasteners.
 2. See Reference Section for available paint colors.



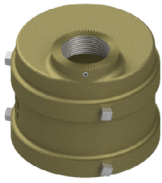

**Slip Fitter Assy, Offset, Bronze
1-Way for 4-1/2" OD Pole, Serrated Top Port**

SE-4425-

Coating
PNC=Process No Color
P__=Paint

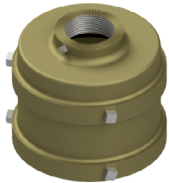

**Slip Fitter Assy, Bronze
1-Way for 4-1/2" OD Pole, Serrated Top Port**

SE-4424-

Coating
PNC=Process No Color
P__=Paint



**Slip Fitter Assy, Bronze
1 & 2-Way for 4-1/2" OD Pole, Serrated Top Port**

SE-4423-

Coating
PNC=Process No Color
P__=Paint

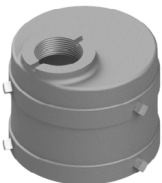

**Slip Fitter Assy, Offset, Aluminum
1-Way for 4-1/2" OD Pole, Notched Top Port**

SE-3107-

Coating
PNC=Process No Color
P__=Paint



**Slip Fitter Assy, Aluminum
1-Way for 4-1/2" OD Pole, Notched Top Port**

SE-3106-

Coating
PNC=Process No Color
P__=Paint



**Slip Fitter Assy, Iron
1 & 2-Way for 4-1/2" OD Pole, Notched Top Port**

SE-4431-

Coating
GLV=Galvanize
P__=Paint

Note: 1. All assemblies supplied standard with stainless steel fasteners.
2. See Reference Section for available paint colors.





Offset Plumbizer Assy for 2-3/8" OD Tenon, Bronze w/ Hardware

SE-4413- Coating
PNC=Process No Color
P__=Paint

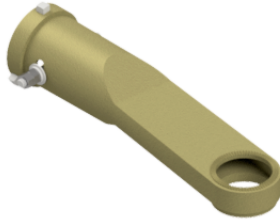

Offset Plumbizer Assy for 2-3/8" OD Tenon, Bronze Large Hole w/ Hardware

SE-4243 - Coating
PNC=Process No Color
P__=Paint



Offset Plumbizer Assy for 2-3/8" OD Tenon, Iron Large Hole w/ Hardware

SE-3335 - Coating
GLV=Galvanized
P__=Paint

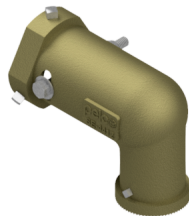

Ell Assy, Rigid for 2-3/8" OD Tenon, Bronze 1-1/2" NPS w/ Hardware

SE-4412- Coating
PNC=Process No Color
P__=Paint

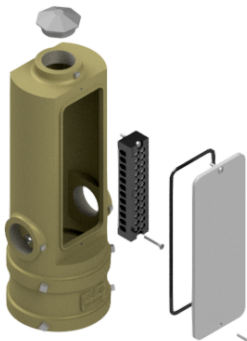

Terminal Compartment Assy, Bronze 2-Way Post Top for 4-1/2" OD Pole, w/ 10-Circuit Terminal Block

SE-4422 - - Door Coating
Blank=Plastic PNC=Process No Color
AD=Aluminum P__=Paint

Note: Plastic door standard, aluminum door available.

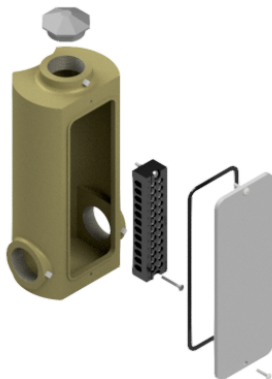

Terminal Compartment Assy, Bronze 2-Way Side-of-Pole for 4-1/2" OD Pole, w/ 10-Circuit Terminal Block

SE-4418 - - Door Coating
Blank=Plastic PNC=Process No Color
AD=Aluminum P__=Paint

Note: Plastic door standard, aluminum door available.

Note: 1. All assemblies supplied standard with stainless steel fasteners.
 2. See Reference Section for available paint colors.





Door, Terminal Compartment

Plastic	SE-0485 -	Coating <input type="text"/>
		PNC=Process No Color P__=Paint
Aluminum	SE-0605 -	Coating <input type="text"/>
		PNC=Process No Color P__=Paint

Octagonal Closure Cap, Alum

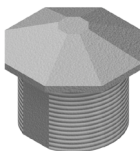

1-1/2" NPS x 1/2"	SE-4088-	Coating <input type="text"/>
		PNC=Process No Color P__=Paint
1-1/2" NPS x 7/8"	SE-0361-	Coating <input type="text"/>
		PNC=Process No Color P__=Paint
1-1/2" NPS x 1-3/8"	SE-0483-	Coating <input type="text"/>
		PNC=Process No Color P__=Paint
1-1/2" NPS x 2"	SE-0442-	Coating <input type="text"/>
		PNC=Process No Color P__=Paint

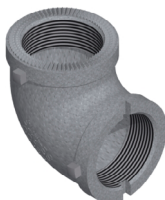

Serrated Ell, 1-1/2" NPS w/ Set Screws Iron

SE-4415-	Coating <input type="text"/>
	GLV=Galvanized P__=Paint

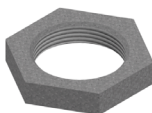

Hex Nut, 1-1/2" NPS, Iron, Zinc 1

SE-4017-1-ZN1

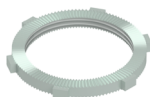

Conduit Locknut, Serrated, 1-1/2" NPS, Zinc

SE-4125-PNC



Lockring, Serrated, Brass

SE-4029-BRS

Note: 1. All assemblies supplied standard with stainless steel fasteners.
2. See Reference Section for available paint colors.

