



# Vacuum Formed ABS

Vacuum formed backplates are fabricated from black ABS UV stabilized plastic sheet with hair cell finish on front side, smooth finish on back side, 5/8" flange on all sides, and 3" corner radii. Each are designed to precisely fit manufacturers signal head and are supplied with necessary hardware.



## BK-1000 Series Combination Backplates, Vacuum Formed ABS Plastic, .125"

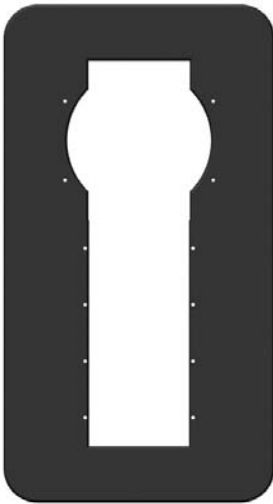

BK-1011-SERIES  
12"-8"-8", 3 Section  
EXAMPLE

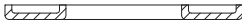

BK-  -  - PNC

1000 Series      Signal  
                                 Manufacturer

Note:  
See Charts Below to specify part number, ie., BK-1011-A-PNC

COMBINATION BACKPLATES		
SIGNAL SIZE	No. of SECTIONS	1000 Series VACUUM FORMED .125" ABS
12"-8"-8"	3	BK-1011
12"-12"-8"-8"-8"	5	BK-1014

SIGNAL MANUFACTURER	
Eagle Sig/Automatic (poly) .....	A
Eagle SA (poly) .....	E
Eagle/Mark IV (alum) .....	F
TCT .....	C
McCain .....	N
Fortran .....	FT
Econolite 2002 (poly) .....	L3
Econolite 2002 (alum) .....	L4
Walker Brothers .....	WB

BACKPLATES



Note: 1. All Signal Manufacturers may not be available.

# Vacuum Formed ABS

Vacuum formed backplates are fabricated from black ABS UV stabilized plastic sheet with hair cell finish on front side, smooth finish on back side, 5/8" flange on all sides, and 3" corner radii. Each are designed to precisely fit manufacturers signal head and are supplied with necessary hardware.

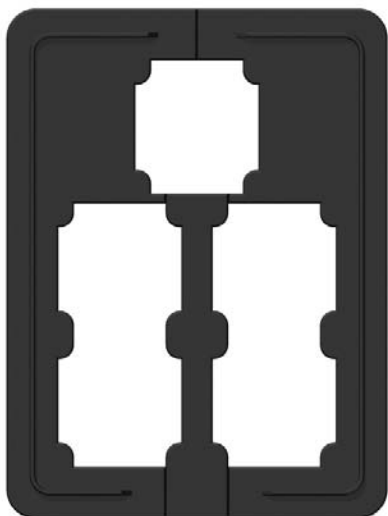

BK-1007-SERIES  
5 Section  
EXAMPLE

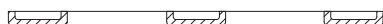

## BK-1000 Series Cluster Backplates, Vacuum Formed ABS Plastic, .125"

BK-  -  - PNC

Note:  
See Charts Below to specify part number, ie., BK-1007-A-PNC

CLUSTER BACKPLATES			
SIGNAL SIZE	No. of SECTIONS	1000 Series VACUUM FORMED .125" ABS	MOUNTING APPLICATION
$\frac{12''}{12'' 12''}$ $\frac{12''}{12'' 12''}$	5	BK-1007	AB-0109 Astro-Brac 16" CTC
$\frac{12''}{12'' 12''}$ $\frac{12''}{12'' 12''}$	5	BK-1010	Span Wire 16-1/2" CTC
$\frac{12''}{12'' 12''}$ $\frac{12''}{12'' 12''}$	5	BK-1021	Span Wire Casting 17" CTC
$\frac{12''}{12'' 12''}$ $\frac{12''}{12'' 12''}$	5	BK-1015	Plumbizer Mount 17" CTC
$\frac{12''}{12'' 12''}$ $\frac{12''}{12'' 12''}$	3	BK-1032	AB-1067 or AB-0168 Astro-Brac 17" CTC

SIGNAL MANUFACTURER	
Eagle Sig/Automatic (poly) .....	A
Eagle SA (poly) .....	E
Eagle/Mark IV (alum) .....	F
TCT .....	C
McCain .....	N
Fortran .....	FT
Econolite 2002 (poly) .....	L3
Econolite 2002 (alum) .....	L4
Walker Brothers .....	WB

Note: 1. All Signal Manufacturers may not be available.

# Louvered Vacuum Formed ABS

Louvered backplates improve traffic signal visibility while reducing the wind load. Vacuum formed backplates are fabricated from black ABS UV stabilized plastic sheet with hair cell finish on front side, smooth finish on back side, 5/8" flange on all sides, and 3" corner radii. Each are designed to precisely fit manufacturers' signal head and are supplied with necessary hardware.



## BK-5000 Series Louvered Straight Backplates, Vacuum Formed ABS Plastic, .125"

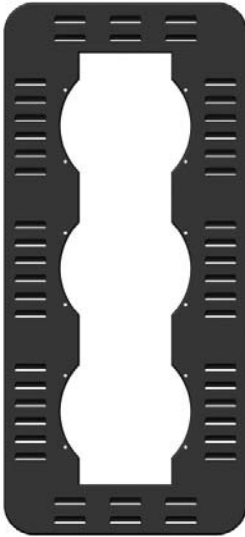

BK-5003-SERIES  
12", 3 Section  
EXAMPLE

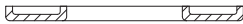

BK-  -  - PNC

5000 Series      Signal  
                                 Manufacturer

Note:  
See Charts Below to specify part number, ie., BK-5003-A-PNC

STRAIGHT BACKPLATES		
SIGNAL SIZE	No. of SECTIONS	5000 Series VACUUM FORMED .125" ABS
12"	3	BK-5003
12"	4	BK-5004
12"	5	BK-5005

SIGNAL MANUFACTURER	
Eagle Sig/Automatic (poly) .....	A
Eagle SA (poly) .....	E
Eagle/Mark IV (alum) .....	F
TCT .....	C
McCain .....	N
Fortran .....	FT
Econolite 2002 (poly) .....	L3
Econolite 2002 (alum) .....	L4
Walker Brothers .....	WB

BACKPLATES



Note: 1. All Signal Manufacturers may not be available.

# Louvered Vacuum Formed ABS

Louvered backplates improve traffic signal visibility while reducing the wind load. Vacuum formed backplates are fabricated from black ABS UV stabilized plastic sheet with hair cell finish on front side, smooth finish on back side, 5/8" flange on all sides, and 3" corner radii. Each are designed to precisely fit manufacturers' signal head and are supplied with necessary hardware.

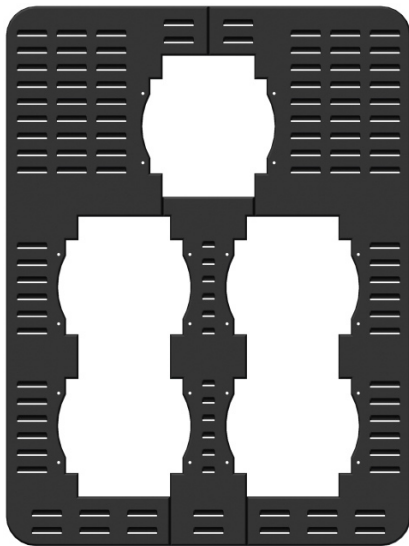

BK-5021-SERIES  
5 Section  
EXAMPLE

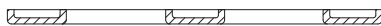

## BK-5000 Series Louvered 5-Section Cluster Backplates, Vacuum Formed ABS Plastic, .125"

BK-  -  - PNC

Note:  
See Charts Below to specify part number, ie., BK-5021-A-PNC

5-SECTION CLUSTER BACKPLATES			
SIGNAL SIZE	No. of SECTIONS	5000 Series VACUUM FORMED .125" ABS	MOUNTING APPLICATION
$\frac{12''}{12'' \times 12''}$	5	BK-5007	AB-0109 Astro-Brac 16" CTC
$\frac{12''}{12'' \times 12''}$	5	BK-5010	Span Wire 16-1/2" CTC
$\frac{12''}{12'' \times 12''}$	5	BK-5021	Span Wire Casting 17" CTC

SIGNAL MANUFACTURER
Eagle Sig/Automatic (poly) ..... A
Eagle SA (poly) ..... E
Eagle/Mark IV (alum) ..... F
TCT ..... C
McCain ..... N
Fortran ..... FT
Econolite 2002 (poly) ..... L3
Econolite 2002 (alum) ..... L4
Walker Brothers ..... WB

Note: 1. All Signal Manufacturers may not be available.

# Split Backplates

Split backplates allow for easy installation without removing the signal from its mounting bracketry. Backplates are fabricated from black ABS UV stabilized plastic sheet with hair cell finish on front side, smooth finish on back side, 5/8" flange on all sides, and 3" corner radii. Each are designed to precisely fit manufacturer's signal head and are supplied with necessary hardware.

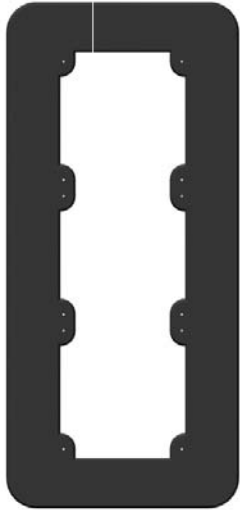

BK-4003-SERIES  
12", 3 Section  
EXAMPLE

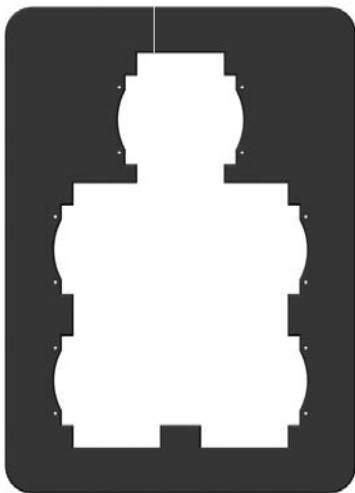
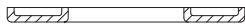

BK-4009-SERIES  
5 Section  
EXAMPLE

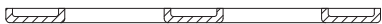

## BK-4000 Series Vaccum Formed, .125"

BK-  -  - PNC

4000 Series      Signal  
                                 Manufacturer

Note:

1. See Charts Below to specify part number, ie., BK-4003-A-PNC
2. Additional Charge to split backplate.
3. Hardware included.

SPLIT BACKPLATES		
SIGNAL SIZE	No. of SECTIONS	4000 Series VACUUM FORMED .125" ABS
12"	1	BK-4001
12"	3	BK-4003
12"	4	BK-4004
12"	5	BK-4005
8"	3	BK-4006
12"	3	BK-4503 Louvered
12"	4	BK-4504 Louvered
12"	5	BK-4505 Louvered
12"	5	BK-4009
12"   12"		
12"   12"		

SIGNAL MANUFACTURER	
Eagle Sig/Automatic (poly) .....	A
Eagle SA (poly) .....	E
Eagle/Mark IV (alum) .....	F
TCT .....	C
McCain .....	N
Fortran .....	FT
Econolite 2002 (poly) .....	L3
Econolite 2002 (alum) .....	L4
Walker Brothers .....	WB

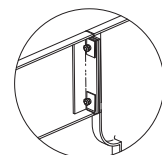

Backplate Split

Note: 1. All Signal Manufacturers may not be available.

## Flat ABS

Flat backplates are fabricated from black ABS UV stabilized plastic sheet with hair cell finish on front side, smooth finish on back side, and 3" corner radii. Each are designed to precisely fit manufacturers signal head and are supplied with necessary hardware.

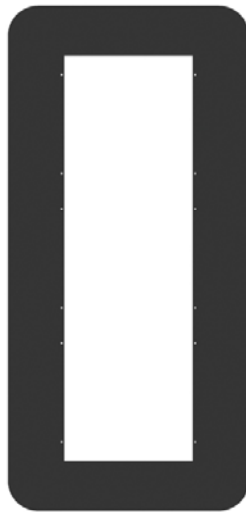

BK-2008-SERIES  
12", 3 Section  
EXAMPLE

### BK-2000 Series Straight Backplates, Flat ABS Plastic, .156"

BK-  -  - PNC

Note:  
See Charts Below to specify part number, ie., BK-2008-A-PNC

STRAIGHT BACKPLATES		
SIGNAL SIZE	No. of SECTIONS	2000 Series FLAT .156" ABS
8"	1	BK-2001
8"	2	BK-2002
8"	3	BK-2003
8"	4	BK-2004
8"	5	BK-2005
12"	1	BK-2006
12"	2	BK-2007
12"	3	BK-2008
12"	4	BK-2009
12"	5	BK-2010

SIGNAL MANUFACTURER	
Eagle Sig/Automatic (poly) .....	A
Eagle SA (poly) .....	E
Eagle/Mark IV (alum) .....	F
TCT .....	C
McCain .....	N
Fortran .....	FT
Econolite 2002 (poly) .....	L3
Econolite 2002 (alum) .....	L4
Walker Brothers .....	WB

Note: 1. Flat polycarbonate backplates are available upon request. Contact Pelco for backplate options not shown.  
2. All Signal Manufacturers may not be available.



# Flat ABS

Flat backplates are fabricated from black ABS UV stabilized plastic sheet with hair cell finish on front side, smooth finish on back side, and 3" corner radii. Each are designed to precisely fit manufacturers signal head and are supplied with necessary hardware.



## BK-2000 Series Cluster Backplates, Flat ABS Plastic, .156"

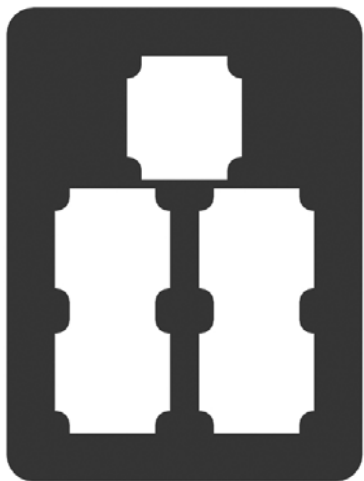

BK-2011-SERIES  
5 Section  
EXAMPLE



BK-2032-SERIES  
12", 3 Section  
EXAMPLE

BK-  -  - PNC

Note:  
See Charts Below to specify part number, ie., BK-2011-A-PNC

5-SECTION CLUSTER BACKPLATES			
SIGNAL SIZE	No. of SECTIONS	2000 Series FLAT .156" ABS	MOUNTING APPLICATION
$\frac{12''}{12''}   \frac{12''}{12''}$	5	BK-2011	AB-0109 Astro-Brac 16" CTC
$\frac{12''}{12''}   \frac{12''}{12''}$	5	BK-2023	Span Wire 16-1/2" CTC
$\frac{12''}{12''}   \frac{12''}{12''}$	5	BK-2024	Span Wire Casting 17" CTC
$\frac{12''}{12''}   \frac{12''}{12''}$	3	BK-2032	Plumbizer Casting 17" CTC

SIGNAL MANUFACTURER	
Eagle Sig/Automatic (poly) .....	A
Eagle SA (poly) .....	E
Eagle/Mark IV (alum) .....	F
TCT .....	C
McCain .....	N
Fortran .....	FT
Econolite 2002 (poly) .....	L3
Econolite 2002 (alum) .....	L4
Walker Brothers .....	WB

Note: 1. Flat polycarbonate backplates are available upon request. Contact Pelco for backplate options not shown.  
2. All Signal Manufacturers may not be available.

## BK-0101-SS **Hardware Kit, Backplate, Stainless**

Note: 1. Hardware Kit includes: 12 Nuts, 24 Washers, 12 Screws  
 2. Hardware Kits are used with A, F, C, L3 backplates.  
 See Chart below.

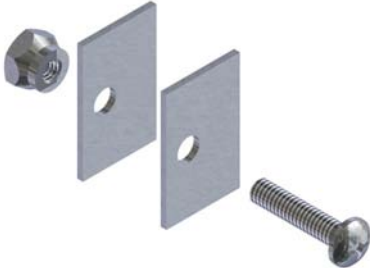

## BK-0113-SS **Hardware Kit, Backplate**

Note: 1. Hardware Kit includes: 2 Nuts, 4 Washers  
 2. Hardware Kits are used with A, E, C, N, L4 backplates.  
 See Chart below.

## BK-0117-PNC **Hardware Kit, Backplate**

Note: 1. Hardware Kit includes: 24 Washers, 12 Nuts, 12 Screws  
 2. Hardware Kits are used with L4 backplates.  
 See Chart below.

## BK-0108-SS **Hardware Kit, Backplate, Stainless**

Note: 1. Hardware Kit includes: 12 Washers, 12 Screws  
 2. Hardware Kits are used with E backplates.  
 See Chart below.

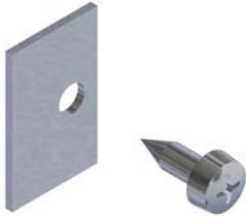

## BK-0110-SS **Hardware Kit, Backplate, Stainless**

Note: 1. Hardware Kit includes: 12 Washers, 12 Screws  
 2. Hardware Kits are used with F, N, FT backplates.  
 See Chart below.



## BK-0106-PNC **Hardware Kit, Backplate**

Note: 1. Hardware Kit includes: 1 Screw, 1 Nut  
 2. Hardware Kits are used with A, E, F, C, N, L3, L4 backplates.  
 See Chart below.

### SIGNAL MANUFACTURER

Eagle Sig/Automatic (poly) .....	A
Eagle SA (poly) .....	E
Eagle/Mark IV (alum) .....	F
TCT .....	C
McCain .....	N
Fortran .....	FT
Econolite 2002 (poly) .....	L3
Econolite 2002 (alum) .....	L4
Walker Brothers .....	WB