



**AP-1025**  
25' Spun Alum  
Flag Pole Assembly



**AP-0802**  
Alum Flag Pole Base  
for 8" to 12" Dia Pole

Showing your spirit for your country, state, or school has never been easier. Pelco manufactures a complete line of flagpoles and accessories. 25' Spun aluminum flagpoles are designed to fit proportionally in residential applications. Commercial applications call for a commercial flagpole built to handle the rigors of everyday use. Pelco's 30' and 40' flagpoles feature a locking internal storage and retrieval system to detour theft and vandalism. Add a decorative aluminum base to new or existing flagpoles to draw the attention your flagpole deserves.

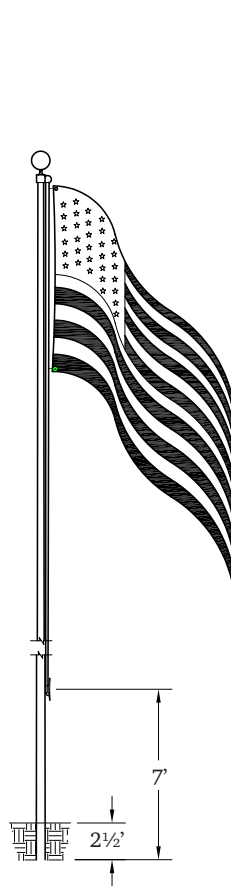

**AP-1025**  
25' Spun Alum  
Flag Pole Assembly



**AP-1033**  
30' Alum Flag Pole  
w/ Flag Storage & Retrieval System\*

**AP-1026**  
40' Galv Flag Pole  
w/ Flag Storage & Retrieval System\*

\*Flag Stored inside of Pole



**AP-1033**  
30' Alum Flag Pole  
w/ Flag Storage &  
Retrieval System

**AP-1026**  
40' Galv Flag Pole  
w/ Flag Storage &  
Retrieval System

①



ITEM	DESCRIPTION	PART NO.
------	-------------	----------

①	USA FLAGS, Nylon w/ Sewn Stars & Stripes	
	2½' x 4' .....	AP-0706
	3' x 5' .....	AP-0199
	4' x 6' .....	AP-0182
	5' x 8' .....	AP-0136
	6' x 10' .....	AP-0177
	8' x 12' .....	AP-0137

**ORNAMENTAL BASES:**

②	Old Towne I, 2-7/8" to 3½" Dia Pole, Alum.....	AP-0801
	Old Towne I, 3½" Max Dia Pole, ABS Plastic .....	AP-0804
③	4 Piece, 8" to 12" Dia Pole, Alum.....	AP-0802
④	Hamilton Series, 4-1/16" to 8½" Dia Pole, Alum .....	AP-0816
⑤	GROUND SLEEVE w/ Setscrews,	
	3" SCH 40 Pipe x 30" .....	PB-5210-30
⑥	ANCHOR BOLTS (Set of 4), 1"-8NC x 36" .....	AP-1007
⑦	HALYARD KITS:	
	for 25' Pole .....	AP-0570
	for 30' Pole .....	AP-0571
	for 40' Pole .....	AP-0572

②

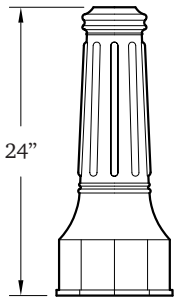

Available for  
25' Spun Alum Pole

ITEM 2 OPTIONS
TOP OF BASE ID: 2-7/8" Min - 3½" Max Dia
BOTTOM OF BASE ID: 7½" Max Dia
PAINT (Alum Base Only)

③

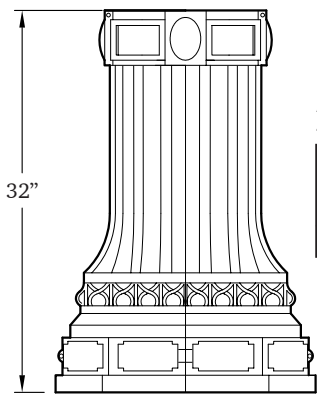

Available for 30' Alum or  
40' Galv Flag Pole

ITEM 3 OPTIONS
POLE SIZES: 6"-8" or 8"-12"
PAINT

④

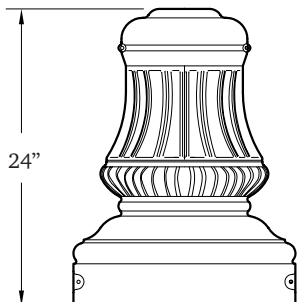

Available for 30' Alum or  
40' Galv Flag Pole

ITEM 4 OPTIONS
TOP OF BASE ID: 4-1/16" Min - 8½" Max Dia
PAINT

⑥

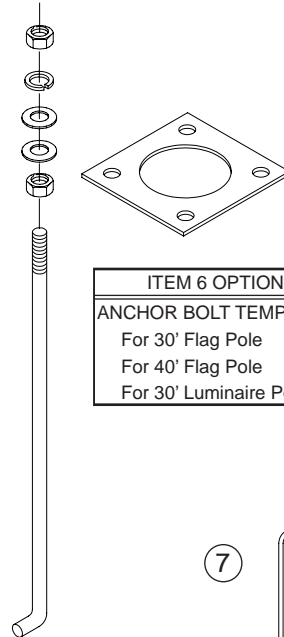

ITEM 6 OPTIONS
ANCHOR BOLT TEMPLATE: For 30' Flag Pole For 40' Flag Pole For 30' Luminaire Pole

⑤

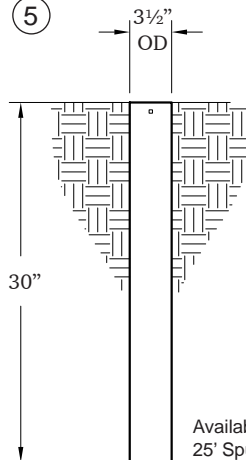

Available for  
25' Spun Alum Pole

⑦

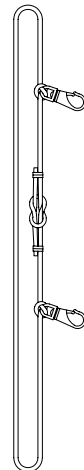



ITEM	DESCRIPTION	PART NO.
FLAG MOUNTING BRACKET, for 1" Flag Pole		
①	Serrated Articulating W/ Ornamental Hub.....	SH-3540
②	Serrated Articulating W/ Astro Mini-Brac .....	SH-3539
③	Universal Serrated Articulating .....	SH-3538
④	Serrated Articulating .....	SH-3537
⑤	ORNAMENTAL PLANT HANGER ASSEMBLY	
	Rated for maximum load of 75 lbs .....	AP-7255

Notes:

1. All assemblies are supplied standard with stainless fasteners.  
Stainless upgrade to include stainless steel clamp screw.
2. Please specify options when ordering.

①

OPTIONS
POLE SIZE: 2½", 3", 4", 5", or 3" Fluted or 4" Fluted
PAINT

②

OPTIONS
BAND LENGTH: 29", or 42"
PAINT

③

④

ITEM 3-4 OPTIONS
PAINT

⑤

OPTIONS
POLE SIZE: 2½", 3", 4", 5", or 3" Fluted or 4"
ROD LENGTH: 18" or 24"
FINIAL: 2" Ball, Spire, Steeple, Fleur or Spear (gold or color of assembly)
CORNER IVY BRACKET: None, Horizontal, or Vertical
PAINT



Ornamental Plant Hanger



Finial Options

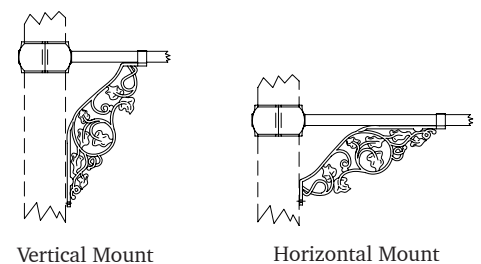

Corner Ivy Options



Pelco's banner brackets are the best in the industry. They offer property owners and municipalities an attractive eye catching way to promote local events and organizations. No more unsightly hose clamps to hold banners to sign and light poles. Pelco's entire line of banner brackets can be powder coated to match existing poles and will be machined for a custom fit. A banner arm finial securely holds your banner no matter the weather condition.

ITEM	DESCRIPTION	PART NO.
	BANNER BRACKET, w/ 1" Dia. Rod & 2" Dia. Ball	
①	Ornamental Serrated Articulating .....	SH-3530
②	Ornamental Banner Hub .....	SH-3521
③	Double Ornamental Banner Hub .....	SH-3535
④	SERRATED ARTICULATING SUB-ASSEMBLY Aluminum, 1½" NPS x 1"-8NC .....	SH-3518
⑤	BREAK-A-WAY COUPLER 1"-8NC For Banner Brackets (for 2'x4' Banner designed to break-a-way at 80 mph wind load) .....	AP-7239

Notes:

1. All assemblies are supplied standard with stainless fasteners. Stainless upgrade to include stainless steel clamp screw.
2. 2 brackets are required to mount each banner.
3. Please specify options when ordering.

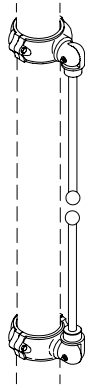

Storage Position

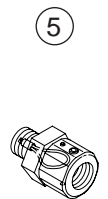
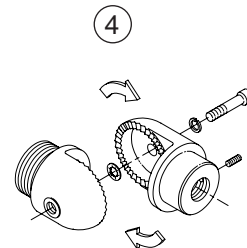
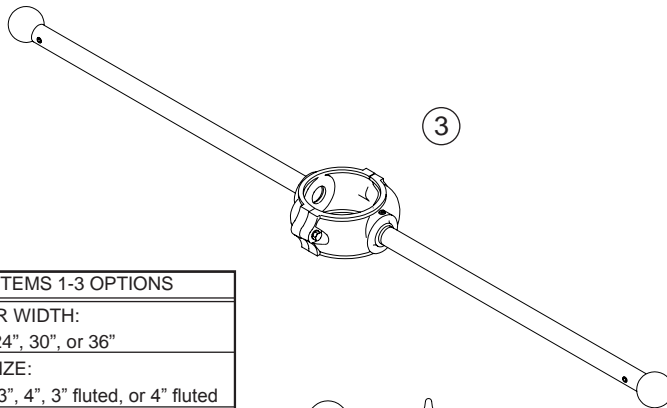
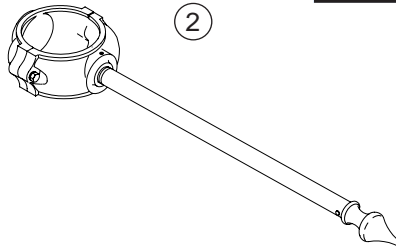
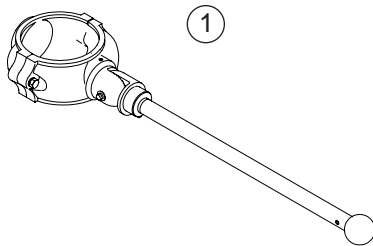

ITEMS 1-3 OPTIONS
BANNER WIDTH: 18", 24", 30", or 36"
POLE SIZE: 2½", 3", 4", 3" fluted, or 4" fluted
FINIAL: Ball or Spear
PAINT Finial - gold or assy color



ITEMS 4-5 OPTIONS
PAINT



ITEM	DESCRIPTION	PART NO.
	BANNER BRACKET, w/ 1" Dia. Rod & 2" Dia. Ball	
①	W/ Astro Mini-Brac .....	SH-3520
②	Ornamental Serrated Articulating w/ Astro Mini-Brac.....	SH-3525
③	Ornamental Serrated Articulating for Square Pole.....	SH-3532
④	W/ Universal Banner Hub .....	SH-3523

**Notes:**

1. All assemblies are supplied standard with stainless fasteners.  
Stainless upgrade to include stainless steel clamp screw.
2. 2 brackets are required to mount each banner.
3. Please specify options when ordering.

For larger or tapered poles try Pelco's Band-On banner brackets. Equipped with a stainless steel band that receives a special Pel-Coat treatment allowing bands to match the bracket and poles. No longer will shiny silver hose clamps detract from your promotional banners. Pel-Coat is a tough, durable treatment that will not crack or peel like painted or powder coated banding. A banner arm finial securely holds your banner no matter the weather condition

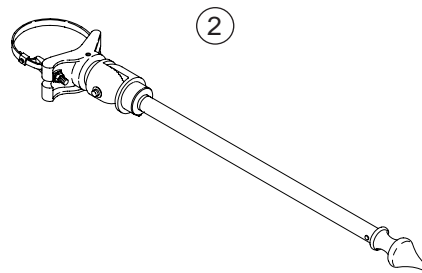
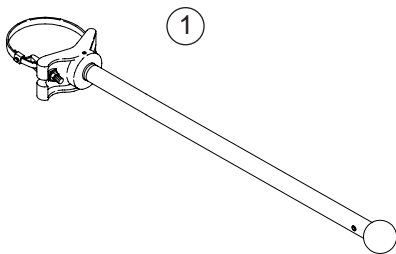

ITEMS 1-2 OPTIONS
BANNER WIDTH: 18", 24", 30", or 36"
BAND LENGTH: 29" or 42"
STAINLESS UPGRADE
FINIAL: Ball or Spear
PAINT: Finial - gold or assy color

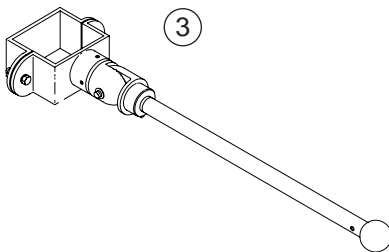

ITEMS 3 OPTIONS
BANNER WIDTH: 18", 24", 30", or 36"
SQUARE POLE SIZE: 4", 5", or 6-5/8"
FINIAL: Ball or Spear
PAINT: Finial - gold or assy color

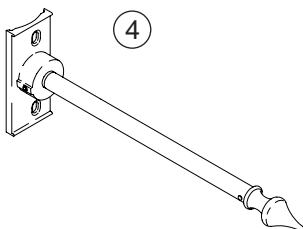

ITEMS 4 OPTIONS
BANNER WIDTH: 18", 24", 30", or 36"
FINIAL: Ball or Spear
PAINT: Finial - gold or assy color

